

## Warehouse Space For Lease In Boulder

**5565 ARAPAHOE AVE | BOULDER, CO 80303 SUITE E**

Size: 3,279 SF  
Price: \$12.50 NNN (\$6.56)  
Available Now

# WIDE OPEN WAREHOUSE

Get your business all the square feet it needs in this large-and-incharge warehouse space. Built out with 2 offices in the front and the rest open warehouse, this space is exactly what you have been looking for. The overhead door lets in light and fresh air making it an epic fit. Plus, the large amount of on-site parking makes it everything you have been dreaming of.

### PROPERTY HIGHLIGHTS

- Private restroom and office
- Easy onsite parking
- Central Boulder location
- High ceilings and large overhead door



[CLICK HERE](#)  
for virtual tour



LEARN MORE ABOUT THIS PROPERTY  
[MarketBoulder.com](https://MarketBoulder.com)





# market

REAL ESTATE

DISCLAIMER: The information contained herein has been obtained from sources believed reliable. While we do not doubt its accuracy, we have not verified it and make no guarantee, warranty or representation about it. It is your responsibility to independently confirm its accuracy and completeness.

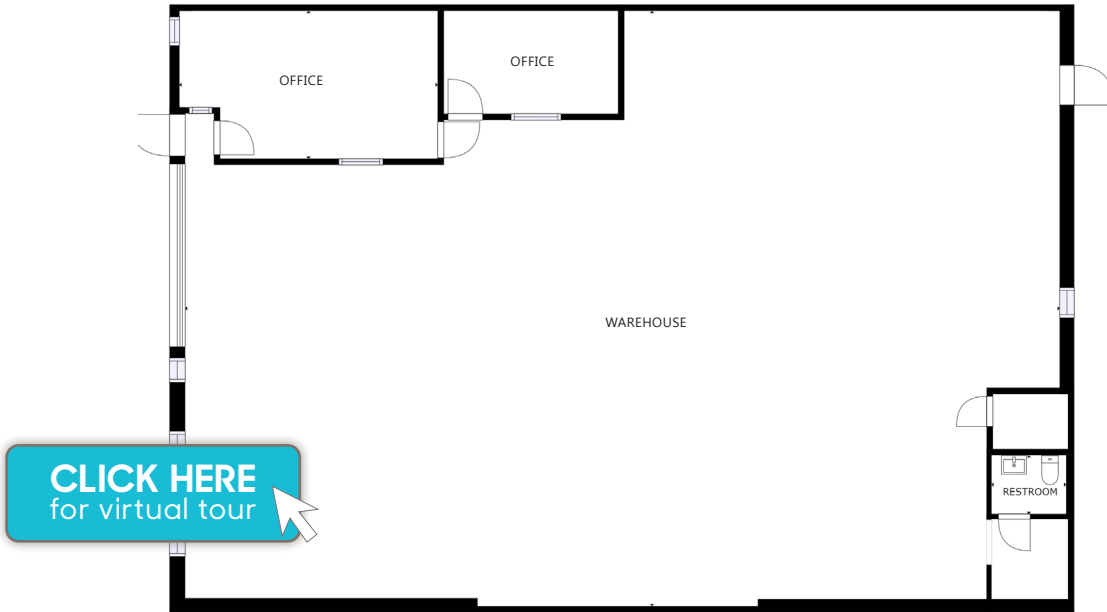

FLOOR 1



LEARN MORE ABOUT THIS PROPERTY  
[MarketBoulder.com](http://MarketBoulder.com)

**NATE LITSEY**  
303 444 4024 Nate@MarketBoulder.com

