

**COBBLESTONE SHOPPING CENTER**  
**10 - 190 HARTNELL AVE**  
**REDDING CA**

**FOR LEASE**

**861 SF - 6,489 SF SF AVAILABLE**

**ETHAN CONRAD**  
PROPERTIES INC.

**MAJOR REMODEL COMPLETE**

FOR MORE INFORMATION CONTACT:

**Race Merritt**

DRE: #01700659

race@ethanconradprop.com

**Jose Paredes-Mora**

DRE: #02068308

jose@ethanconradprop.com

**916.779.1000**

ETHAN CONRAD PROPERTIES, INC.

1300 NATIONAL DRIVE, SUITE 100 | SACRAMENTO CA, 95834 | FAX: 916.779.1200

www.ethanconradprop.com



**SPACES AVAILABLE:**

28:	2,170 SF	\$1.09 PSF, NNN
60:	2,786 SF	\$1.19 PSF, NNN
64:	1,420 SF	\$1.25 PSF, NNN
68:	2,238 SF	\$1.49 PSF, NNN
76:	2,138 SF	\$1.09 PSF, NNN
80:	1,266 SF	\$1.09 PSF, NNN
88:	2,324 SF	\$1.19 PSF, NNN
128:	861 SF	\$1.39 PSF, NNN
136:	1,091 SF	\$1.19 PSF, NNN
144:	1,910 SF	\$0.99 PSF, NNN
160:	2,780 SF	\$0.99 PSF, NNN

NNN costs are approximately \$0.38 PSF.

\*Divisible to 1,346 SF at \$1.39 PSF, NNN

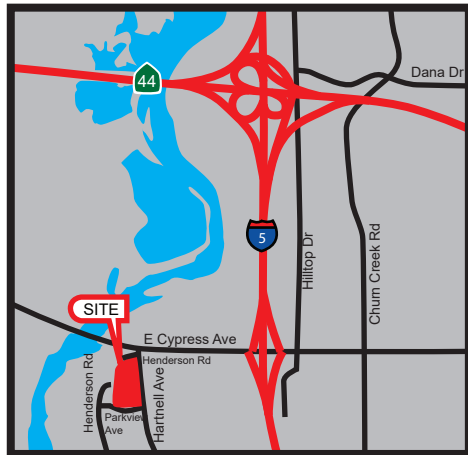
**PROPERTY DETAILS:**

Cobblestone Shopping Center is well-positioned neighborhood shopping center in the heart of Redding. The property sits adjacent to planned Dignity Health medical campus that will consist of 3 medical office buildings totaling 129,600 SF.

Neighboring national tenants include America's Tire, Round Table Pizza, and many auto dealerships: Chevrolet, Toyota, Nissan, Kia and Subaru.

Full 5% commissions are for leases which are 4,000 SF or less.

Rent discounted 30% until such time that the anchor space is at least 50% leased. Up to 12 months from lease commencement.

**FEATURES:**

- Excellent visibility on Hartnell Ave
- Monument signage available
- Neighborhood shopping center located in the center of Redding
- Easy access to freeway
- Dignity Health medical campus construction to commence soon

**DEMOGRAPHICS**

	1 Mile	3 Mile	5 Mile
2017 Est Population:	5,997	63,545	94,415
2017 Household Income:	\$40,200	\$55,875	\$60,953
Daily Traffic Count:	Hartnell Ave 17,980 & E Cypress Ave 31,078		

**Race Merritt**

DRE: #01700659

race@ethanconradprop.com

**Jose Paredes-Mora**

DRE: #02068308

jose@ethanconradprop.com

**Ethan Conrad**

DRE: #01039494

ethan@ethanconradprop.com

**ETHAN CONRAD PROPERTIES, INC.**

1300 NATIONAL DRIVE, SUITE 100 | SACRAMENTO CA, 95834

916.779.1000

www.ethanconradprop.com

The information contained herein has been obtained from sources we believe to be reliable. However, we cannot guarantee, warrant or represent its accuracy and all information is subject to error, change or withdrawal. An interested party and their advisors should conduct an independent investigation of the property to determine to your satisfaction the suitability of the property for your needs.

FOR LEASE

COBBLESTONE SHOPPING CENTER  
10 - 190 HARTNELL AVE  
REDDING, CA

Site Plan

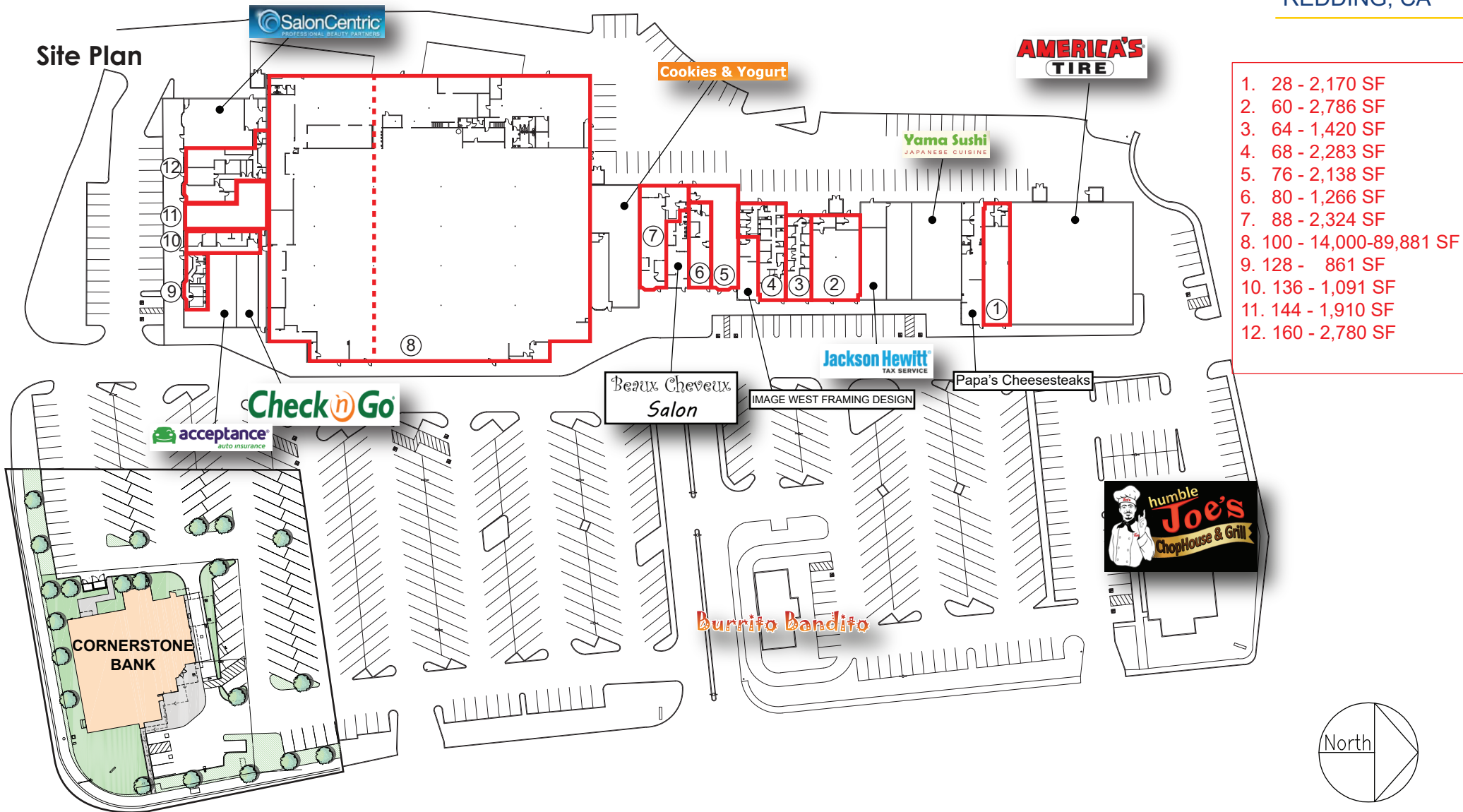

**Race Merritt**  
DRE: #01700659  
race@ethanconradprop.com

**Jose Paredes-Mora**  
DRE: #02068308  
jose@ethanconradprop.com

**Ethan Conrad**  
DRE: #01039494  
ethan@ethanconradprop.com

**ETHAN CONRAD PROPERTIES, INC.**  
1300 NATIONAL DRIVE, SUITE 100 | SACRAMENTO CA, 95834  
916.779.1000  
www.ethanconradprop.com

The information contained herein has been obtained from sources we believe to be reliable. However, we cannot guarantee, warrant or represent its accuracy and all information is subject to error, change or withdrawal. An interested party and their advisors should conduct an independent investigation of the property to determine to your satisfaction the suitability of the property for your needs.

FOR LEASE

COBBLESTONE SHOPPING CENTER  
10 - 190 HARTNELL AVE  
REDDING, CA

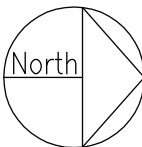
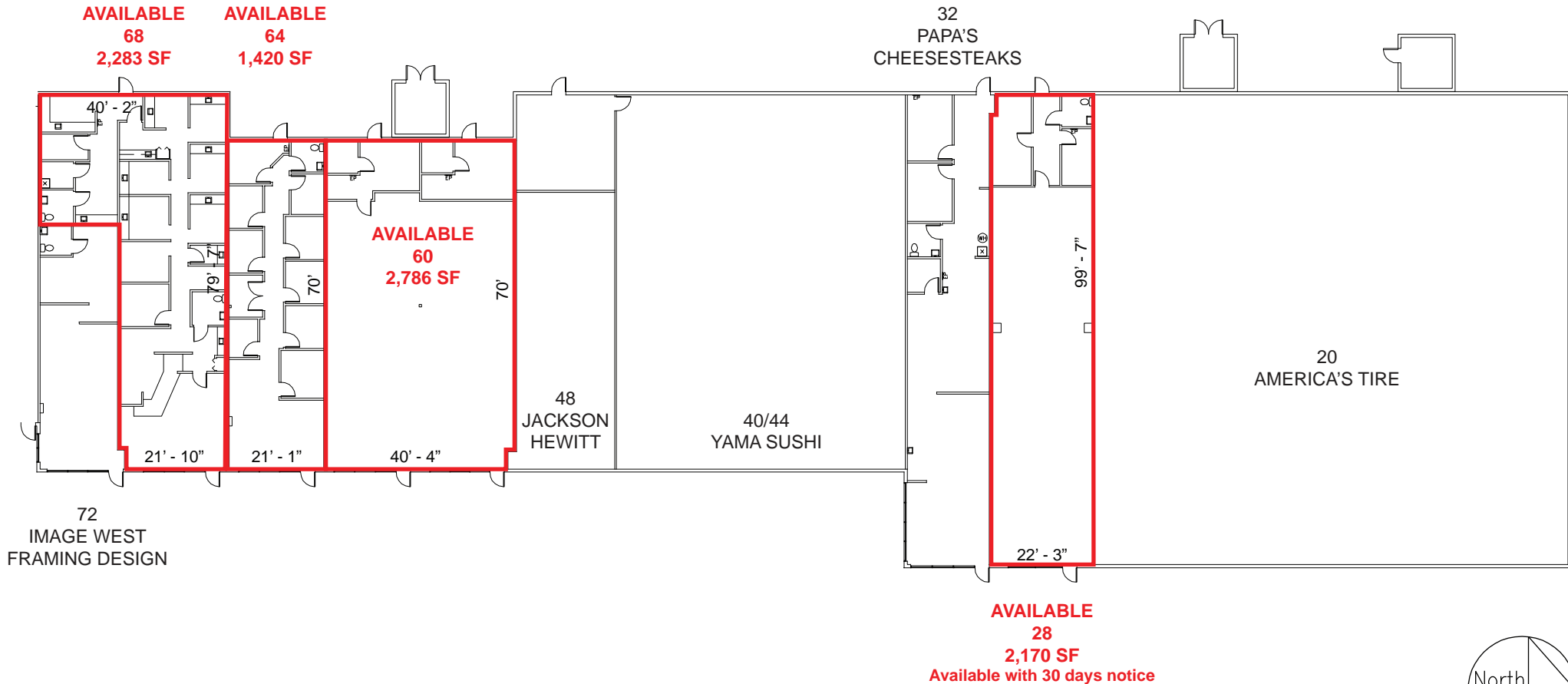

**Race Merritt**  
DRE: #01700659  
race@ethanconradprop.com

**Jose Paredes-Mora**  
DRE: #02068308  
jose@ethanconradprop.com

**Ethan Conrad**  
DRE: #01039494  
ethan@ethanconradprop.com

**ETHAN CONRAD PROPERTIES, INC.**  
1300 NATIONAL DRIVE, SUITE 100 | SACRAMENTO CA, 95834  
916.779.1000  
www.ethanconradprop.com

The information contained herein has been obtained from sources we believe to be reliable. However, we cannot guarantee, warrant or represent its accuracy and all information is subject to error, change or withdrawal. An interested party and their advisors should conduct an independent investigation of the property to determine to your satisfaction the suitability of the property for your needs.

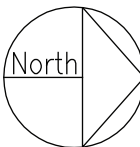
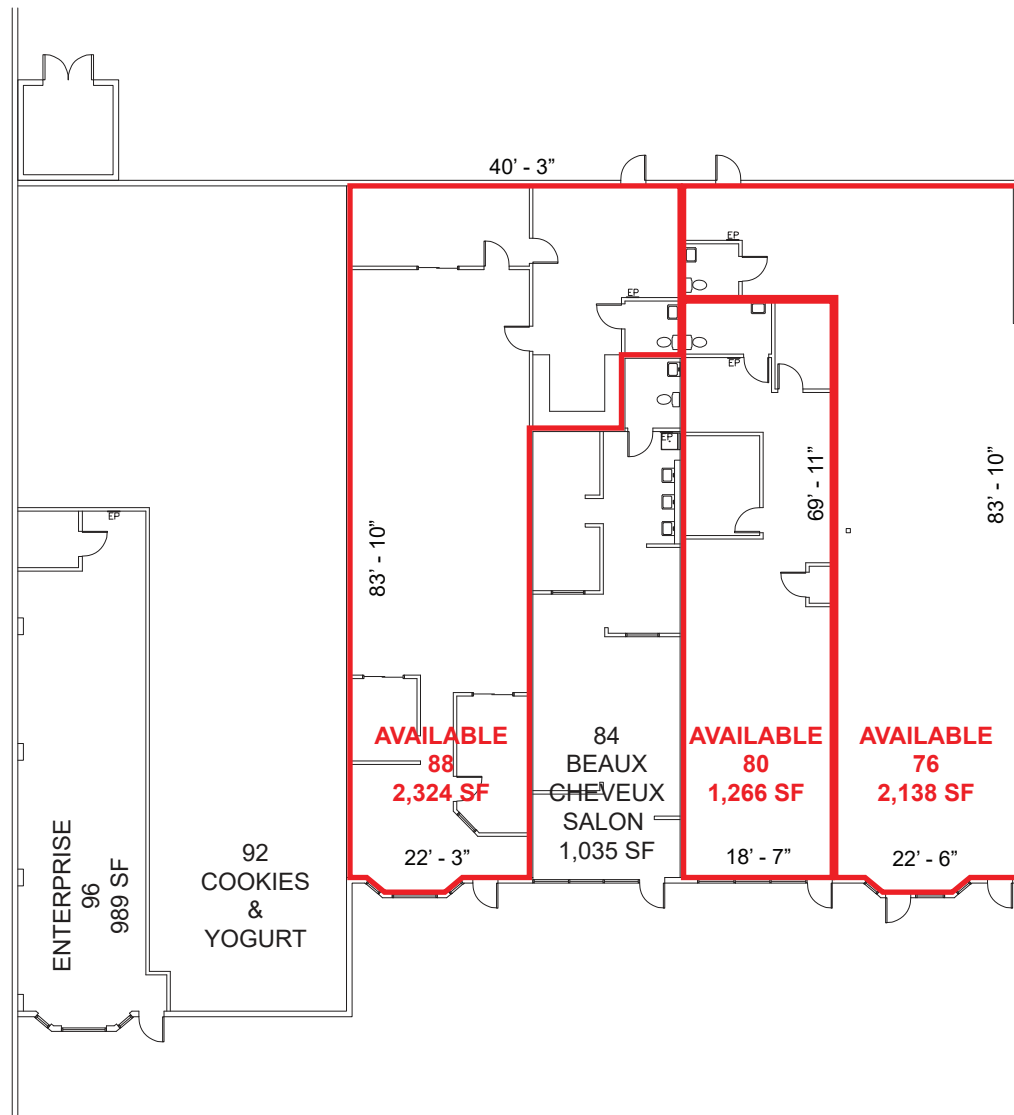

**Race Merritt**  
 DRE: #01700659  
[race@ethanconradprop.com](mailto:race@ethanconradprop.com)

**Jose Paredes-Mora**  
 DRE: #02068308  
[jose@ethanconradprop.com](mailto:jose@ethanconradprop.com)

**Ethan Conrad**  
 DRE: #01039494  
[ethan@ethanconradprop.com](mailto:ethan@ethanconradprop.com)

**ETHAN CONRAD PROPERTIES, INC.**  
 1300 NATIONAL DRIVE, SUITE 100 | SACRAMENTO CA, 95834  
 916.779.1000  
[www.ethanconradprop.com](http://www.ethanconradprop.com)

The information contained herein has been obtained from sources we believe to be reliable. However, we cannot guarantee, warrant or represent its accuracy and all information is subject to error, change or withdrawal. An interested party and their advisors should conduct an independent investigation of the property to determine to your satisfaction the suitability of the property for your needs.

FOR LEASE

COBBLESTONE SHOPPING CENTER  
10 - 190 HARTNELL AVE  
REDDING, CA

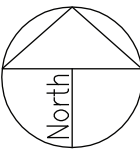
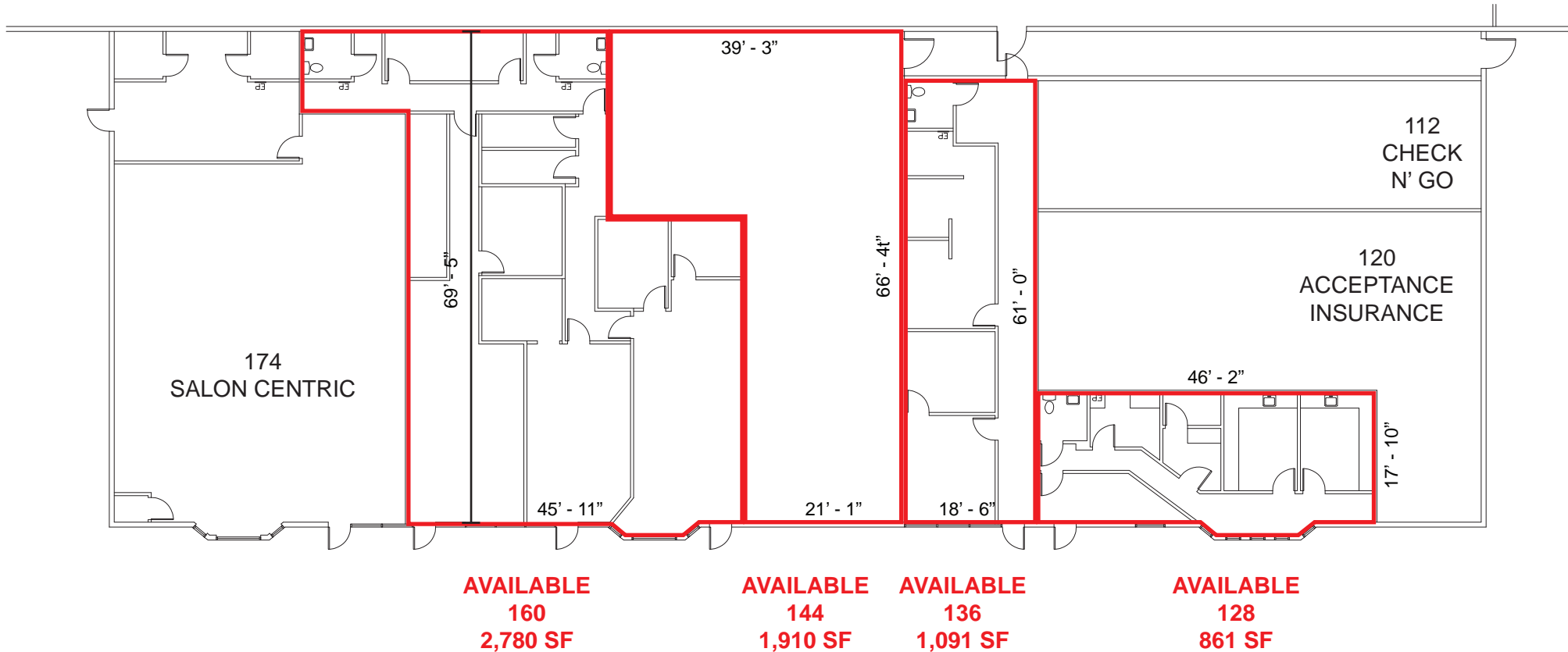

**Race Merritt**  
DRE: #01700659  
race@ethanconradprop.com

**Jose Paredes-Mora**  
DRE: #02068308  
jose@ethanconradprop.com

**Ethan Conrad**  
DRE: #01039494  
ethan@ethanconradprop.com

**ETHAN CONRAD PROPERTIES, INC.**  
1300 NATIONAL DRIVE, SUITE 100 | SACRAMENTO CA, 95834  
916.779.1000  
www.ethanconradprop.com

The information contained herein has been obtained from sources we believe to be reliable. However, we cannot guarantee, warrant or represent its accuracy and all information is subject to error, change or withdrawal. An interested party and their advisors should conduct an independent investigation of the property to determine to your satisfaction the suitability of the property for your needs.



**FOR LEASE**

**COBBLESTONE SHOPPING CENTER**  
**10 - 190 HARTNELL AVE**  
REDDING, CA



**Race Merritt**  
DRE: #01700659  
[race@ethanconradprop.com](mailto:race@ethanconradprop.com)

**Jose Paredes-Mora**  
DRE: #02068308  
[jose@ethanconradprop.com](mailto:jose@ethanconradprop.com)

**Ethan Conrad**  
DRE: #01039494  
[ethan@ethanconradprop.com](mailto:ethan@ethanconradprop.com)

**ETHAN CONRAD PROPERTIES, INC.**  
1300 NATIONAL DRIVE, SUITE 100 | SACRAMENTO CA, 95834  
916.779.1000  
[www.ethanconradprop.com](http://www.ethanconradprop.com)

The information contained herein has been obtained from sources we believe to be reliable. However, we cannot guarantee, warrant or represent its accuracy and all information is subject to error, change or withdrawal. An interested party and their advisors should conduct an independent investigation of the property to determine to your satisfaction the suitability of the property for your needs.



FOR LEASE

COBBLESTONE SHOPPING CENTER  
10 - 190 HARTNELL AVE  
REDDING, CA

PROPOSED DIGNITY MEDICAL CAMPUS RENDERING



SOURCE: CITY OF REDDING

**Race Merritt**  
DRE: #01700659  
race@ethanconradprop.com

**Jose Paredes-Mora**  
DRE: #02068308  
jose@ethanconradprop.com

**Ethan Conrad**  
DRE: #01039494  
ethan@ethanconradprop.com

**ETHAN CONRAD PROPERTIES, INC.**  
1300 NATIONAL DRIVE, SUITE 100 | SACRAMENTO CA, 95834  
916.779.1000  
www.ethanconradprop.com

The information contained herein has been obtained from sources we believe to be reliable. However, we cannot guarantee, warrant or represent its accuracy and all information is subject to error, change or withdrawal. An interested party and their advisors should conduct an independent investigation of the property to determine to your satisfaction the suitability of the property for your needs.



FOR LEASE

COBBLESTONE SHOPPING CENTER  
10 - 190 HARTNELL AVE  
REDDING, CA



**Race Merritt**  
DRE: #01700659  
race@ethanconradprop.com

**Jose Paredes-Mora**  
DRE: #02068308  
jose@ethanconradprop.com

**Ethan Conrad**  
DRE: #01039494  
ethan@ethanconradprop.com

**ETHAN CONRAD PROPERTIES, INC.**  
1300 NATIONAL DRIVE, SUITE 100 | SACRAMENTO CA, 95834  
916.779.1000  
www.ethanconradprop.com

The information contained herein has been obtained from sources we believe to be reliable. However, we cannot guarantee, warrant or represent its accuracy and all information is subject to error, change or withdrawal. An interested party and their advisors should conduct an independent investigation of the property to determine to your satisfaction the suitability of the property for your needs.