



CASWELL COUNTY

Permit No. P-072902-05

Environmental Health Division

144 Main Street • P.O. Box 1238 • Yanceyville, North Carolina 27379

(336) 694-9731 • Fax. (336) 694-5547

IMPROVEMENT PERMIT

(Includes Well Permit)

NOTE: The improvement permit DOES NOT authorize the construction or installation of a septic tank system. A Construction Authorization must be issued by our department prior to the installation of an On-Site Wastewater System.

Name: Cathy Gammien + Tina UnderwoodAddress: PO Box 17
Pelham, NC 27511Subdivision/Lot #/Directions: 86N to Shady Grove
Rd to Hwy 700 - prop beside large
metal bldg on right.Facility Type: Hair SalonNumber of Bedrooms: NANumber of Occupants; Employees: 3/4Design Wastewater Flow: 350g/dType System: Conventional: TIA Other: _____

Required Site Modifications/Conditions: _____

CONSTRUCTION AUTHORIZATION

SPECIFICATIONS	LAYOUT	INSTALLED
System Type	<u>TIA</u>	<u>TIA</u>
Tank Size ____ /# ____	<u>1000gal</u>	<u>51B-769</u>
Drainfield sq. ft.	<u>1200'</u>	<u>1200'</u>
Water Supply	<u>priv.</u>	<u>priv.</u>
# of Lines/Length of Lines	<u>1x400'</u>	<u>1x400'</u>
Trench depth	<u>24"</u>	<u>24"</u>
Trench width	<u>36"</u>	<u>36"</u>
Depth of rock below pipe	<u>6"</u>	<u>6"</u>
Total rock depth	<u>12"</u>	<u>12"</u>
Distance to foundation	<u>5'</u>	<u>5'</u>
Distance to property lines	<u>10'</u>	<u>10'</u>
Distance to well	<u>100'</u>	<u>100'</u>
Water Shed		<u>-</u>

SEE ATTACHMENT FOR SYSTEM AREA AND WELL SITEPermit Expires: 5 Years No ExpirationSigned: Donnie Powell Date: 7/29/02Signed: Donnie Powell Date: 7/29/02

OPERATION PERMIT

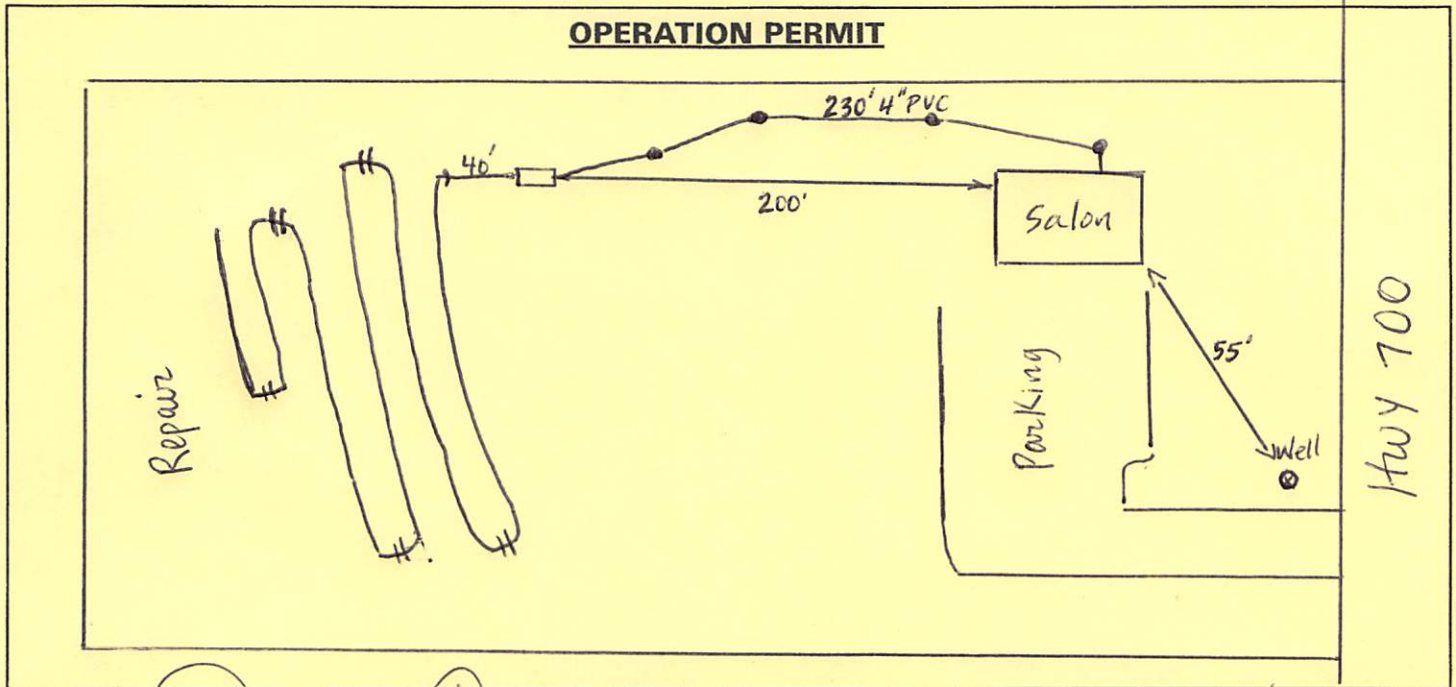
Authorized Agent: Donnie PowellDate: 3/28/03

APPEALS: By written petition to the Office of Administrative Hearings, P.O. Drawer 17447, Raleigh, North Carolina 27611-7447. In accordance with GS, 150 B-23(a) THIS PERMIT may be suspended or revoked upon that a finding that a violation of ... this Chapter, The Rules ... or a condition imposed upon the permit has occurred ... Also upon a finding that it's issuance was based on incorrect or inadequate information ... GA, 130A-23(aXeXd).

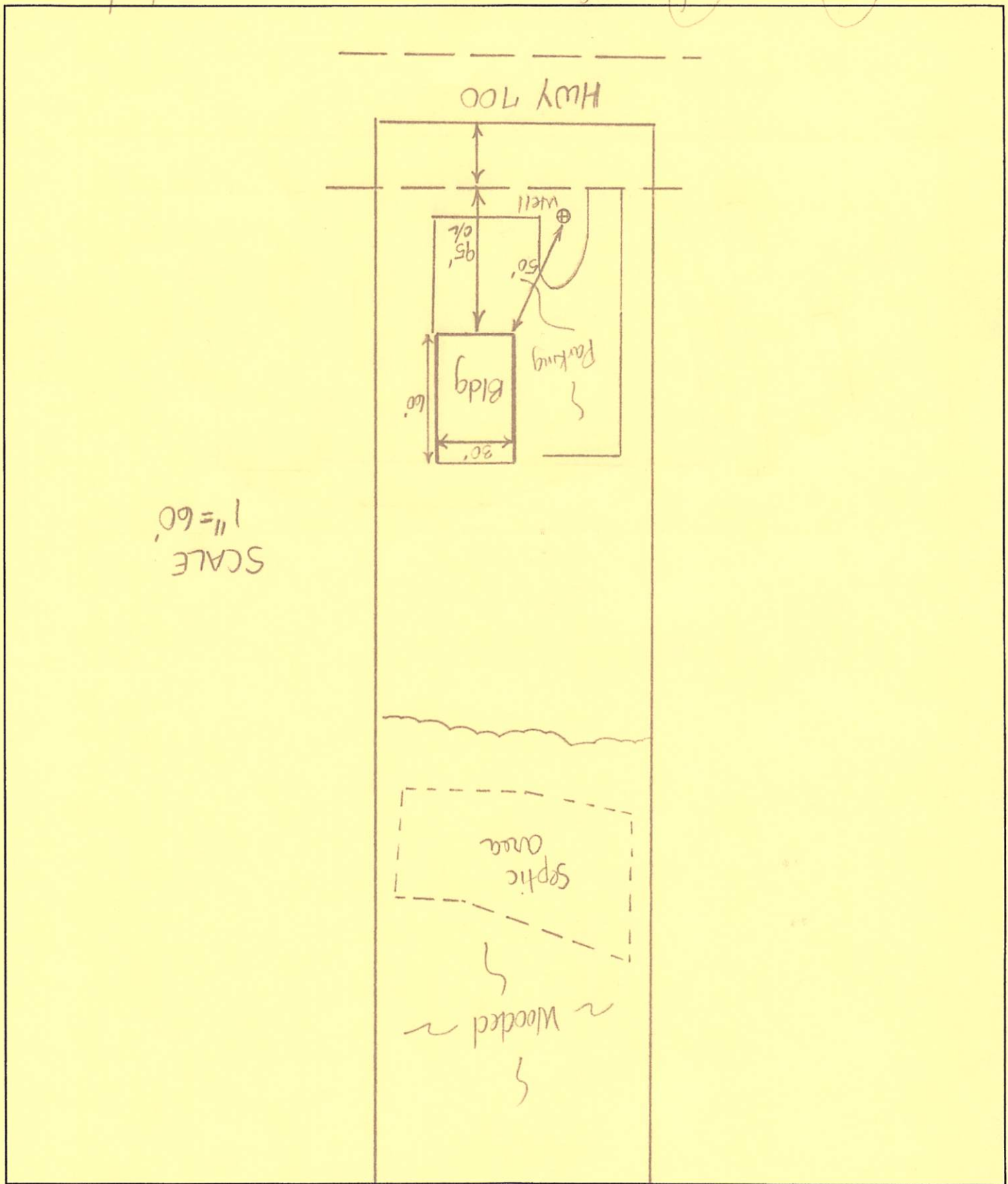

SCALE 1" = 60'

Diagrams of the specific locations of the existing/proposed facility and the site for the wastewater system are documented below. THIS PERMIT IS SUBJECT TO REVOCATION IF SITE PLANS OR THE INTENDED USE CHANGE. ALTERATION OF THE SITE OR SOIL CONDITIONS MAY RESULT IN THE REVOCATION OF THIS PERMIT.

CASWELL COUNTY ENVIRONMENTAL HEALTH

- IMPROVEMENT PERMIT
- WELL PERMIT
- CONSTRUCTION AUTHORIZATION

NAME: Cathy Gannon/Ting Underwood

Permit No. P-072902-05

Survey plat to scale of
1" = no more than 60' submitted.

5/13

Application for
Improvement Permit and/or Authorization to Construct

Scaled site plan (1" = no more than 60') submitted.
-Or-
 Unscaled Site plan submitted

Improvement Permit Authorization to Construct

IF THE INFORMATION IN THE APPLICATION FOR AN IMPROVEMENTS PERMIT IS FALSIFIED CHANGED OR THE SITE IS ALTERED, THEN THE IMPROVEMENTS PERMIT AND AUTHORIZATION TO CONSTRUCT SHALL BECOME INVALID. The permit is valid for either 60 months or without expiration depending upon documentation submitted.

APPLICANT INFORMATION

Cathy Harmon P.O. Box 177 Pelham, N.C. 27311
Jina Underwood 761 Chandler mill Rd 336-939-9033
Applicant Address Home & Work Phone

Seller

Tom Scismon 158 Imperial Rd. Pelham N.C. 27311 336-939-9248/494-793-7601
Owner Address Home & Work Phone

PROPERTY INFORMATION

Street Address Subdivision Name Section/Phase/Lot#

Directions to Site:
876 to Pelham left on Shady Grove Rd Approx 1 mile
Past Sam's corner on Right on top of hill
Beside of New metal Building

- New Single Family Residence
- Expansion of Existing
- Repair to Existing Subsurface Sewage Disposal System
- Non-Residential Type of Structure

Residential Specifications:
Max. number of bedrooms (2 people/bedroom):
Max. number of occupants (if more than 2 people/bedroom):
Basement?
Basement fixtures (list):

DEVELOPMENT INFORMATION

Non-Residential Specifications:
Type of business: Hair Salon Total Square Footage of Building: 1800 sq. FT.
Max. number of employees: 3 Max. number of seats: 20 Other: _____

Water Supply:
 NEW WELL EXISTING WELL COMMUNITY WELL PUBLIC

Please Indicate Desired System Type(s): (systems can be ranked in order of your preference)
____ Alternative ____ Conventional ____ Innovative ____ Modified Conventional ____ Other (specify)

The Applicant shall notify the local health department upon submittal of this application if any of the following apply to the property in question. If the answer to any question is "yes", applicant must attach supporting documentation.

YES	NO
<input checked="" type="checkbox"/>	<input type="checkbox"/>
<input checked="" type="checkbox"/>	<input type="checkbox"/>
<input checked="" type="checkbox"/>	<input type="checkbox"/>

FEE.....\$150.00

SAMPLE SITE PLAN

If you are applying for a site evaluation for an Improvement Permit (sometimes referred to as a "Septic Tank Permit"), you are required to provide us with a "SITE PLAN". To assist you in preparing this important piece of information, we have prepared this sample Site Plan, which shows the type of information you need to provide. Keep in mind that we will not be able to begin your site evaluation until we have received a site plan from you. If you have any questions, you can contact us at (336) 694-9731

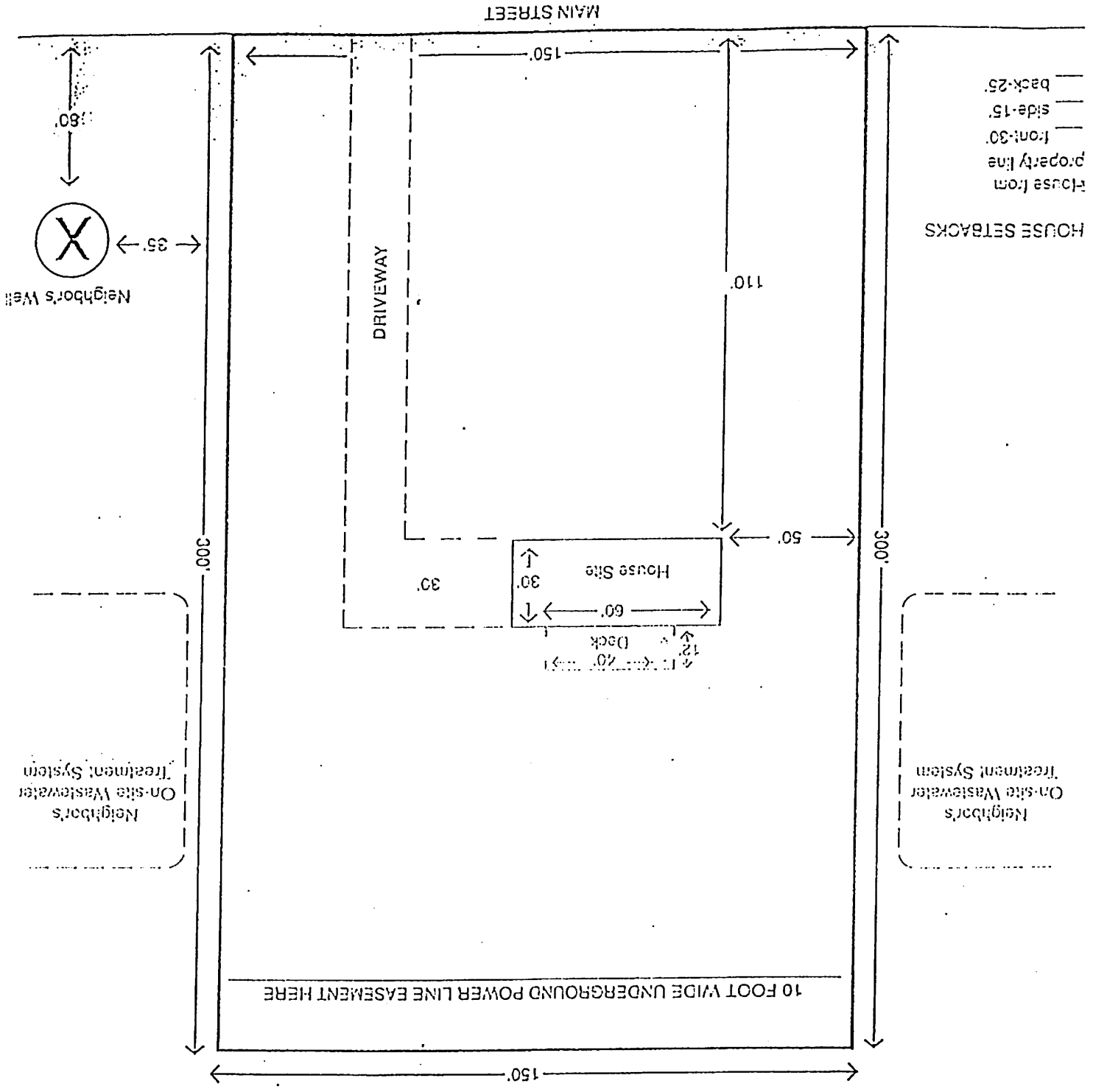

I have read this application and certify that the information provided herein is true, complete and correct. Authorized county and state officials are granted right of entry to conduct necessary inspections to determine compliance with applicable laws and rules. I understand that I am solely responsible for the proper identification and labeling of all property lines and corners and making the site accessible so that a complete site evaluation can be performed.

Arthur Johnson

Property owner's or owner's legal representative** signature (required)

**Must provide documentation to support claim as owner's legal representative.

5-13-02
Date

5-13-02

Please use the following space to sketch your site plan. Please include all proposed structures (buildings, driveways, ponds or pools).

Open Field

