

10235 South

Jordan Gateway

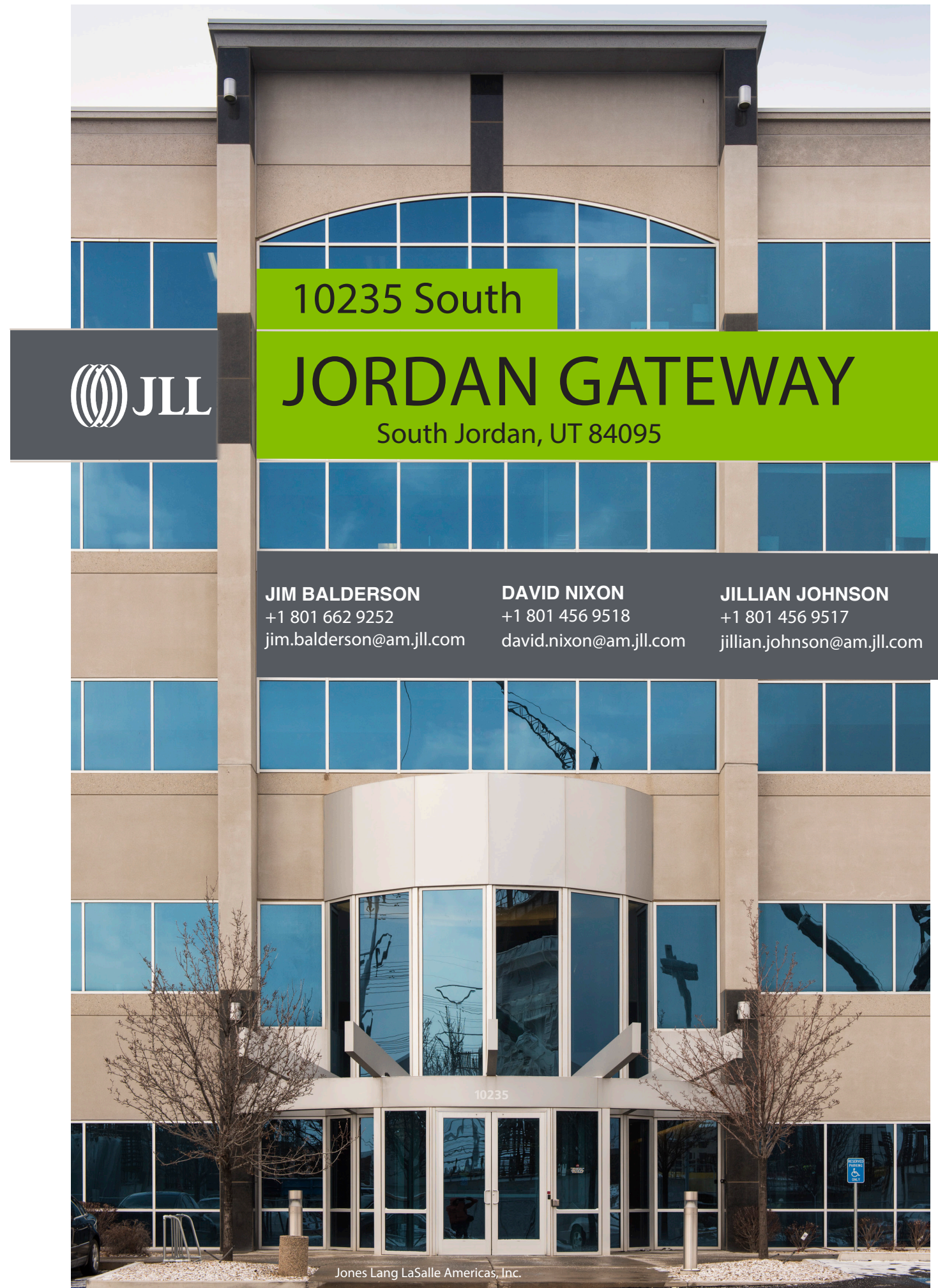

10235 South

JORDAN GATEWAY

South Jordan, UT 84095



JIM BALDERSON
+1 801 662 9252
jim.balderson@am.jll.com

DAVID NIXON
+1 801 456 9518
david.nixon@am.jll.com

JILLIAN JOHNSON
+1 801 456 9517
jillian.johnson@am.jll.com



JIM BALDERSON
+1 801 662 9252
jim.balderson@am.jll.com

DAVID NIXON
+1 801 456 9518
david.nixon@am.jll.com

JILLIAN JOHNSON
+1 801 456 9517
jillian.johnson@am.jll.com

10235 South

Jordan Gateway

Available Space: 36,336 RSF
Rental Rate: \$24.50 / SF Full Service

1ST FLOOR

6,650 RSF
Occupancy within 60 days



3RD FLOOR

14,843 RSF

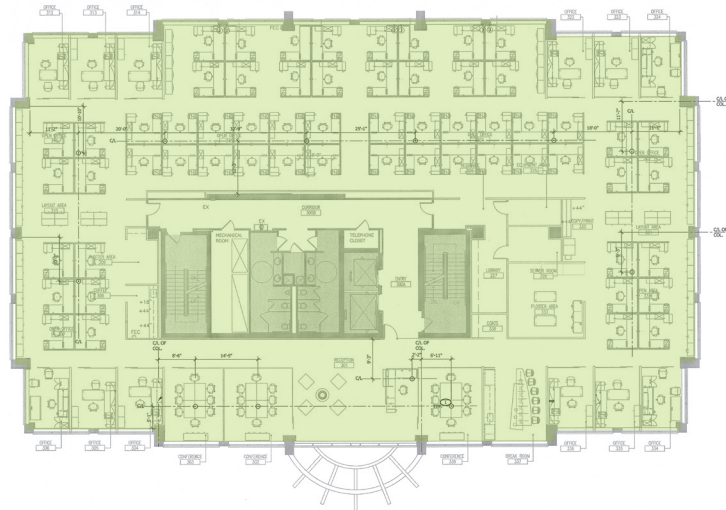

4TH FLOOR

14,843 RSF
Available Jan 2021

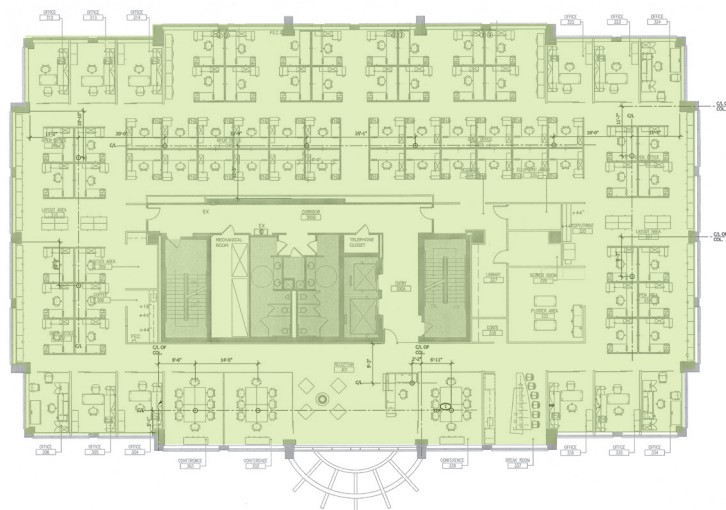

FEATURES

- Crown Signage Available
- Ideal South Valley location with freeway visibility off I-15
- Close proximity to South Towne shopping, restaurants & other amenities
- Short walking distance to UTA FrontRunner high speed rail

