



HIGH PROFILE
300KIMBALL.COM



400,147 SF CLASS A OFFICE FOR LEASE

300 KIMBALL

300 KIMBALL DRIVE | PARSIPPANY, NJ 07054





HIGH PROFILE CLASS A OFFICE SPACE

- Intersection of I-287 and I-80
- Newly renovated:
 - New lobbies
 - New food service/cafeteria
 - New exercise facility with lockers and showers
 - New shared conference center- seats 50
- Covered executive parking
- BOMA: The Outstanding Building of the Year Award 2015
- LEED Silver - Energy Star

LEASING INFORMATION

Matt McDonough
 973.947.9203
 matt.mcdonough@transwestern.com

James Postell
 973.947.9201
 james.postell@transwestern.com



180 Park Avenue, 1st Floor, Parsippany, NJ 07932
 T 973.947.9200 F 973.947.9199 www.transwestern.com

First Floor

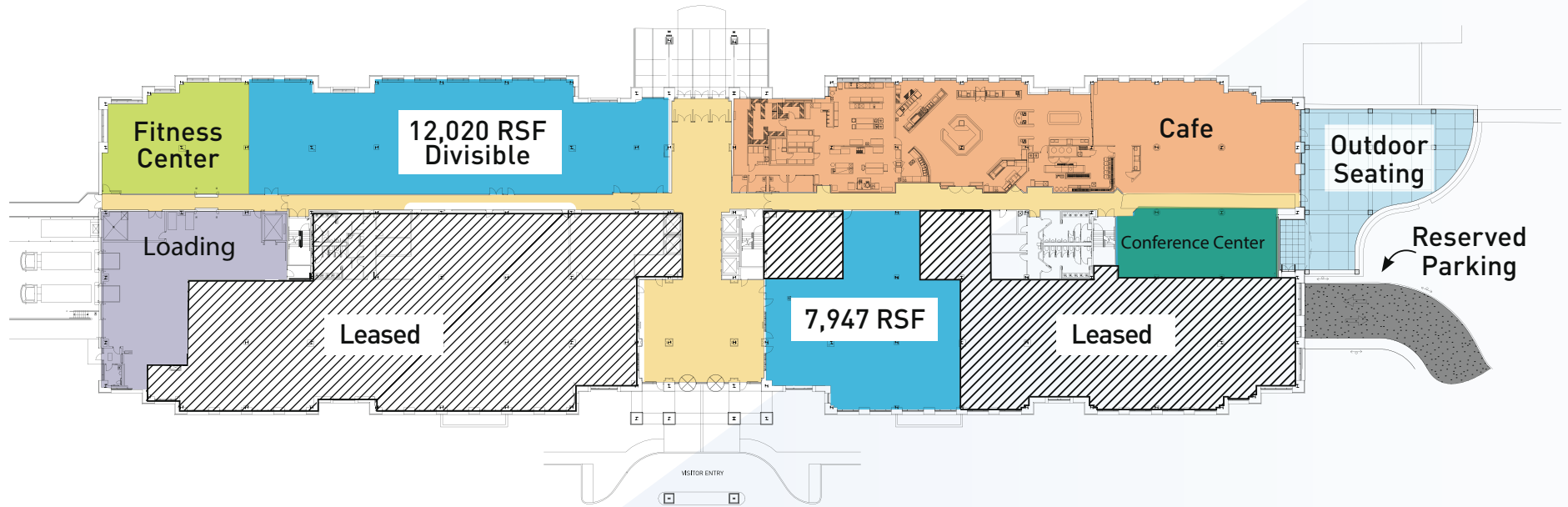

300 Kimball Drive
Parsippany, New Jersey

300kimball.com

EXCLUSIVE BROKERS

James Postell 973.947.9201
Matt McDonough 973.947.9203

James.Postell@transwestern.com
Matt.McDonough@transwestern.com



Second Floor

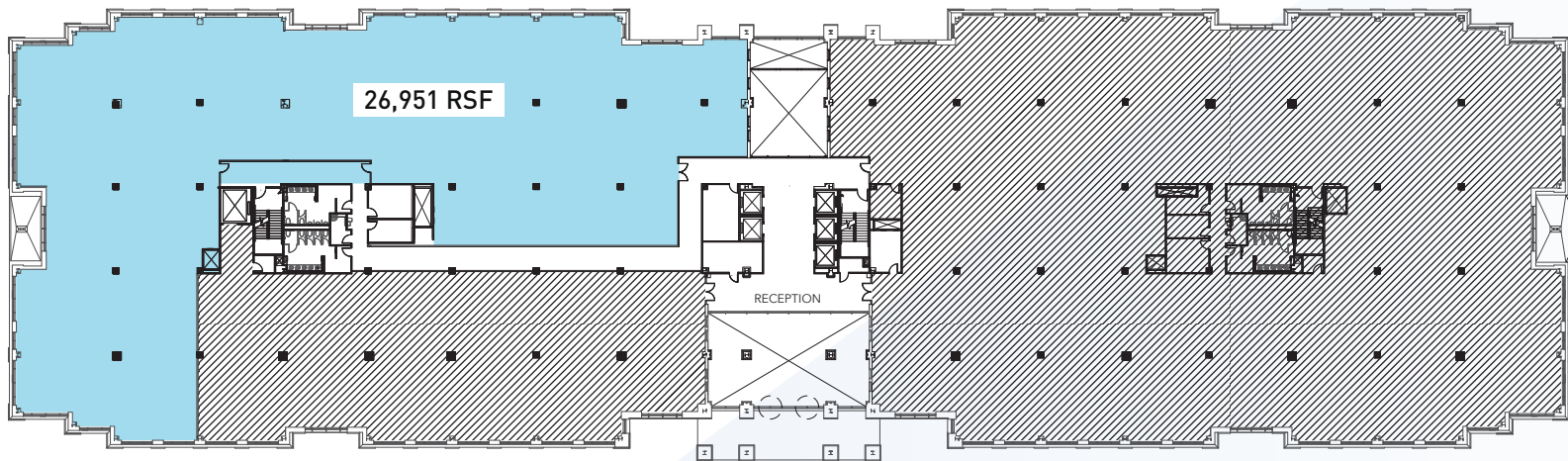

300 Kimball Drive
Parsippany, New Jersey

300kimball.com

EXCLUSIVE BROKERS

James Postell 973.947.9201
Matt McDonough 973.947.9203

James.Postell@transwestern.com
Matt.McDonough@transwestern.com



Third Floor

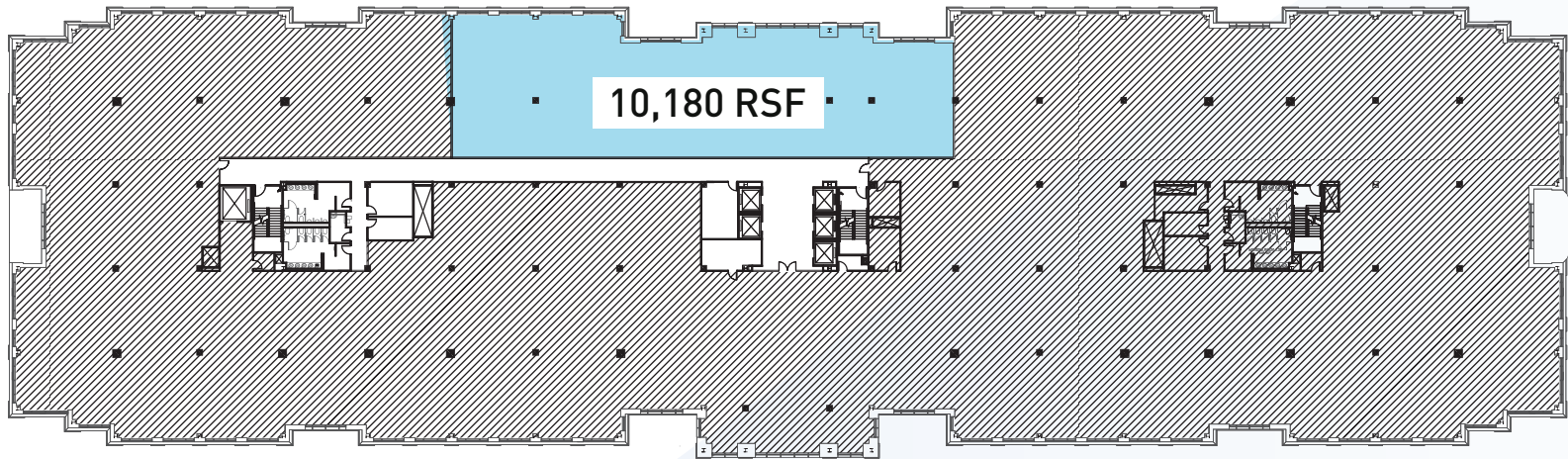

300 Kimball Drive
Parsippany, New Jersey

300kimball.com

EXCLUSIVE BROKERS

James Postell 973.947.9201
Matt McDonough 973.947.9203

James.Postell@transwestern.com
Matt.McDonough@transwestern.com

 **TRANSWESTERN®**

Fourth Floor



300 Kimball Drive
Parsippany, New Jersey

300kimball.com

EXCLUSIVE BROKERS

James Postell 973.947.9201
Matt McDonough 973.947.9203

James.Postell@transwestern.com
Matt.McDonough@transwestern.com

 **TRANSWESTERN**[®]

Fifth Floor

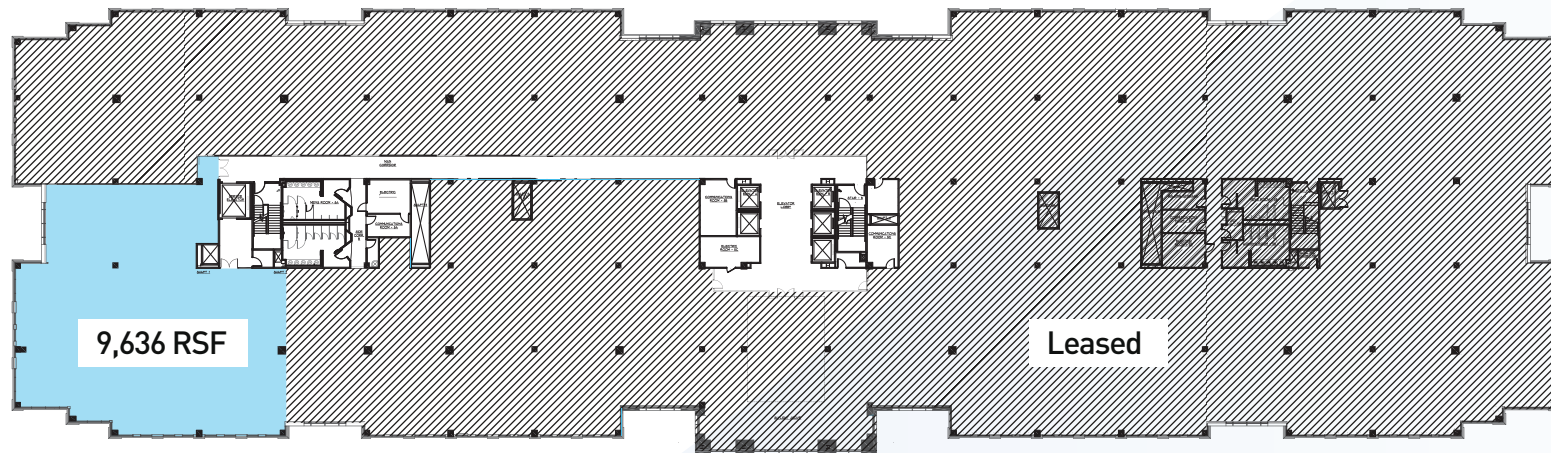

300 Kimball Drive
Parsippany, New Jersey

300kimball.com

EXCLUSIVE BROKERS

James Postell 973.947.9201
Matt McDonough 973.947.9203

James.Postell@transwestern.com
Matt.McDonough@transwestern.com

