



251,961 SF AVAILABLE
FOR LEASE SPRING 2020

1755 North Butterfield Rd

Libertyville, IL

Owned & Managed by:



HOME

HIGHLIGHTS

AVAILABLE

SITE PLAN

AMENITIES

LOCATION

For more information, please contact:

ERIC FISCHER
Managing Director

+1 847 720 1369
eric.fischer@cushwake.com

KEITH PURITZ
Executive Director

+1 847 720 1366
keith.puritz@cushwake.com

BRETT KRONER
Executive Director

+1 847 720 1367
brett.kroner@cushwake.com

MARC SAMUELS
Associate

+1 847 720 1368
marc.samuels@cushwake.com

cushmanwakefield.com

Property Highlights

Available Space:	251,961 SF (Divisible)
Total Building Size:	251,961 SF
Site Size:	13.48 Acres
Office Area:	12,500 SF
Clear Height:	26'-28'
Car Parking:	86 Spaces (Expandable)
Trailer Parking:	13 Stalls
Loading Docks:	19 Total (10 Exterior and 9 Interior)
Drive-In Door(s):	2
Bay Sizes:	26' x 46'
Sprinkler System:	ESFR
Power:	4,000 Amps @ 277/480v, 3 Phase
Lease Rate:	\$5.50/sf Gross



For more information, please contact:

ERIC FISCHER
Managing Director

+1 847 720 1369
eric.fischer@cushwake.com

KEITH PURITZ
Executive Director

+1 847 720 1366
keith.puritz@cushwake.com

BRETT KRONER
Executive Director

+1 847 720 1367
brett.kroner@cushwake.com

MARC SAMUELS
Associate

+1 847 720 1368
marc.samuels@cushwake.com

cushmanwakefield.com

HOME

HIGHLIGHTS

AVAILABLE

SITE PLAN

AMENITIES

LOCATION

Space Available

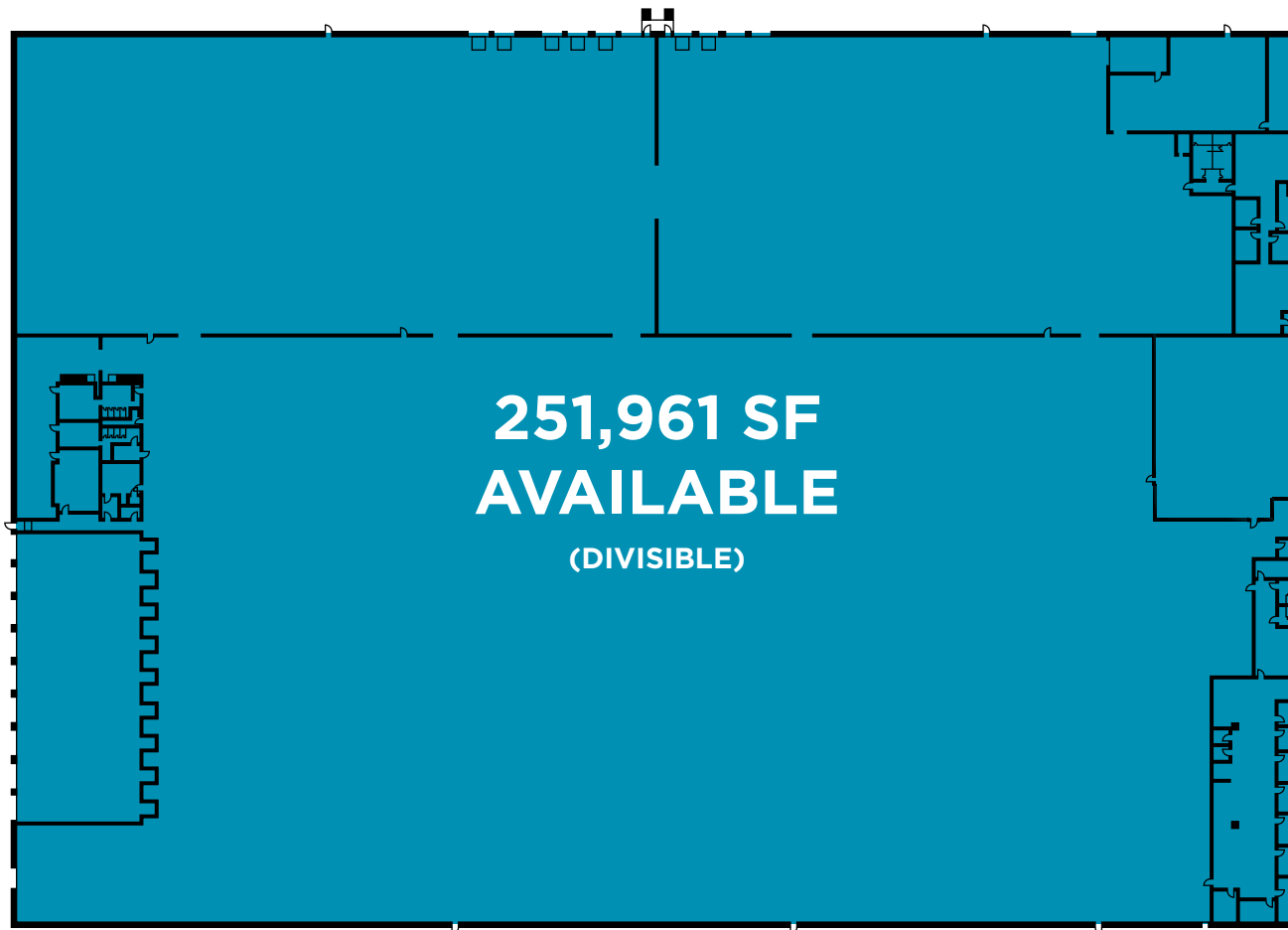
**12,500 SF OFFICE****19 LOADING DOCKS****86 PARKING SPACES**

For more information, please contact:

ERIC FISCHER
Managing Director

+1 847 720 1369
eric.fischer@cushwake.com

KEITH PURITZ
Executive Director

+1 847 720 1366
keith.puritz@cushwake.com

BRETT KRONER
Executive Director

+1 847 720 1367
brett.kroner@cushwake.com

MARC SAMUELS
Associate

+1 847 720 1368
marc.samuels@cushwake.com

cushmanwakefield.com

Site Plan

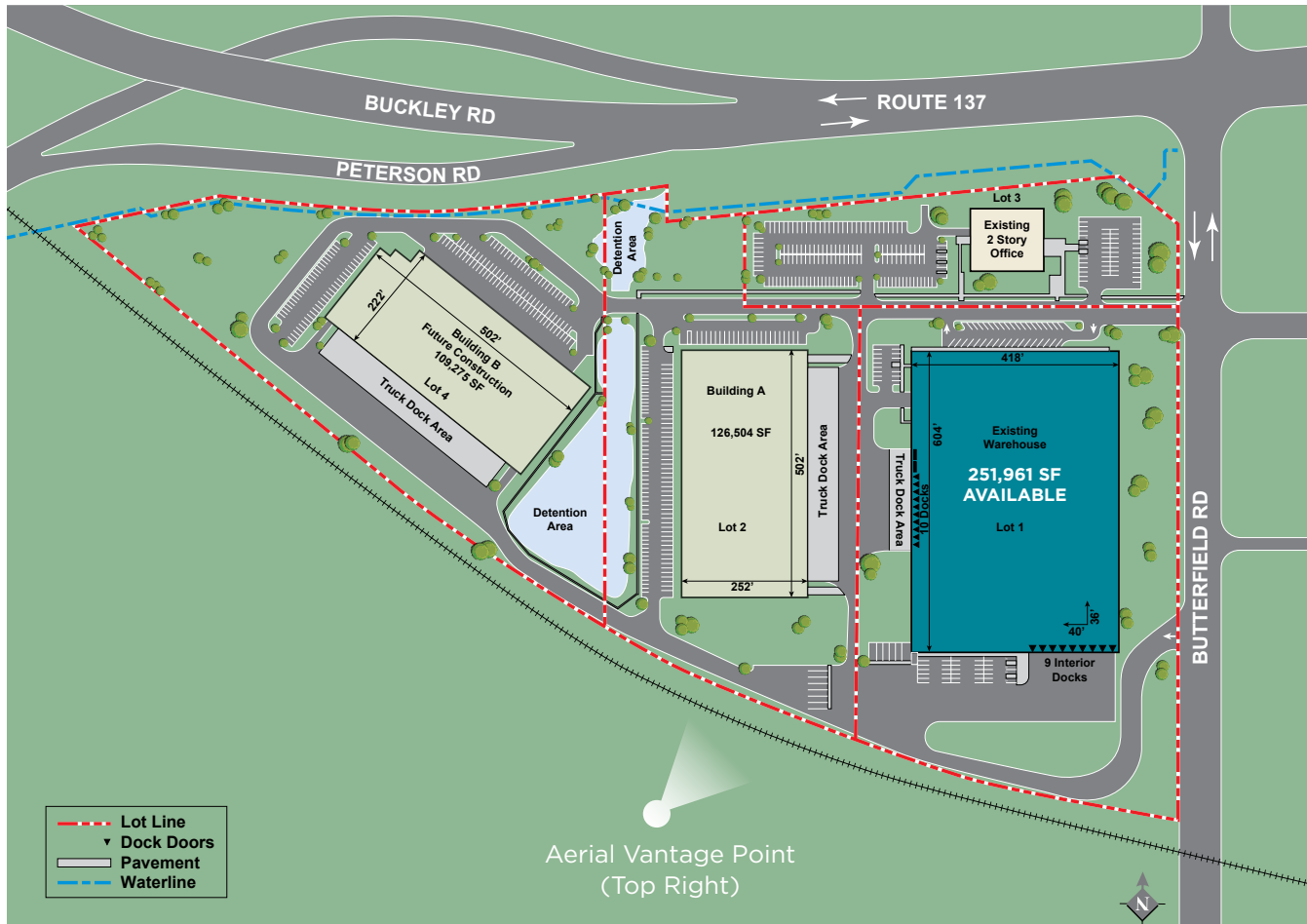

For more information, please contact:

ERIC FISCHER
 Managing Director

+1 847 720 1369
 eric.fischer@cushwake.com

KEITH PURITZ
 Executive Director

+1 847 720 1366
 keith.puritz@cushwake.com

BRETT KRONER
 Executive Director

+1 847 720 1367
 brett.kroner@cushwake.com

MARC SAMUELS
 Associate

+1 847 720 1368
 marc.samuels@cushwake.com

cushmanwakefield.com

Local Amenities

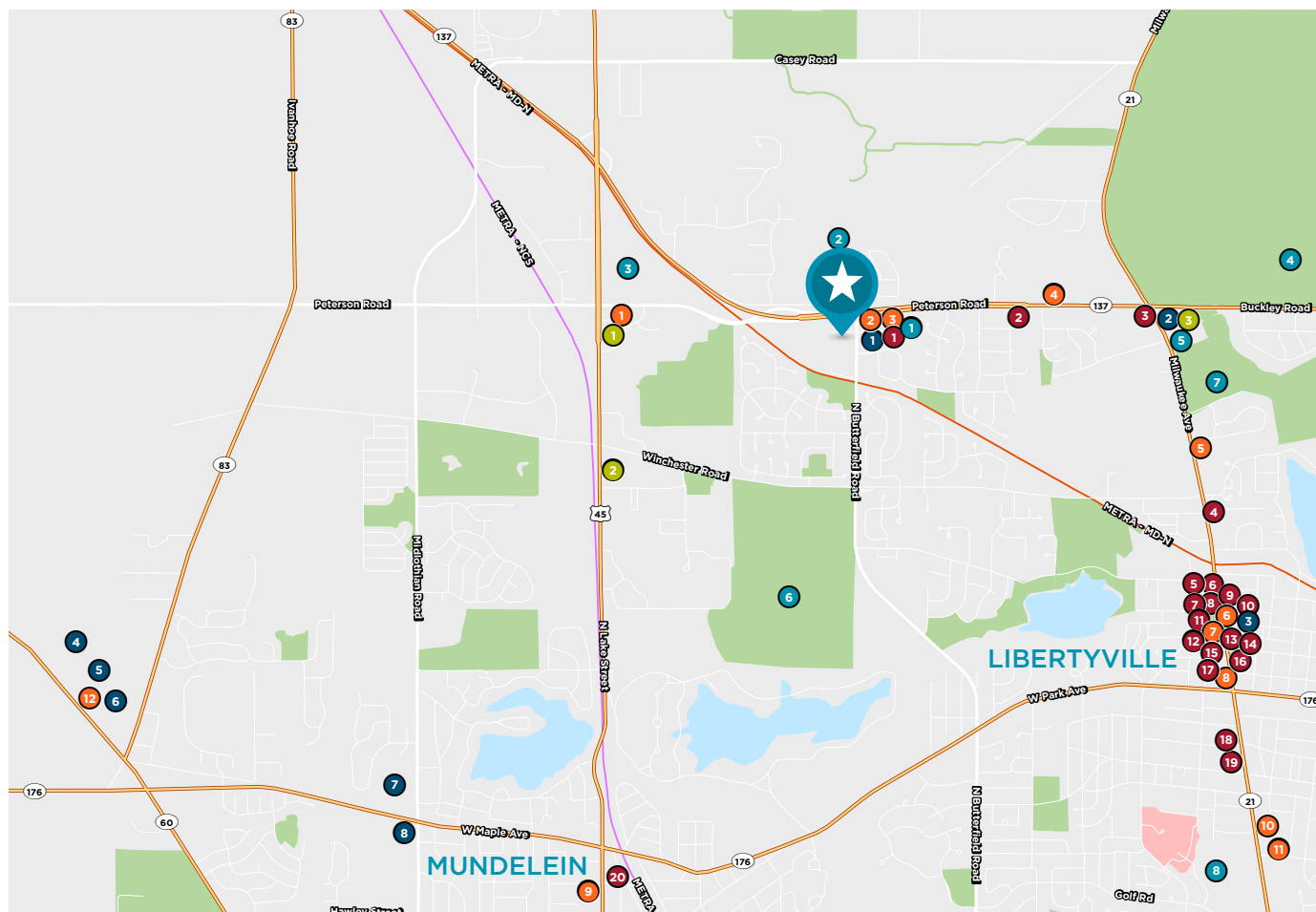

- **Full-Service Dining**
 - 1 Jimmy's Charhouse
 - 2 Austin's Eatery
 - 3 Wildberry
 - 4 Ristorante Bottaio
 - 5 Egg Harbor Cafe
 - 6 Casa Bonita
 - 7 Oscar Lee's Barbecue
 - 8 Shakou
 - 9 Main Street Social
 - 10 Chrissoula's
 - 11 Tavern Steakhouse
 - 12 Firkin
 - 13 Townee Square
 - 14 O'Toole's
 - 15 Chili-U
 - 16 Pizzeria DeVille
 - 17 Mickey Finn's
 - 18 Hanakawa Sushi
 - 19 Liberty Restaurant
 - 20 Park Street
- **Fast Food**
 - 1 Wendy's
 - 2 Ganello's Pizza
 - 3 McDonald's
 - 4 Dunkin Donuts
 - 5 Taco Bell
 - 6 Starbucks Coffee
 - 7 The Picnic Basket
 - 8 Chipotle
 - 9 Subway
 - 10 Gino's East
 - 11 Panera Bread
 - 12 Rosati's Pizza
- **Hotels**
 - 1 Hampton Inn
 - 2 Candlewood Suites
 - 3 Holiday Inn Express
- **Recreation**
 - 1 Anytime Fitness
 - 2 Liberty Prairie Preserve
 - 3 Libertyville Sports Complex
 - 4 Independence Grove Forest Preserve
 - 5 Pinnacle Fitness
 - 6 Pine Meadow Golf Club
 - 7 Adler Park
 - 8 Centre Club
- **Retail**
 - 1 Sunset Foods
 - 2 Walgreens
 - 3 Downtown Libertyville Shops
 - 4 The Home Depot
 - 5 SuperTarget
 - 6 HomeGoods
 - 7 Jewel-Osco
 - 8 CVS Pharmacy

For more information, please contact:

ERIC FISCHER
Managing Director

+1 847 720 1369
eric.fischer@cushwake.com

KEITH PURITZ
Executive Director

+1 847 720 1366
keith.puritz@cushwake.com

BRETT KRONER
Executive Director

+1 847 720 1367
brett.kroner@cushwake.com

MARC SAMUELS
Associate

+1 847 720 1368
marc.samuels@cushwake.com

cushmanwakefield.com

Location Overview

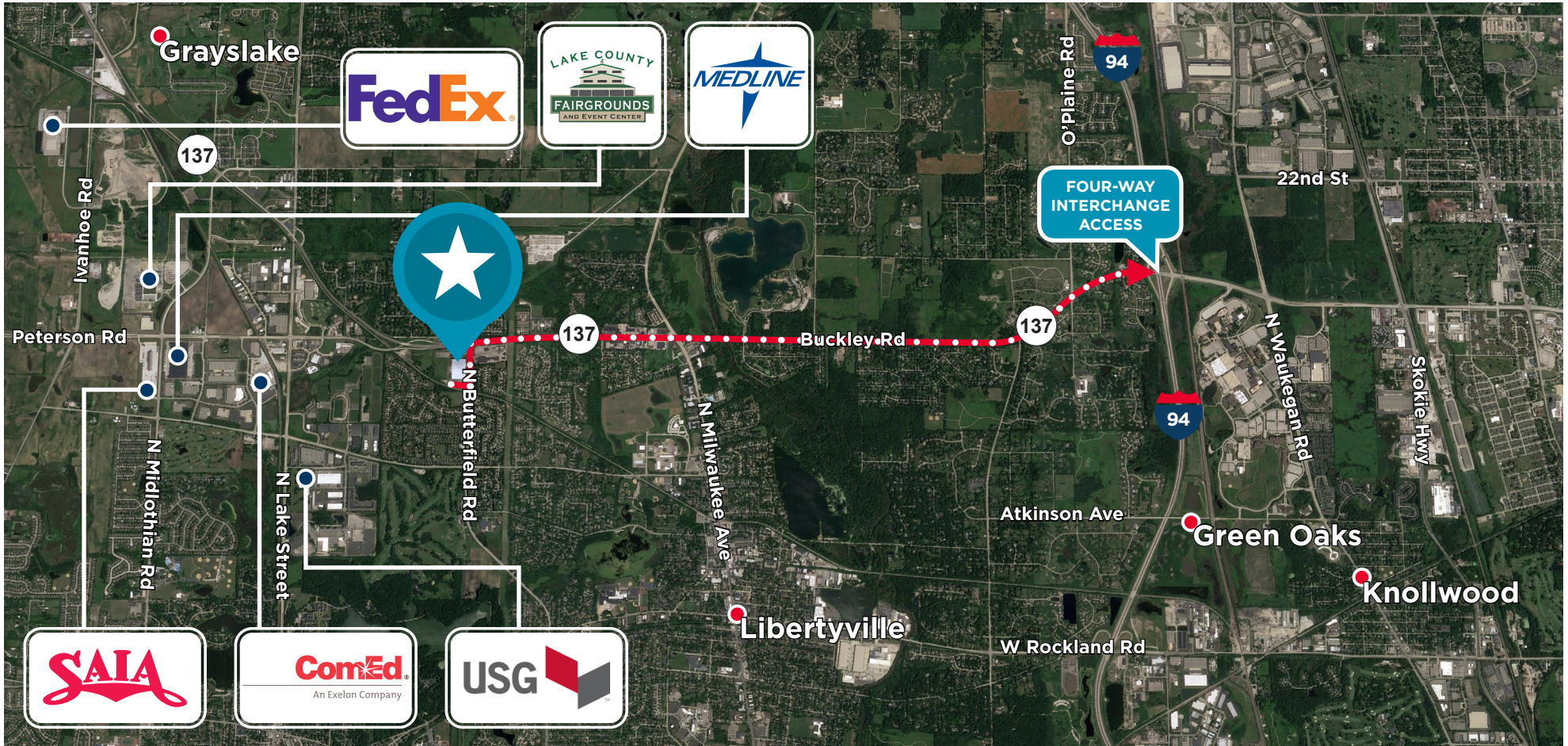

For more information, please contact:

ERIC FISCHER
Managing Director

+1 847 720 1369
eric.fischer@cushwake.com

KEITH PURITZ
Executive Director

+1 847 720 1366
keith.puritz@cushwake.com

BRETT KRONER
Executive Director

+1 847 720 1367
brett.kroner@cushwake.com

MARC SAMUELS
Associate

+1 847 720 1368
marc.samuels@cushwake.com

cushmanwakefield.com