

Regency Village

12211 Regency Village Drive, Orlando, FL 32821



EQUITY
INVESTMENT
SERVICES

PROPERTY SUMMARY

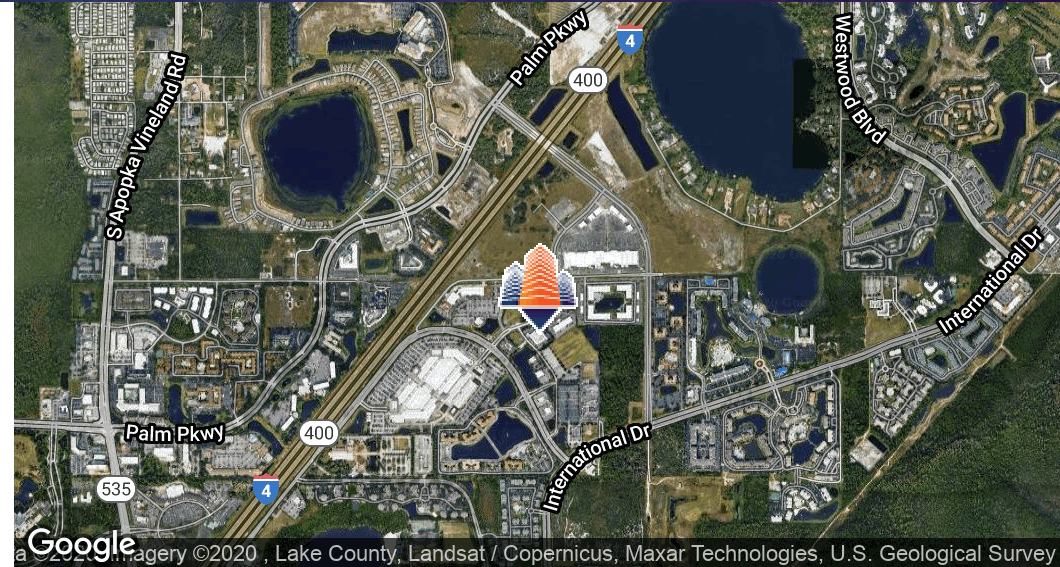

PROPERTY HIGHLIGHTS

- Availability From 1,000 SF up to 2,750 SF
- 0.88 Acre Pad-Ready Outparcel Available for Ground Lease or Build to Suit
- Class 'A' Retail Center Located In a High Traffic Tourist and Shopping Corridor
- 33,500+ Vehicles Per Day on Vineland Road
- Conveniently Positioned Near I-4, Orlando Vineland Premium Outlets, and International Drive

OFFERING SUMMARY

Lease Rate:	Negotiable
Available SF:	1,000 - 2,750 SF
Building Size:	33,913 SF

DEMOGRAPHICS	1 MILE	3 MILES	5 MILES
Total Households	1,186	10,076	26,832
Total Population	2,954	26,091	72,731
Average HH Income	\$80,986	\$87,444	\$85,057

Nick Barbato
407.573.0711 x309
nbarbato@eisre.com

Ryan D'Agostino
407.573.0711 x312
rdagostino@eisre.com



7575 Dr. Phillips Blvd, Ste 390
Orlando, FL 32819
www.eisre.com

Regency Village

12211 Regency Village Drive, Orlando, FL 32821



EQUITY
INVESTMENT
SERVICES

SITE PLAN

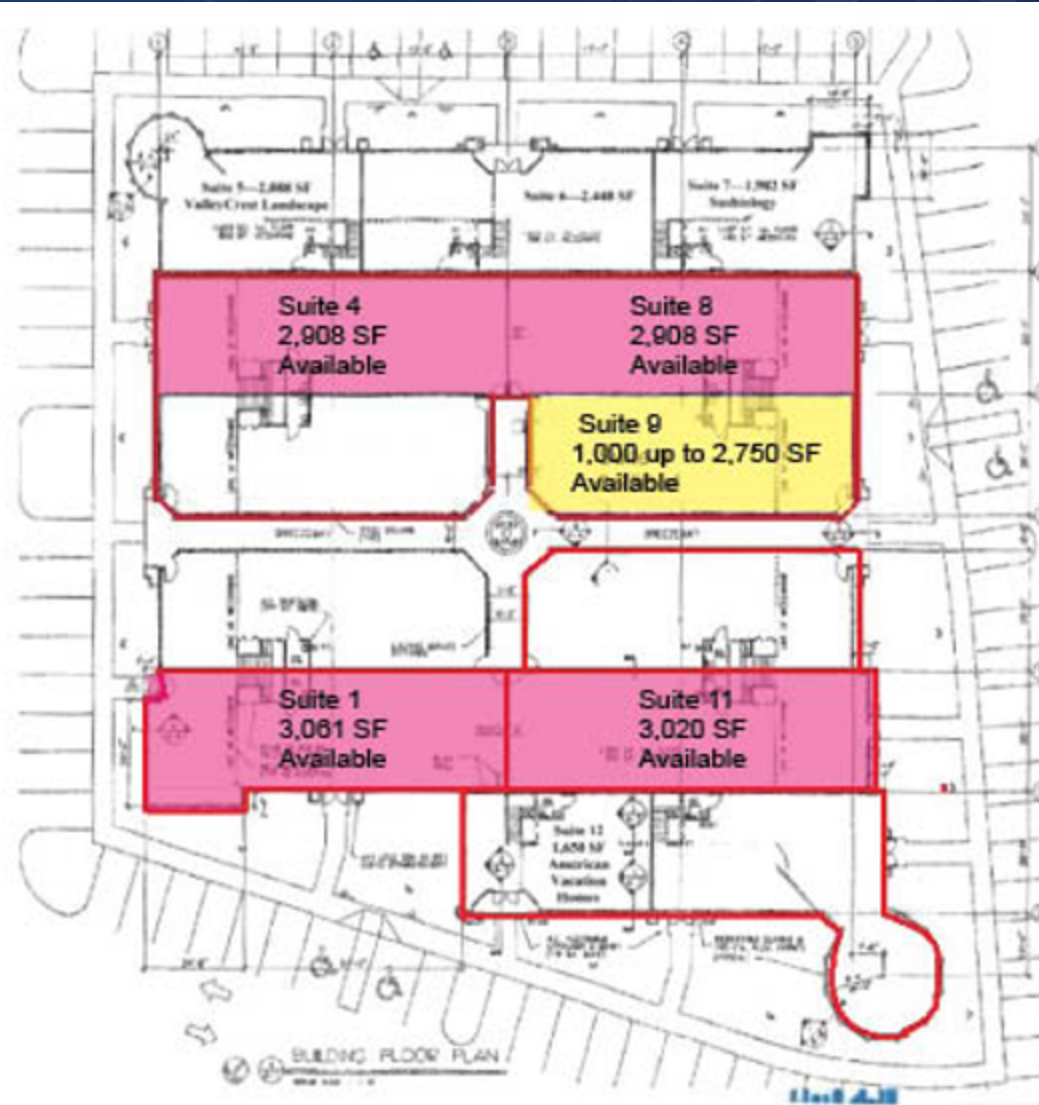

Nick Barbato
407.573.0711 x309
nbarbato@eisre.com

Ryan D'Agostino
407.573.0711 x312
rdagostino@eisre.com



7575 Dr. Phillips Blvd, Ste 390
Orlando, FL 32819
www.eisre.com

Regency Village

12211 Regency Village Drive, Orlando, FL 32821



EQUITY
INVESTMENT
SERVICES

RETAILER MAP



Map data ©2020 Imagery ©2020, Lake County, Maxar Technologies, U.S. Geological Survey

Nick Barbato
407.573.0711 x309
nbarbato@eisre.com

Ryan D'Agostino
407.573.0711 x312
rdagostino@eisre.com



7575 Dr. Phillips Blvd, Ste 390
Orlando, FL 32819
www.eisre.com

Regency Village

12211 Regency Village Drive, Orlando, FL 32821



EQUITY
INVESTMENT
SERVICES

DEMOGRAPHICS MAP & REPORT

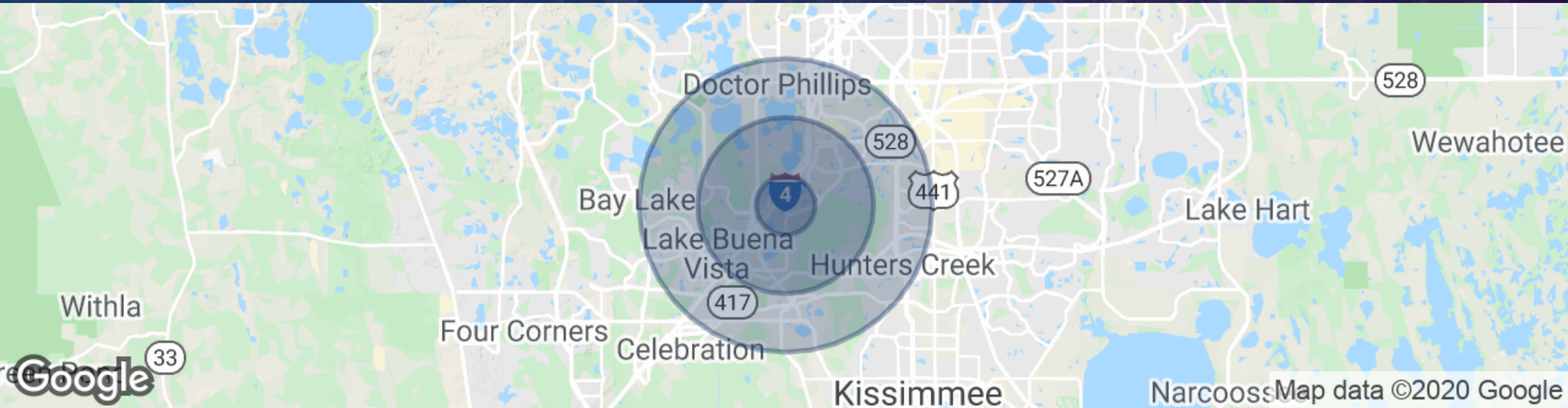

POPULATION

	1 MILE	3 MILES	5 MILES
Total population	2,954	26,091	72,731
Median age	33.5	36.2	36.3
Median age (Male)	34.5	36.5	35.9
Median age (Female)	32.9	36.4	37.2

HOUSEHOLDS & INCOME

	1 MILE	3 MILES	5 MILES
Total households	1,186	10,076	26,832
# of persons per HH	2.5	2.6	2.7
Average HH income	\$80,986	\$87,444	\$85,057
Average house value	\$502,175	\$438,018	\$437,640

* Demographic data derived from 2010 US Census

Nick Barbato
407.573.0711 x309
nbarbato@eisre.com

Ryan D'Agostino
407.573.0711 x312
rdagostino@eisre.com



7575 Dr. Phillips Blvd, Ste 390
Orlando, FL 32819
www.eisre.com