



# 595 Lakeview Pkwy, Vernon Hills, IL

AVAILABLE | 14,764 - 65,707 SF



Unit	A	B	B & D	C	C & D
Size	14,764 SF	25,687 SF	34,300 SF	16,644 SF	25,256 SF
Office	5,184 SF	11,041 SF	11,041 SF	4,257 SF	4,257 SF

**Clear Height:** 24'  
**Parking:** 116 cars  
**Loading:** 5 interior docks (shared)  
 5 drive-in-doors

**Asking Lease Rate: \$7.50 PSF Net**

**Eric Fischer**  
 Managing Director  
 +1 847 720 1369  
 eric.fischer@cushwake.com

**Marc Samuels**  
 Associate  
 +1 847 720 1368  
 marc.samuels@cushwake.com

**Brett Kroner**  
 Executive Director  
 +1 847 720 1367  
 brett.kroner@cushwake.com

**Keith Puritz**  
 Executive Director  
 +1 847 720 1366  
 keith.puritz@cushwake.com

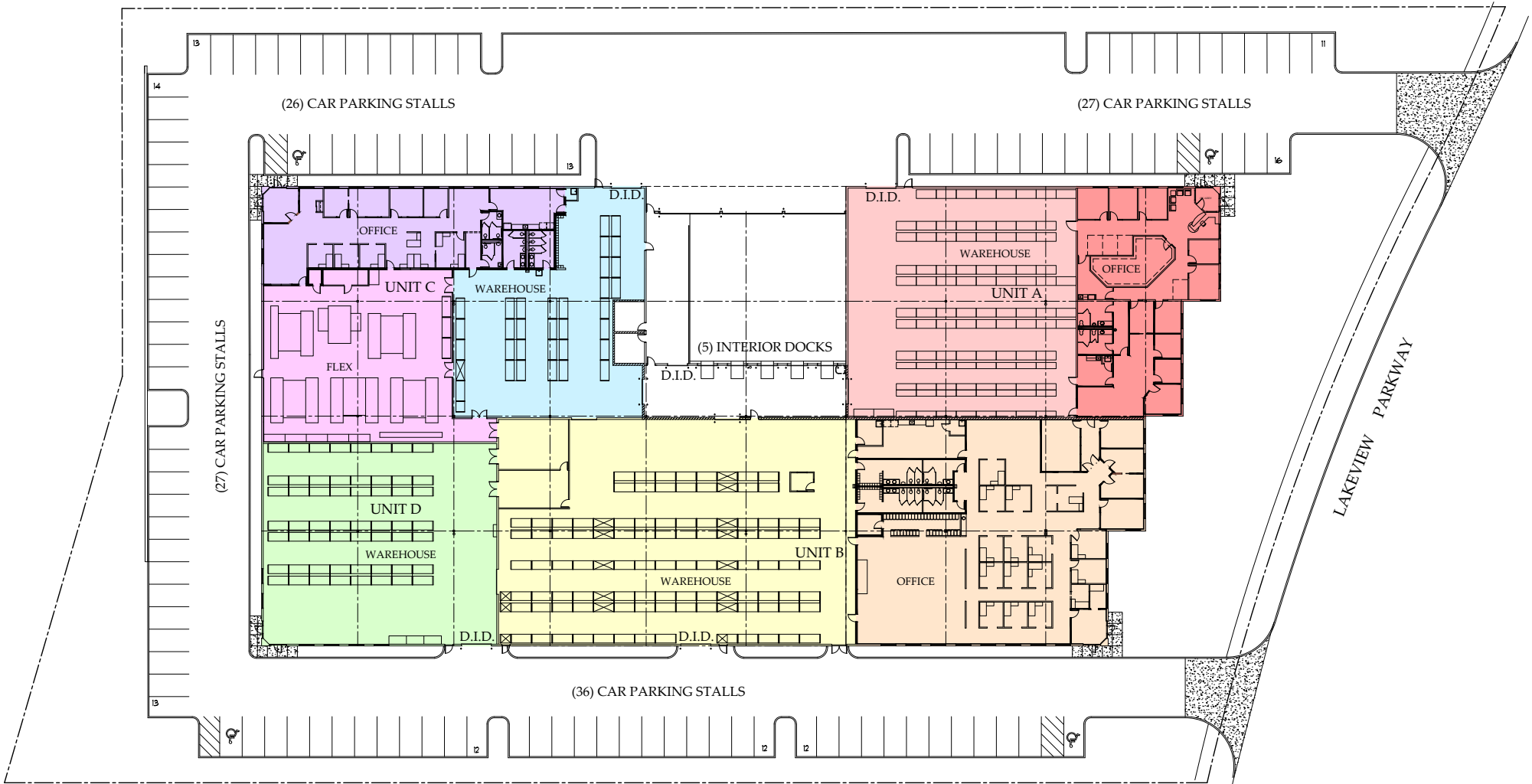

**Eric Fischer**  
 Managing Director  
 +1 847 720 1369  
 eric.fischer@cushwake.com

**Marc Samuels**  
 Associate  
 +1 847 720 1368  
 marc.samuels@cushwake.com

**Brett Kroner**  
 Executive Director  
 +1 847 720 1367  
 brett.kroner@cushwake.com

**Keith Puritz**  
 Executive Director  
 +1 847 720 1366  
 keith.puritz@cushwake.com



**Eric Fischer**  
 Managing Director  
 +1 847 720 1369  
 eric.fischer@cushwake.com

**Marc Samuels**  
 Associate  
 +1 847 720 1368  
 marc.samuels@cushwake.com

**Brett Kroner**  
 Executive Director  
 +1 847 720 1367  
 brett.kroner@cushwake.com

**Keith Puritz**  
 Executive Director  
 +1 847 720 1366  
 keith.puritz@cushwake.com