

LABORATORY / INDUSTRIAL FOR LEASE



±10,000 Square Feet Building on ±15,000 Square Foot Lot

1307

66TH STREET
EMERYVILLE



**Newmark
Knight Frank**

Exclusive Brokers

James Bohar

jbohar@newmarkccarey.com
CA RE License #00803991

Tom Southern

tsouthern@newmarkccarey.com
CA RE License #01808807

ABOUT PROPERTY

Building Features

- ±1000 SF Administration Offices
- Additional Engineering Office Area
- Zoning: I-L Light Industrial
- Permitted Uses: Laboratory, Light Industrial
- ±14.5' Clear Height
- 400 Amps 120/240 Volt 3 Phase Power
- 1" Gas Line (tenant to verify service)
- Floor Drain
- Two Bathrooms
- Concrete Tilt Up Construction
- One Grade Level Roll Up Door
- Large Parking Lot
(15 cars as currently configured)

Please do not disturb current tenant

RENT RATE: \$1.75/SF Modified Net

AVAILABLE: JUNE 1, 2018

AMENITIES MAP

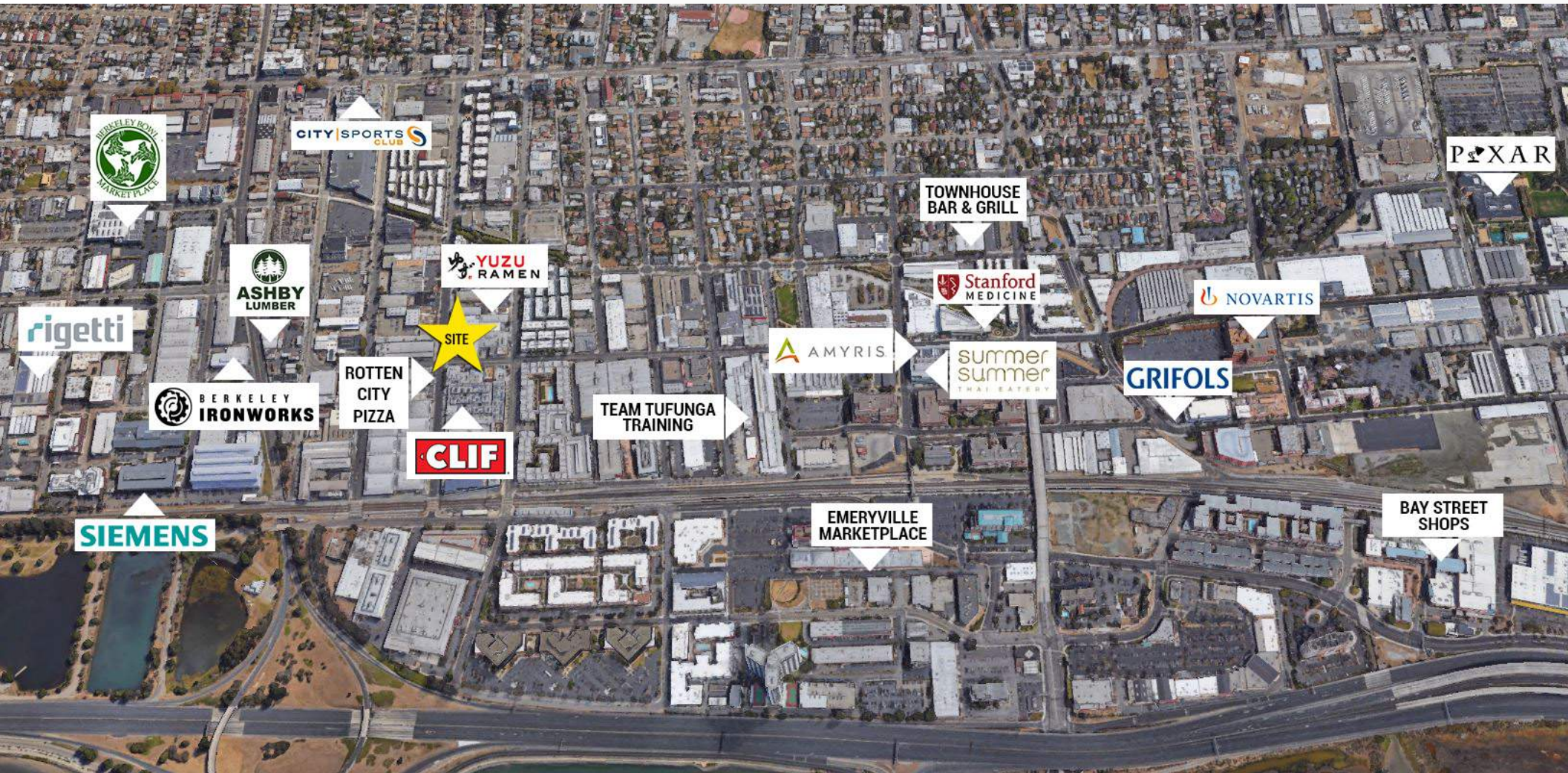

FLOORPLAN

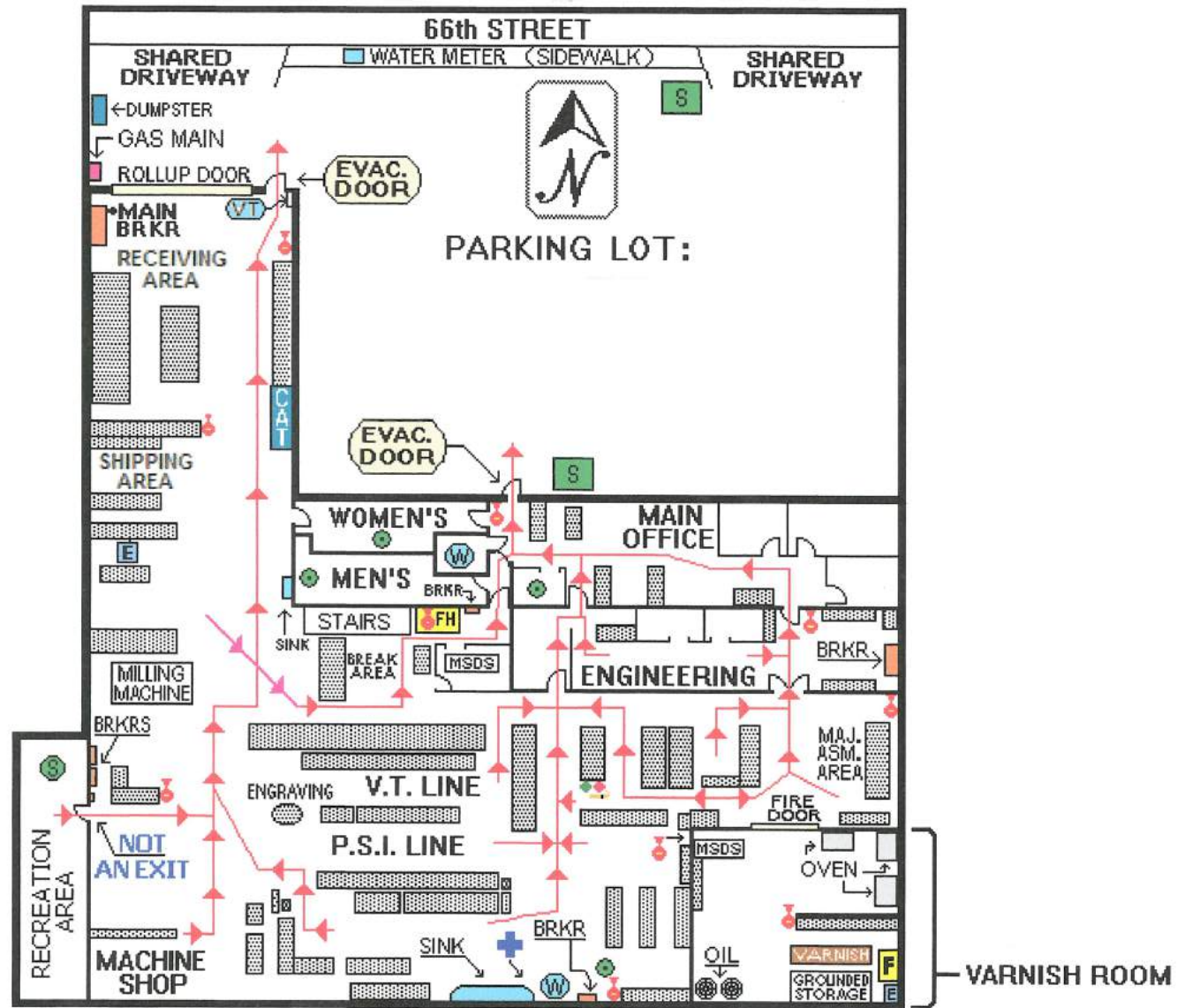

PROPERTY PHOTOS



1307 66th Street, Emeryville, CA



Exclusive Brokers

James Bohar
510.923.6201
jbohar@newmarkccarey.com
CA RE License #00803991

Tom Southern
510.923.9158
tsouthern@newmarkccarey.com
CA RE License #01808807

This Information is Confidential

This Confidential Offering Memorandum is being provided on behalf of the Seller by Newmark Cornish & Carey, ("the Listing Agent") to a limited number of parties who may be interested in a transaction involving 1549 Shattuck Avenue, Berkeley, California (the "Property"). This Confidential Offering Memorandum does not purport to be all-inclusive or to necessarily contain all the information that a prospective Buyer may desire in investigating the Property. This Confidential Offering Memorandum has been prepared for informational purpose relating to this transaction only and upon the expressed understanding that it will be used for only the purposes set forth above. Any projections or similar materials should be considered hypothetical only, and no assurance can be given as to the accuracy of assumptions or the predictability of any given result or outcome. Any purchase must be based upon the prospective Buyer's own investigations and not upon any information contained herein. Such investigations shall be at the prospective Buyer's own risk. Newmark Cornish & Carey and the Sellers make no express or implied representation or warranty as to the accuracy or completeness of the information contained herein or made available in connection with any further investigation of the Property. Newmark Cornish & Carey and the Sellers expressly disclaim any and all liability that may be based on such information, errors therein or omissions therefore.

Disclaimer

The information contained herein has been obtained from sources deemed reliable but has not been verified and no guarantee, warranty or representation, either express or implied, is made with respect to such information. Terms of sale or lease and availability are subject to change or withdrawal without notice.