



2390 Bering: ±7,684 SF | Available Now
2249 Zanker: ±15,775 SF | Available Now

HIGHLIGHTS

- Monument Signage Available
- New Exterior Facade Upgrades Recently Completed
- Attractive Campus Environment with Ample Surface Parking (±3.56/1,000)
- 2390 Bering - 200 Amps @ 480V
- 2249 Zanker - 600 Amps @ 480V
- Grade Level Loading
- Highly Desirable Golden Triangle Location
- Close Proximity to 101, 880 and 87
- Minutes from San Jose International Airport and Downtown San Jose
- Walking Distance to Light Rail Station
- Short Walk to Restaurants and Retail Amenities



Jon DeCoite
Senior Director
+1 408 615 3408
jon.decoite@cushwake.com
LIC #01471300

Alan Guterman
Senior Director
+1 408 615 3414
alan.guterman@cushwake.com
LIC #00884495

Kelly Yoder
Director
+1 408 615 3427
kelly.yoder@cushwake.com
LIC #00182117

Steve Horton
Executive Vice Chairman
+1 408 615 3412
steve.horton@cushwake.com
LIC #01127340



SITE PLAN

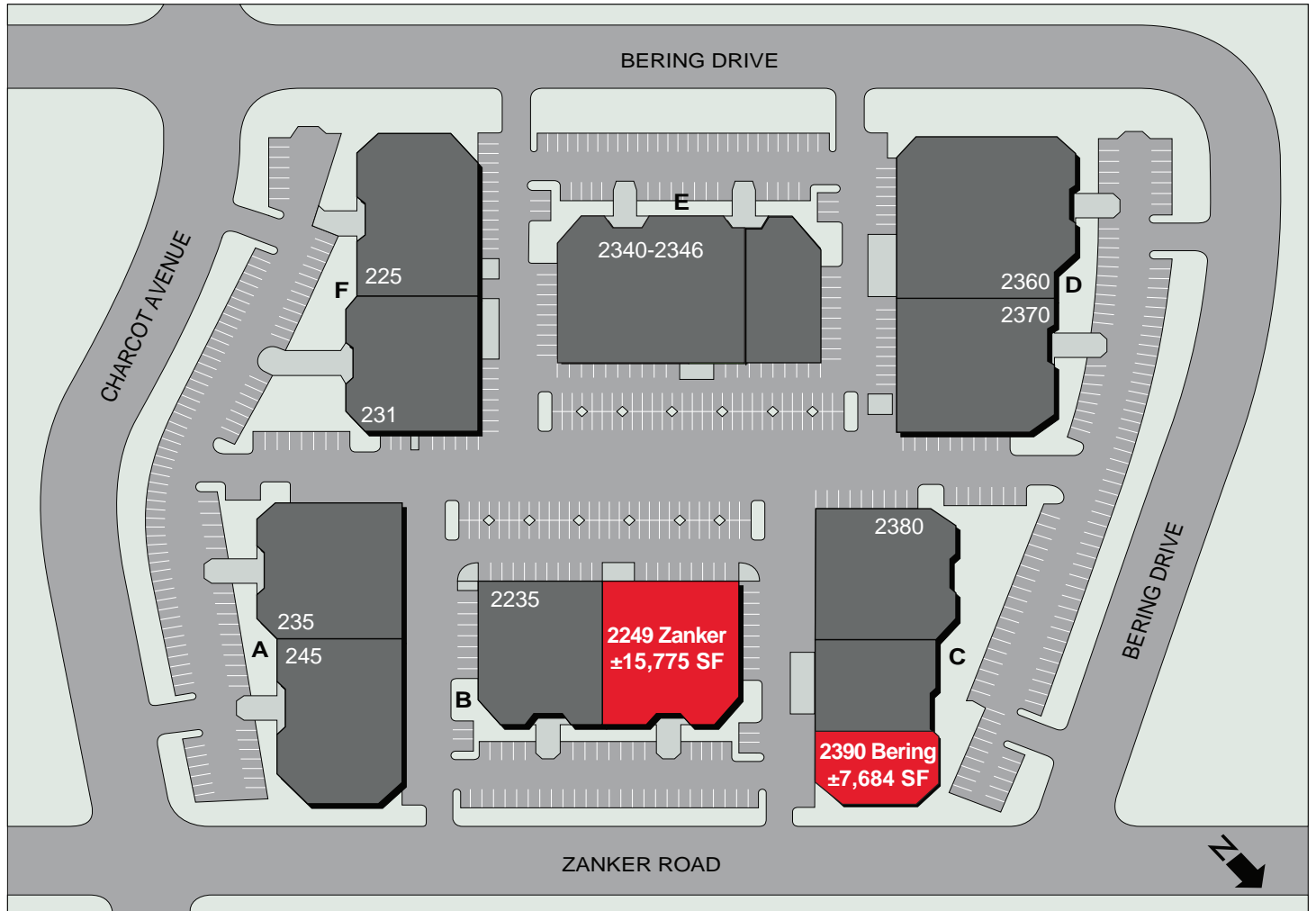

Jon DeCoite
 Senior Director
 +1 408 615 3408
 jon.decoite@cushwake.com
 LIC #01471300

Alan Guterman
 Senior Director
 +1 408 615 3414
 alan.guterman@cushwake.com
 LIC #00884495

Kelly Yoder
 Director
 +1 408 615 3427
 kelly.yoder@cushwake.com
 LIC #00182117

Steve Horton
 Executive Vice Chairman
 +1 408 615 3412
 steve.horton@cushwake.com
 LIC #01127340



2390 Bering Drive: ±7,684 SF

FLOOR PLAN

- 6 Offices
- 3 Conference Rooms
- Training Room
- Shipping/Receiving
- Lab
- Break Room
- Grade Level Loading

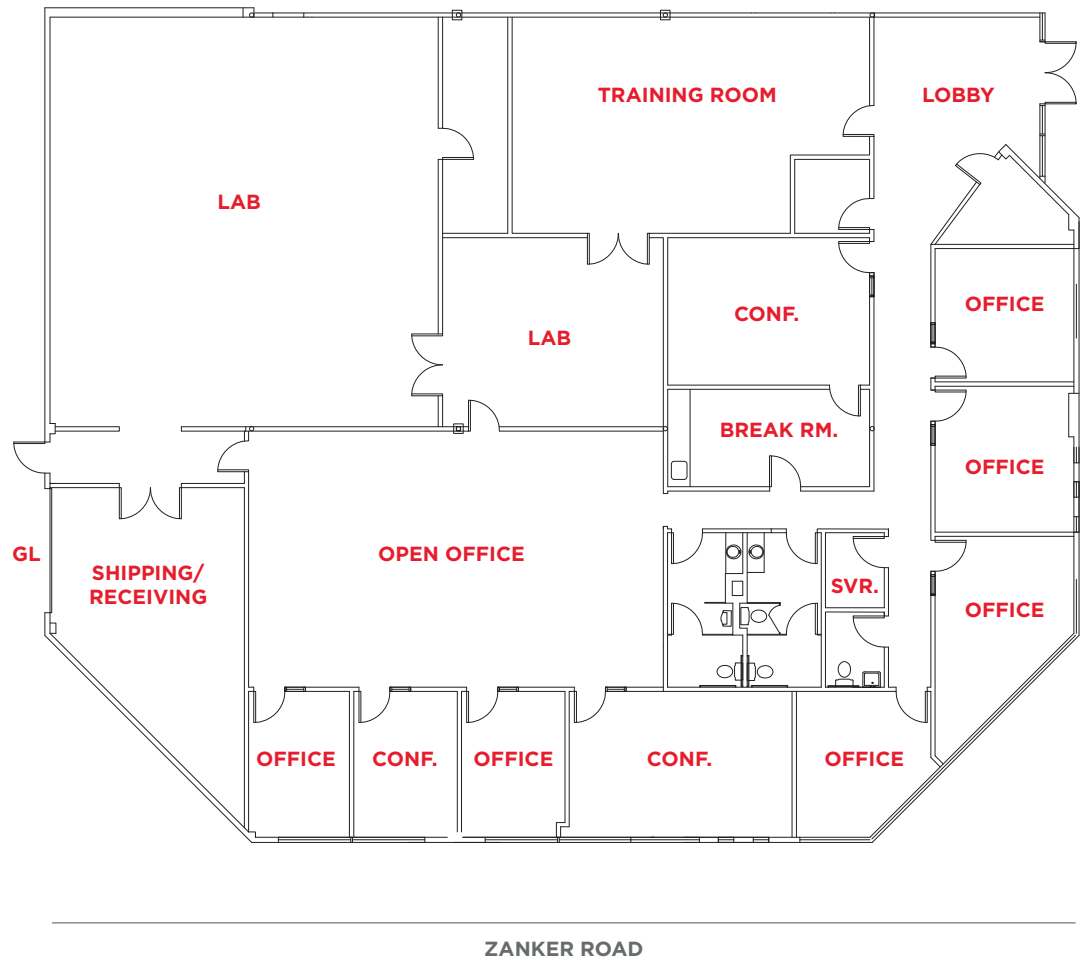

Jon DeCoite
Senior Director
+1 408 615 3408
jon.decoite@cushwake.com
LIC #01471300

Alan Guterman
Senior Director
+1 408 615 3414
alan.guterman@cushwake.com
LIC #00884495

Kelly Yoder
Director
+1 408 615 3427
kelly.yoder@cushwake.com
LIC #001821117

Steve Horton
Executive Vice Chairman
+1 408 615 3412
steve.horton@cushwake.com
LIC #01127340



2249 Zanker Road: ±15,775 SF

FLOOR PLAN

- 3 Offices
- 3 Conference Rooms
- 4 Labs
- Break Room
- Potential Grade Level Loading

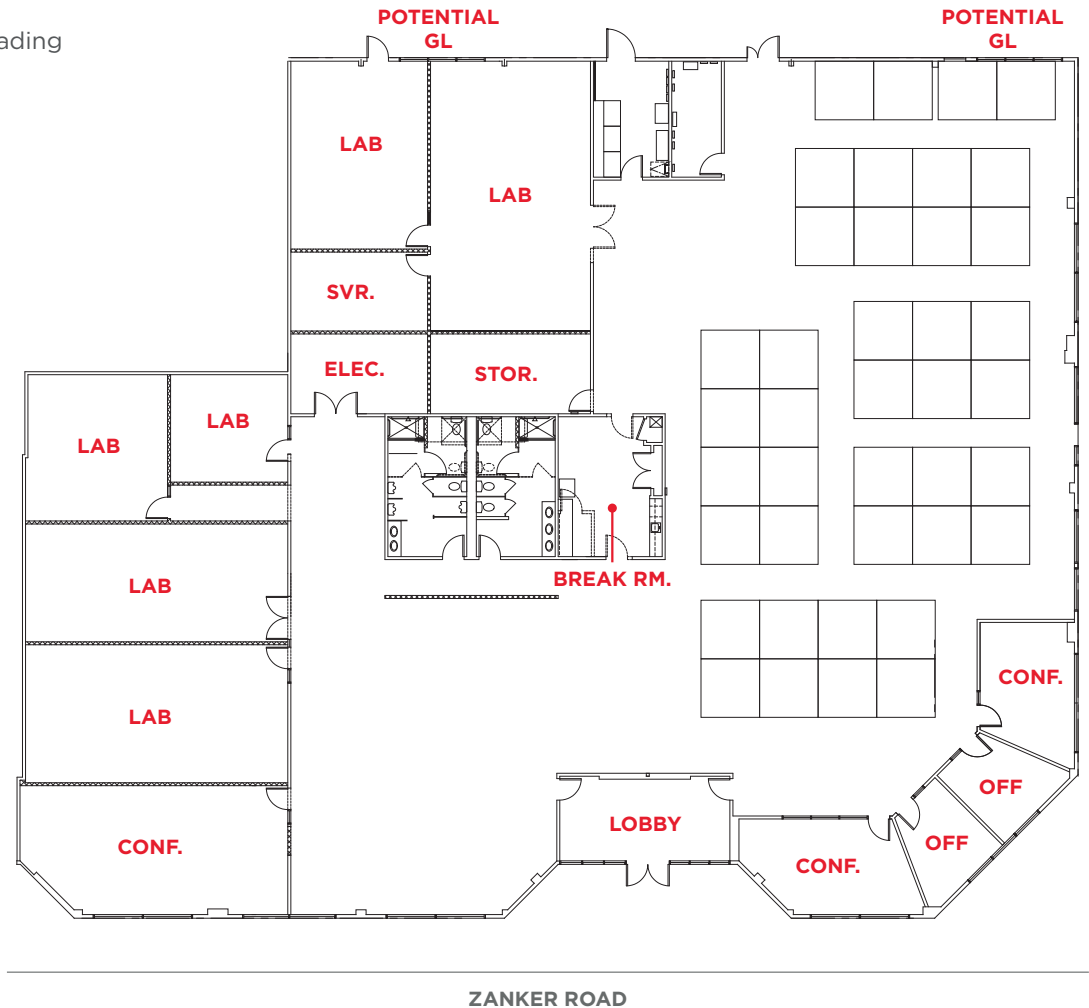

Jon DeCoite
Senior Director
+1 408 615 3408
jon.decoite@cushwake.com
LIC #01471300

Alan Guterman
Senior Director
+1 408 615 3414
alan.guterman@cushwake.com
LIC #00884495

Kelly Yoder
Director
+1 408 615 3427
kelly.yoder@cushwake.com
LIC #001821117

Steve Horton
Executive Vice Chairman
+1 408 615 3412
steve.horton@cushwake.com
LIC #01127340



AMENITIES



Jon DeCoite
Senior Director
+1 408 615 3408
jon.decoite@cushwake.com
LIC #01471300

Alan Guterman
Senior Director
+1 408 615 3414
alan.guterman@cushwake.com
LIC #00884495

Kelly Yoder
Director
+1 408 615 3427
kelly.yoder@cushwake.com
LIC #00182117

Steve Horton
Executive Vice Chairman
+1 408 615 3412
steve.horton@cushwake.com
LIC #01127340

