

245 N. BEVERLY DRIVE

BEVERLY HILLS
RETAIL FOR LEASE



KAZUKO Y. MORGAN

Vice Chairman
T 415.773.3546
Lic. 01070005
kazuko.morgan@cushwake.com

CARINE MAMANN

Senior Director
T 310.595.2235
Lic. 01734150
carine.mamann@cushwake.com

MATTHEW FAINCHEIN

Senior Director
T. 310.595.2234
Lic. 01503546
matthew.fainchtein@cushwake.com

CARTER MAGNIN

Senior Associate
T. 310.595.2203
Lic. 01909728
carter.magnin@cushwake.com

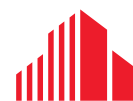

**CUSHMAN &
WAKEFIELD**

10250 Constellation Blvd.
Suite 2200
Los Angeles, CA 90067
www.cushmanwakefield.com



PREMISES

245 N. Beverly Drive features over ±23,000 square feet of space available in a stunning, Class-A, contemporary development which is also home to the world-famous MGM Studios headquarters.

Positioned on North Beverly Drive within the luxurious Beverly Hills Golden Triangle, 245 N. Beverly Drive offers prime exposure to retailers and restaurants in a highly coveted and rarely available shopping destination.

RETAIL

Retail suites are available immediately. Available spaces range from ±1,004 SF to ±4,874 SF, with frontage on North Beverly Drive or Dayton Way. Spaces can also be combined.

SUITE 265	±4,001	SF
SUITE 255	±4,874	SF
SUITE 253	±1,758	SF
SUITE 251	±2,030	SF
SUITE 235	±1,004	SF
SUITE 9456	±1,825	SF
SUITE 9458	±1,765	SF

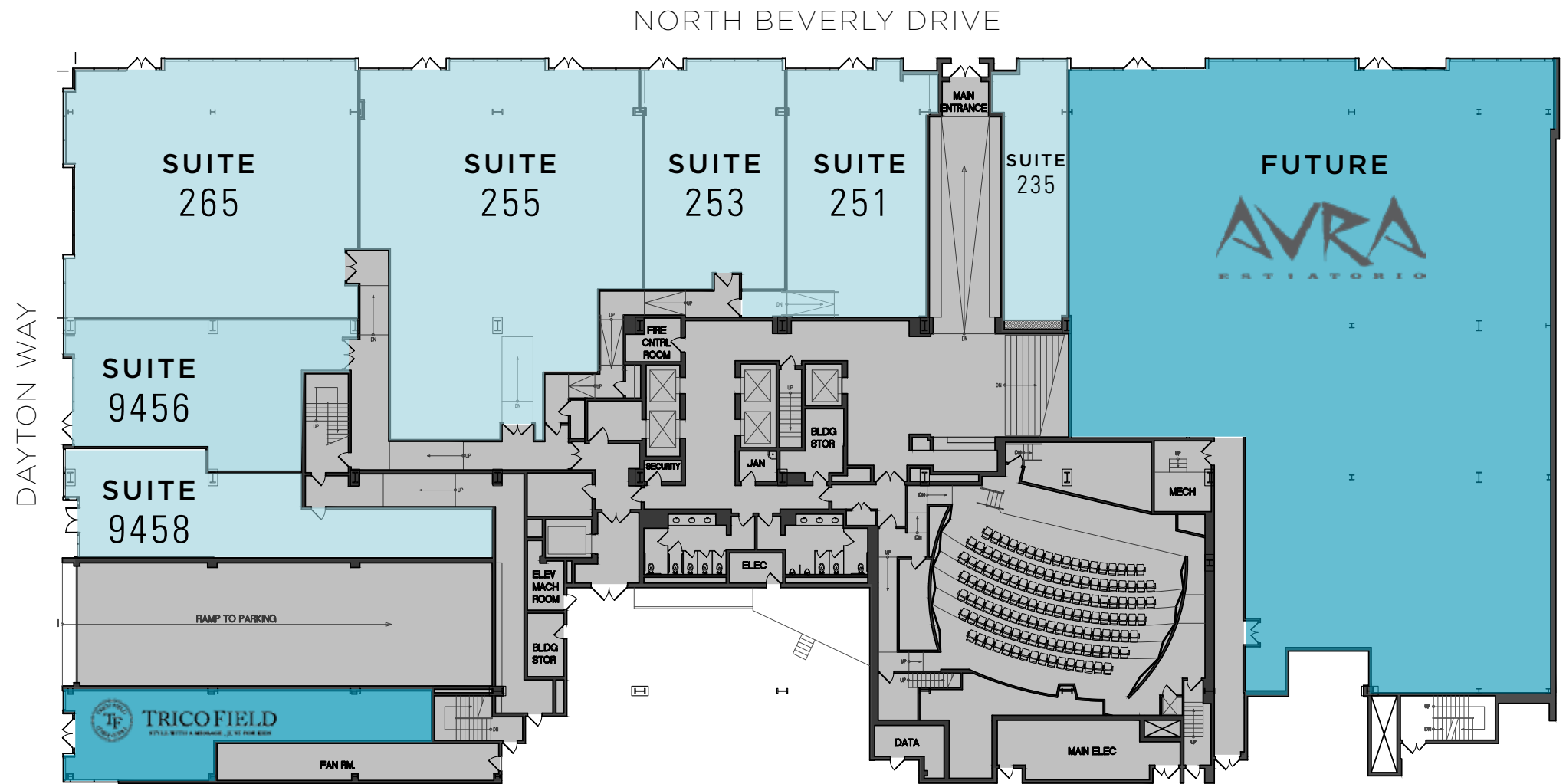

AVAILABLE LEASED



BEVERLY HILLS

Beverly Hills is the internationally renowned retail destination frequented by over 6 million visitors annually. 245 N. Beverly is adjacent to Two Rodeo, the most iconic and unique shopping center in all of Beverly Hills.

Home to luxury retailers such as Versace, Jimmy Choo, Tiffany & Co., Stefano Ricci, Buccellati, and CH Carolina Herrera, the complex alone draws record numbers of international and domestic tourist traffic on Rodeo Drive and Dayton Way. 245 N. Beverly Drive is within steps of the exquisite Beverly Wilshire and Montage Hotels, which host elite visitors and celebrities year round.

NEIGHBORING RETAILERS



245

NORTH BEVERLYDRIVE

EXCLUSIVE LISTING AGENTS

KAZUKO Y. MORGAN

Vice Chairman

T 415.773.3546

Lic. 01070005

kazuko.morgan@cushwake.com

MATTHEW FAINCHEIN

Senior Director

T. 310.595.2234

Lic. 01503546

matthew.fainchtein@cushwake.com

CARINE MAMANN

Senior Director

T 310.595.2235

Lic. 01734150

carine.mamann@cushwake.com

CARTER MAGNIN

Senior Associate

T. 310.595.2203

Lic. 01909728

carter.magnin@cushwake.com



**CUSHMAN &
WAKEFIELD**

10250 Constellation Blvd., Suite 2200

Los Angeles, CA 90067

www.cushmanwakefield.com