

OFFICES FOR LEASE

CENTENNIAL PLACE
1684 Plum Lane, Redlands, CA



CHARTING THE RIGHT COURSE FOR YOUR BUSINESS

LOCATION:

- Immediate access to the I-10 and I-215
- Located in the heart of Redlands
- Excellent proximity to restaurants and shopping

DYNAMIC OFFICE SPACE:

- Highest quality small Class "A" buildings
- Fully built out space with highest quality improvements
- Customer friendly 4:1,000 parking ratio
- Heavily landscaped campus environment

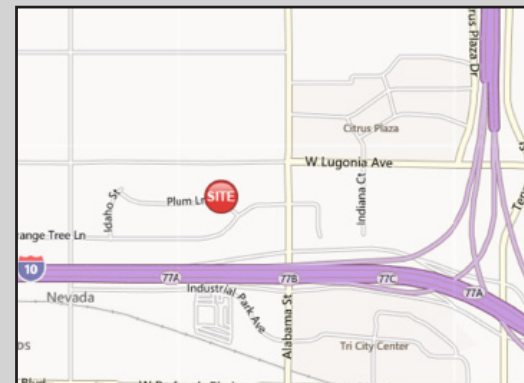

For Further Information, Please Contact:

Thomas P. Pierik, SIOR | 951.276.3610
tpierik@lee-associates.com | License ID# 00982027

David G. Mudge, CCIM, SIOR | 951.276.3611
dmudge@lee-associates.com | License ID# 01070762

www.lee-associates.com

OFFICES FOR LEASE



CENTENNIAL PLACE
1684 Plum Lane, Redlands, CA

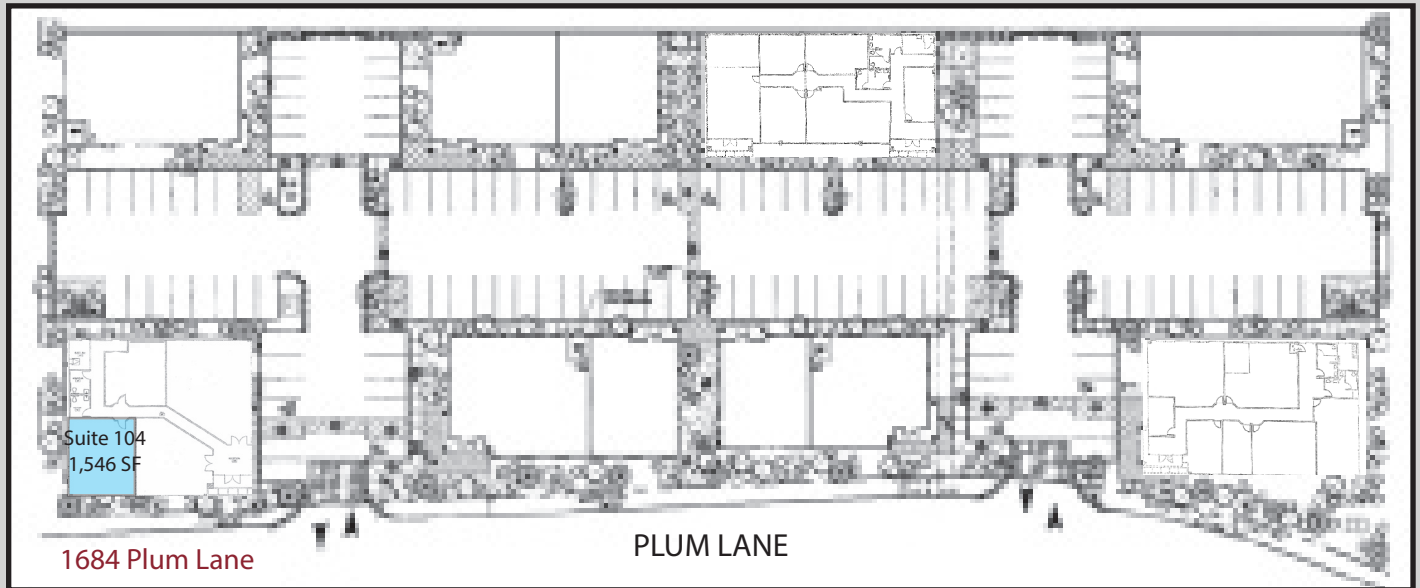

AVAILABILITY

1684 Plum Lane

<u>Suite</u>	<u>Square Feet</u>	<u>Lease Rate</u>
104	1,546 SF	\$2,087 per month

Tenant Pays Own Interior Janitorial Charges

For Further Information, Please Contact:

Thomas P. Pierik, SIOR | 951.276.3610
tpierik@lee-associates.com | License ID# 00982027

David G. Mudge, CCIM, SIOR | 951.276.3611
dmudge@lee-associates.com | License ID# 01070762

www.lee-associates.com