

**PRICE REDUCED**

**Available**



## 121-125 S. Sullivan Road

Spokane Valley, Washington 99037

### Property Features

- Space Available:
  - Suite 121: 1,600 SF ±
- Lot Size: 9,750 SF ±
- Great Frontage on Sullivan Road
- Neighboring Businesses:
  - Walgreens
  - Fred Meyer
  - MUV Fitness
  - US Bank

**Lease Rate: \$12.00/ SF NNN**

(NNN's Estimated at \$2.50/SF)

For more information, contact:

**Drew Ulrick**

+1 509 622 3562 • [dulrick@naiblack.com](mailto:dulrick@naiblack.com)

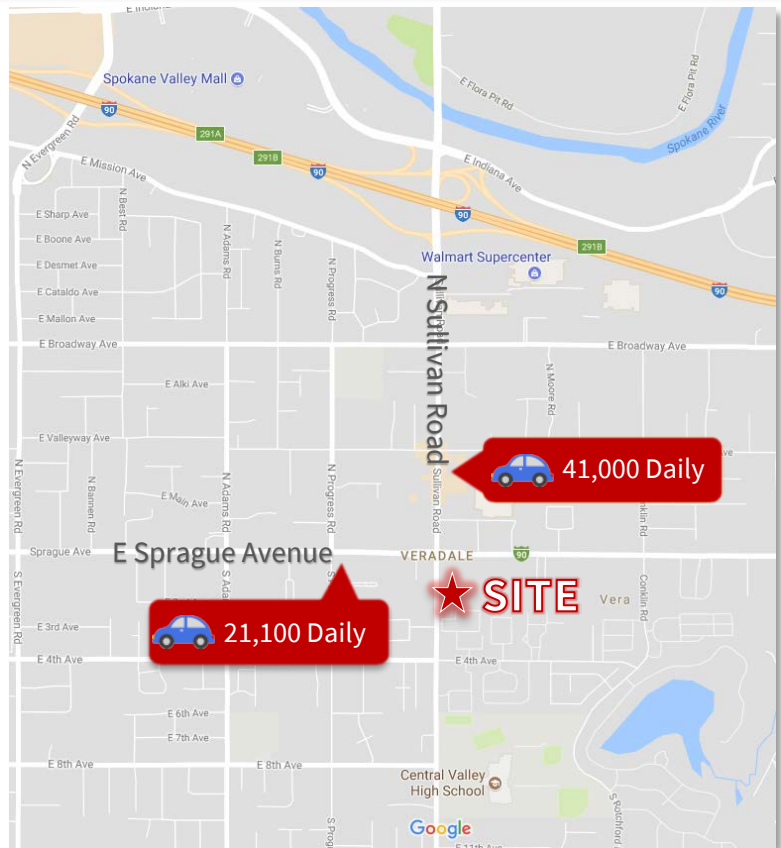

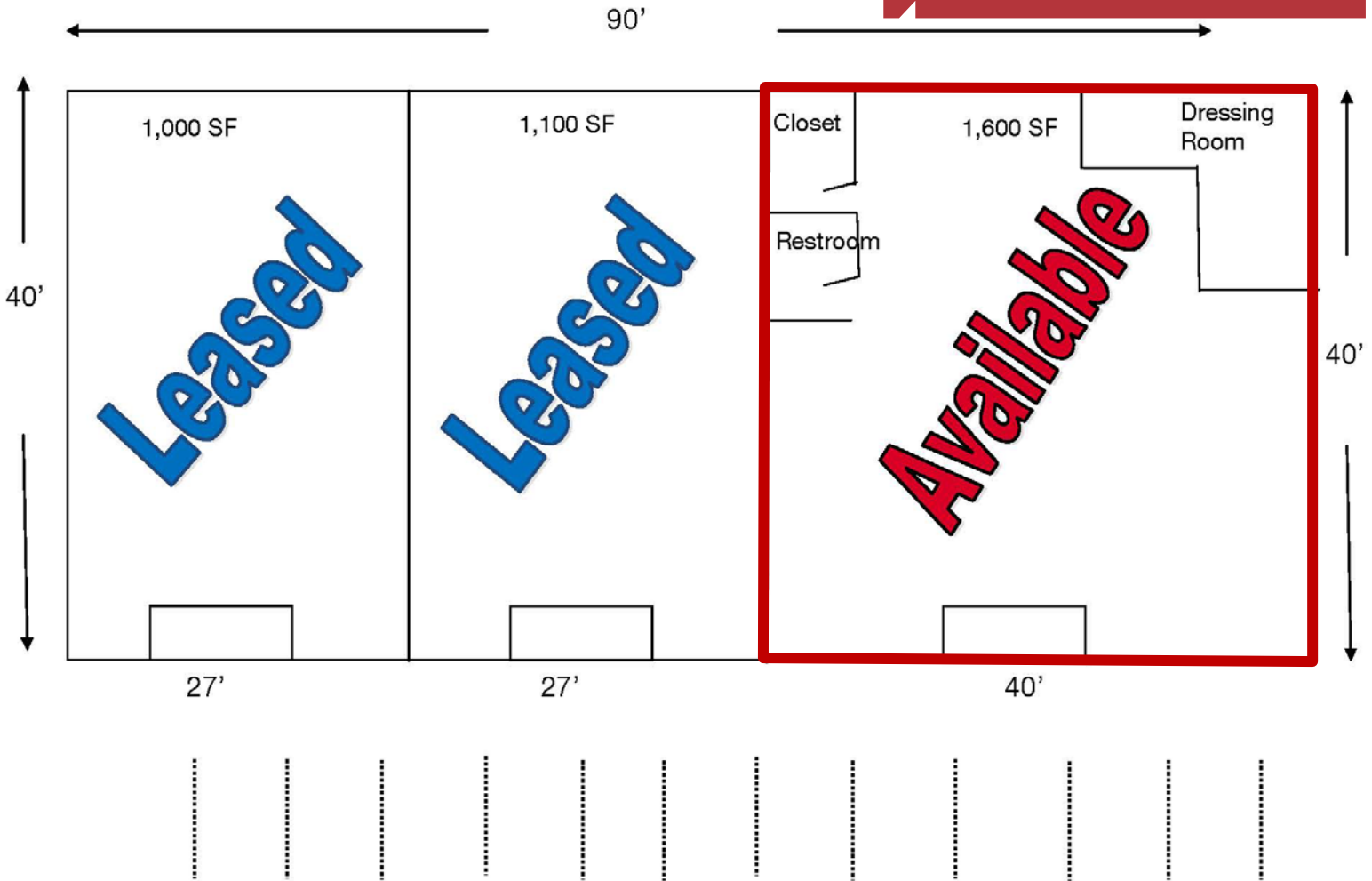

NO WARRANTY OR REPRESENTATION, EXPRESS OR IMPLIED, IS MADE AS TO THE ACCURACY OF THE INFORMATION CONTAINED HEREIN, AND THE SAME IS SUBMITTED SUBJECT TO ERRORS, OMISSIONS, CHANGE OF PRICE, RENTAL OR OTHER CONDITIONS, PRIOR SALE, LEASE OR FINANCING, OR WITHDRAWAL WITHOUT NOTICE, AND OF ANY SPECIAL LISTING CONDITIONS IMPOSED BY OUR PRINCIPALS NO WARRANTIES OR REPRESENTATIONS ARE MADE AS TO THE CONDITION OF THE PROPERTY OR ANY HAZARDS CONTAINED THEREIN ARE ANY TO BE IMPLIED.

Black Commercial, Inc.  
801 W Riverside Ave Ste 300  
Spokane, WA 99201  
+1 509 622 3562  
[naiblack.com](http://naiblack.com)



### 2020 Demographics:

Population	1 Mile Radius	10,778
	3 Mile Radius	69,483
	5 Mile Radius	118,599
Median Household Income	1 Mile Radius	\$55,690
	3 Mile Radius	\$57,433
	5 Mile Radius	\$59,726
Average Household Income	1 Mile Radius	\$74,474
	3 Mile Radius	\$75,076
	5 Mile Radius	\$79,498

