

**CBRE**











# 67,622 SF OFFICE BUILDING

1240 SOUTH STATE COLLEGE BOULEVARD ANAHEIM, CA 92806

# 67,622 SF OFFICE BUILDING



## BUILDING FEATURES

-  Walk to Starbucks, In-N-Out, El Torito, Subway, Benihana
-  Building Top Signage Available
-  67,622 SF 2-Story Office Building (Divisible to 10,000 SF)
-  Great Visibility on the Corner of State College and Ball Road
-  On-Site Property Management
-  8 Minutes to Anaheim Commuter Rail (Orange Line)
-  14 Minutes to John Wayne Airport
-  Good Access to 5 / 57 / 22 / 91 Freeways
-  4:1,000 Free Surface Parking Plus Reciprocal Parking

# 67,622 SF OFFICE BUILDING

## FIRST FLOOR

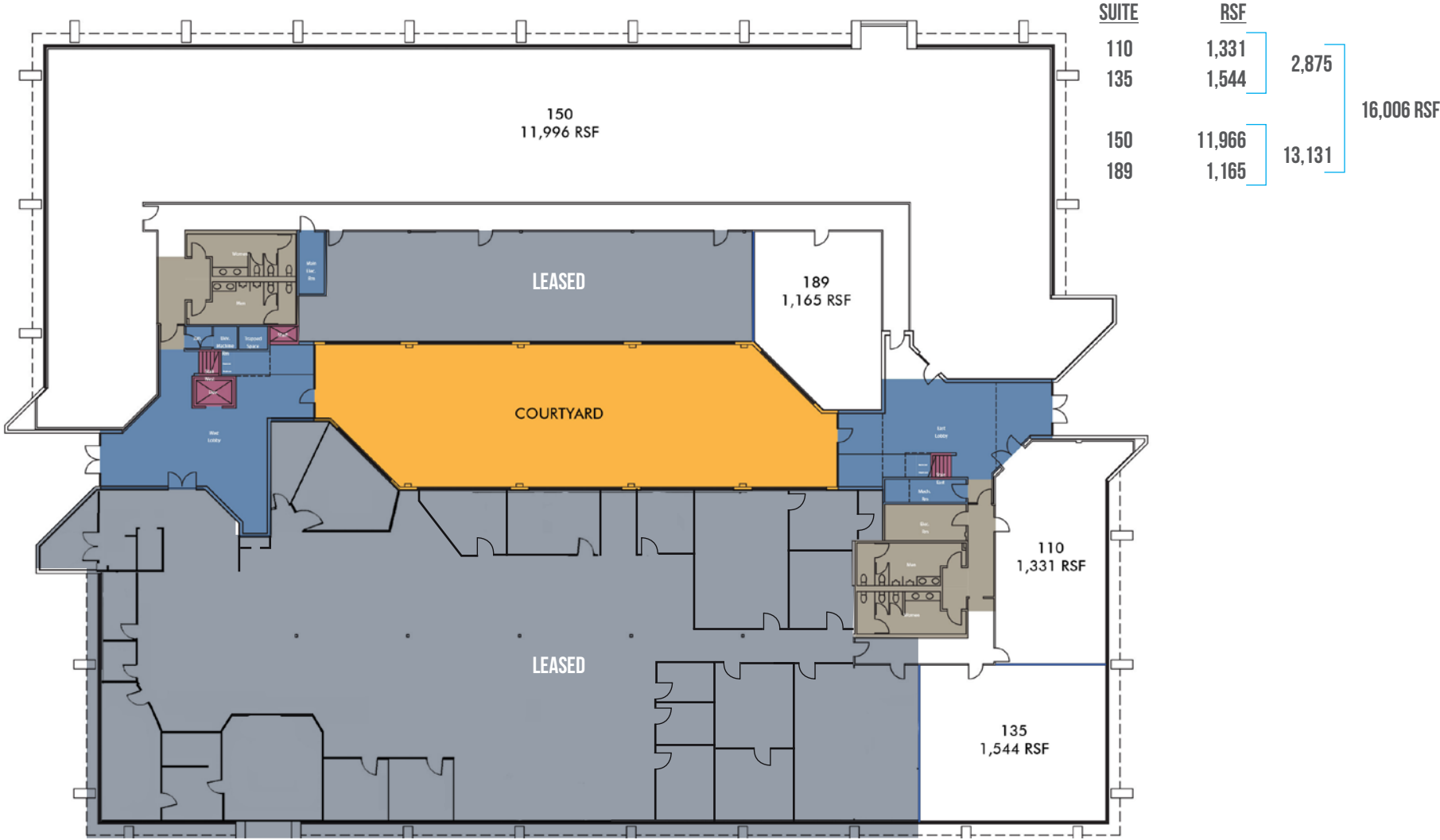

\*MEASUREMENTS ARE ESTIMATES ONLY

# 67,622 SF OFFICE BUILDING

## SECOND FLOOR

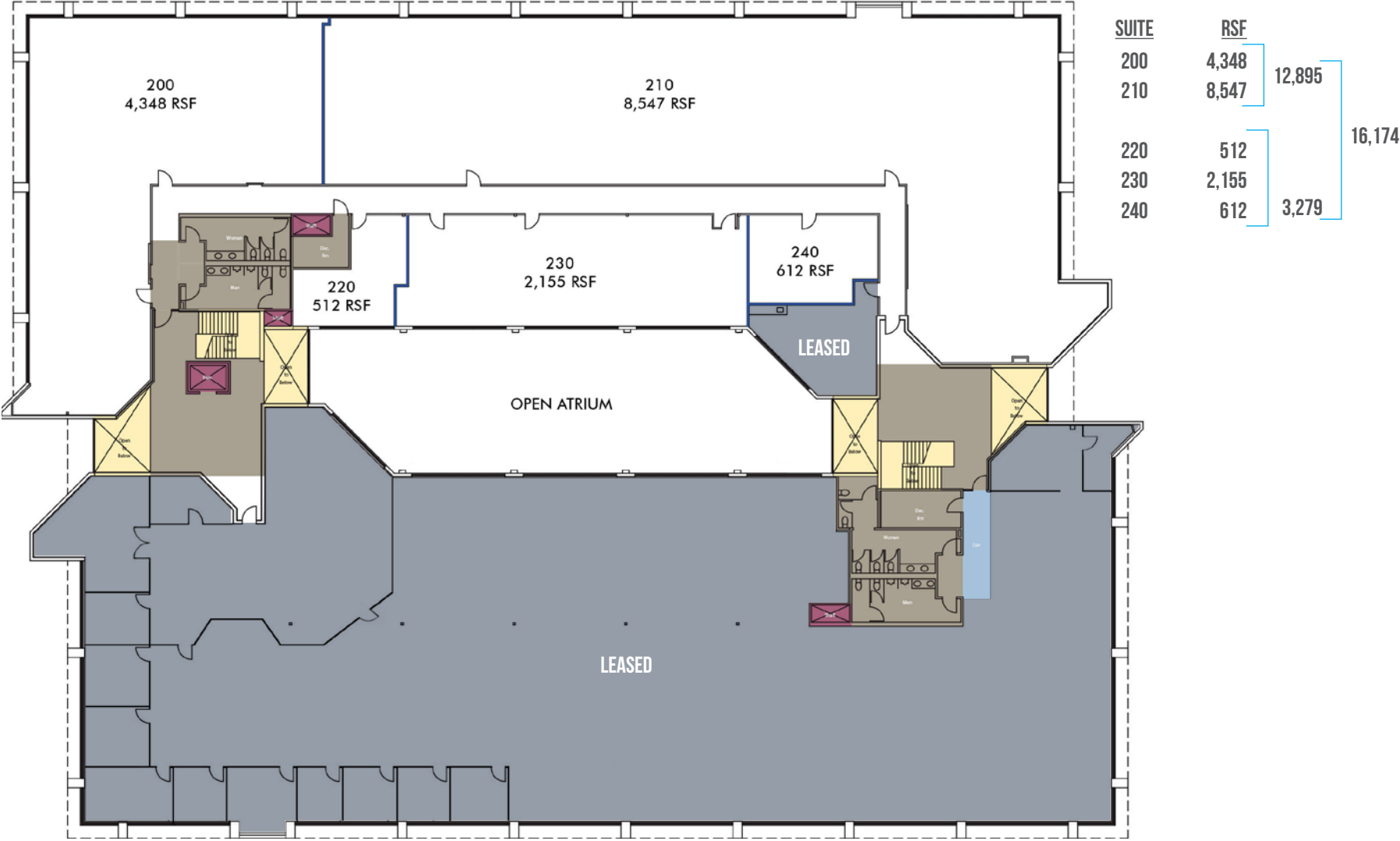

\*MEASUREMENTS ARE ESTIMATES ONLY



**SITE: 1240 S STATE COLLEGE BLVD**  
1. IN N OUT  
2. STARBUCKS  
3. THANH BINH PHO  
4. ALBERTO'S MEXICAN FOOD  
5. SUBWAY  
6. BENIHANA  
7. HAPPY KITCHEN (CHINESE)  
8. EL TORITO

**STARBUCKS - IN-N-OUT - SUBWAY - BENIHANA - EL TORITO AND MORE**

## CONTACT US

**SIMON DILLON**  
Lic. 01010564  
+1 949 725 8668  
simon.dillon@cbre.com

**REID WEAVER**  
Lic. 01995422  
+1 949 725 8688  
reid.weaver@cbre.com

**TAYLOR FRIEND**  
Lic. 01885394  
+1 949 809 4065  
taylor.friend@cbre.com

[www.cbre.com](http://www.cbre.com)



© 2019 CBRE, Inc. All rights reserved. This information has been obtained from sources believed reliable, but has not been verified for accuracy or completeness. Any projections, opinions, or estimates are subject to uncertainty. The information may not represent the current or future performance of the property. You and your advisors should conduct a careful, independent investigation of the property and verify all information. Any reliance on this information is solely at your own risk. CBRE and the CBRE logo are service marks of CBRE, Inc. and/or its affiliated or related companies in the United States and other countries. All other marks displayed on this document are the property of their respective owners. Photos herein are the property of their respective owners and use of these images without the express written consent of the owner is prohibited.