

FOR  
LEASE

# WILSONVILLE BUSINESS CENTER BUILDING 2

9740 SW HILLMAN COURT :: WILSONVILLE, OR 97070

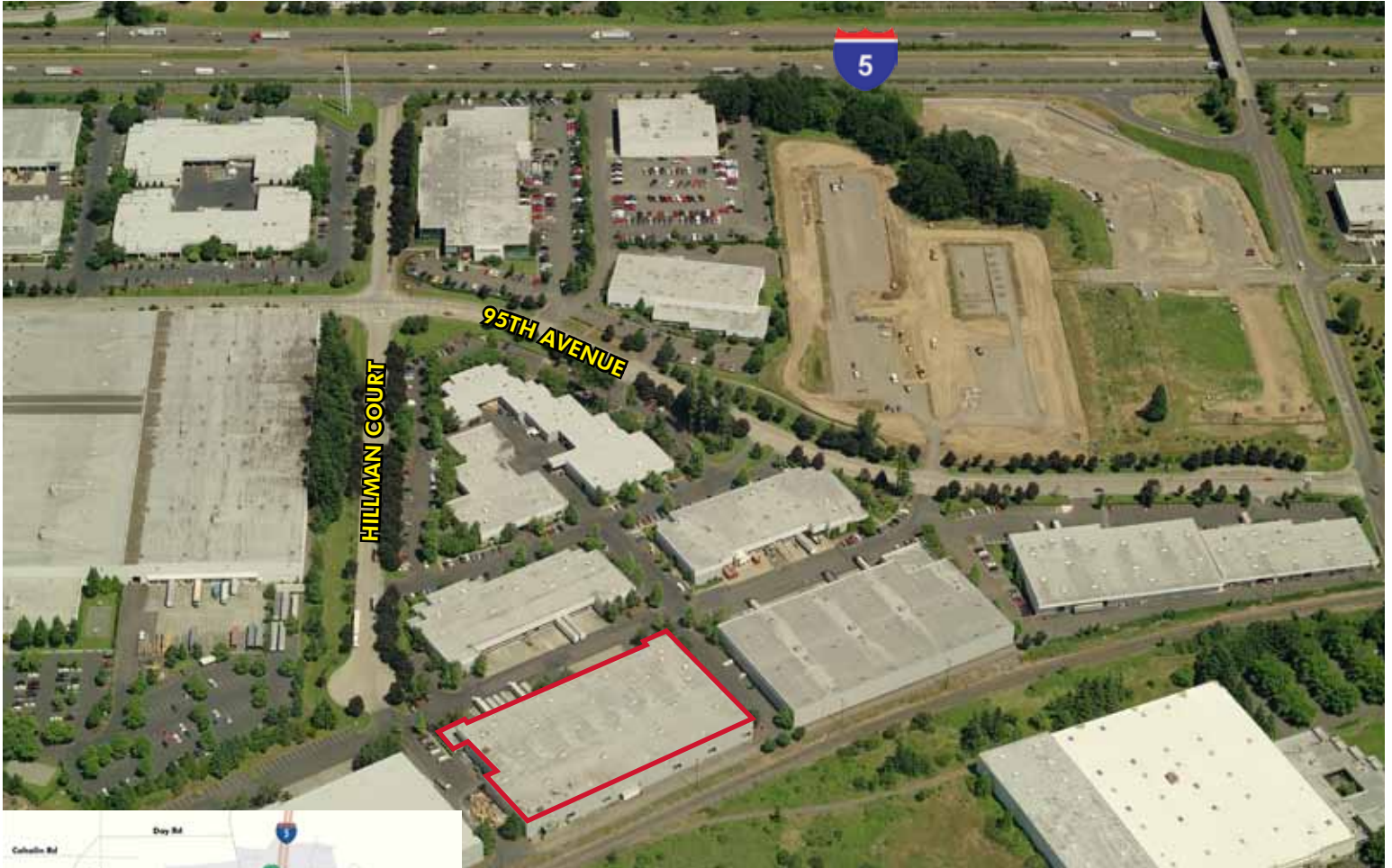

[www.cbre.com/wbc](http://www.cbre.com/wbc)

## FEATURES

- 51,918 SF total
- 2,479 SF office space
- 8 dock doors, 3 grade doors
- 26' clear height
- Column spacing 48'x36'8"
- Parking ratio: 0.7/1,000 SF
- ±1,400 amps, 277/480 volt power
- Sprinklers:  
0.38 Density GPM @ 2,000 SF

## FOR MORE INFORMATION PLEASE CONTACT

**Andy Kangas**

503.221.4874

[andy.kangas@cbre.com](mailto:andy.kangas@cbre.com)

[www.cbre.com/andy.kangas](http://www.cbre.com/andy.kangas)

**Preston C. Greene**

503.221.4887

[preston.greene@cbre.com](mailto:preston.greene@cbre.com)

[www.cbre.com/preston.greene](http://www.cbre.com/preston.greene)

The brokers are licensed in the State of Oregon

**CBRE**

FOR  
LEASE

# WILSONVILLE BUSINESS CENTER - BUILDING 2

9740 SW HILLMAN COURT :: WILSONVILLE, OR 97070

**BUILDING TOTAL**  
**85,032 RSF**  
**AVAILABLE**  
**SPACE**  
**SUITE 200**

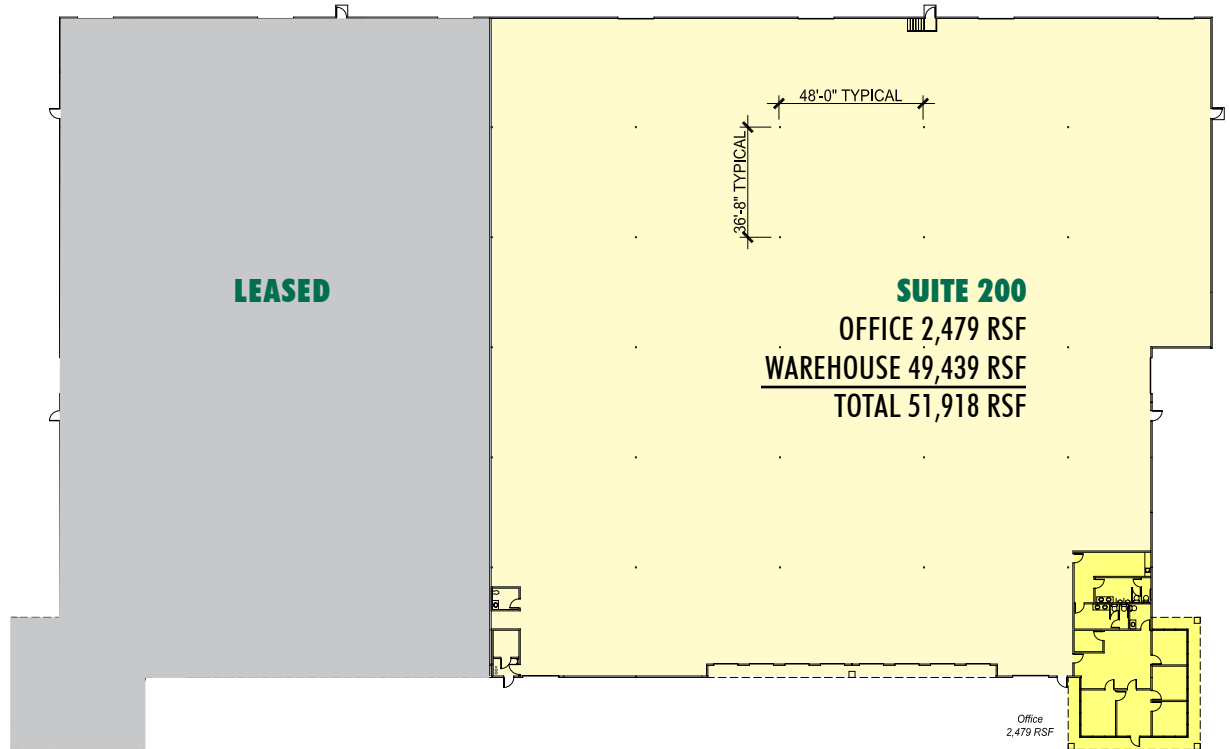

## FOR MORE INFORMATION PLEASE CONTACT

**Andy Kangas**

503.221.4874

andy.kangas@cbre.com

www.cbre.com/andy.kangas

**Preston C. Greene**

503.221.4887

preston.greene@cbre.com

www.cbre.com/preston.greene

CBRE | 1300 SW Fifth Ave. | Suite 3000 | Portland, OR 97201

© 2012 CBRE, Inc. This information has been obtained from sources believed reliable. We have not verified it and make no guarantee, warranty or representation about it. Any projections, opinions, assumptions or estimates used are for example only and do not represent the current or future performance of the property. You and your advisors should conduct a careful, independent investigation of the property to determine to your satisfaction the suitability of the property for your needs.

**CBRE**