



BELMONT DRIVE

S O M E R S E T

SOMERSET, NEW JERSEY | **±152,000 SF**

EASY ACCESS TO I-287



BRAHA
PROPERTIES

SITE PLAN

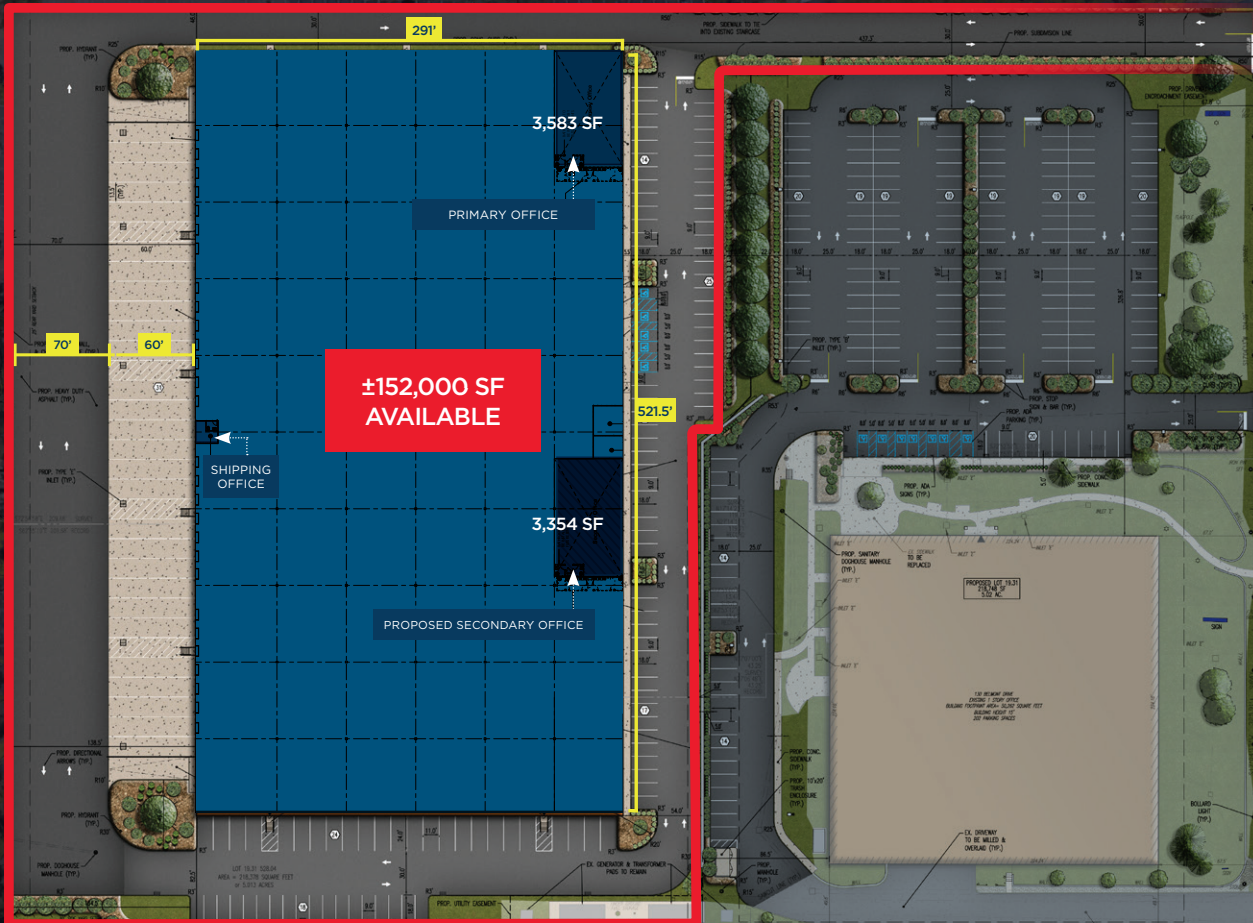

BELMONT DRIVE

BUILDING SPECIFICATIONS:

Total Building SF: ±152,000 SF

Proposed Office: 3,583 SF

Delivery: 2nd Quarter 2023

Building Dimensions: 521.5' x 291'

Column Spacing: 52'1" x 46'2"
60' speed bay

Ceiling Height: 40'

Parking: 93 Car Spaces
24 Van Spaces
EV Ready

Power: 1500 AMP with potential to increase significantly

Loading: 28 Dock Doors
2 Drive-In

HIGHWAY CONNECTIVITY

Within 50 miles drive, you can reach many of New Jersey's core regional submarkets, airports, and freight ports. Also, convenient access to the northeast corridor, stretching from Boston to Virginia.

I-287	1.6 mi
I-78	10.8 mi
Exit 10 NJ Turnpike	13.5 mi
Outerbridge Crossing	17.8 mi
Goethals Bridge	27.1 mi
Port Newark/Elizabeth	29.1 mi
Newark Liberty Airport	29.4 mi
Lincoln Tunnel	41.1 mi
GW Bridge	48.4 mi





**BELMONT
DRIVE**
S O M E R S E T



**BRAHA
PROPERTIES**

CONTACT US

FOR MORE INFORMATION

Mindy Lissner, SIOR

Vice Chair

+1 732 243 3102

mindy.lissner@cushwake.com

David Gheriani

Executive Director

+1 732 243 3108

david.gheriani@cushwake.com

Jason Barton

Executive Managing Director

+1 732 243 3104

jason.barton@cushwake.com

Christopher Griffith

Senior Associate

+1 908 380 3627

chris.griffith@cushwake.com



©2022 Cushman & Wakefield. All rights reserved. The material in this presentation has been prepared solely for information purposes, and is strictly confidential. Any disclosure, use, copying or circulation of this presentation (or the information contained within it) is strictly prohibited, unless you have obtained Cushman & Wakefield's prior written consent. The views expressed in this presentation are the views of the author and do not necessarily reflect the views of Cushman & Wakefield. Neither this presentation nor any part of it shall form the basis of, or be relied upon in connection with any offer, or act as an inducement to enter into any contract or commitment whatsoever. NO REPRESENTATION OR WARRANTY IS GIVEN, EXPRESS OR IMPLIED, AS TO THE ACCURACY OF THE INFORMATION CONTAINED WITHIN THIS PRESENTATION, AND CUSHMAN & WAKEFIELD IS UNDER NO OBLIGATION TO SUBSEQUENTLY CORRECT IT IN THE EVENT OF ERRORS.