

LAST INDUSTRIAL UNIT

NEW OWNERSHIP & MANAGEMENT



**SPECIFICATIONS:**

**HIGHLIGHTS:**

**Total Building:** 80,386 SF

• Separately metered

**Clear Height:** 17'

• Individual entrance

**Available:** 2,624 SF

• Just half a mile to full 4-way interchange at I-55 and Route 83

**Loading:** 1 Truck Level Dock

**Lease Rate:** \$10 Gross PSF

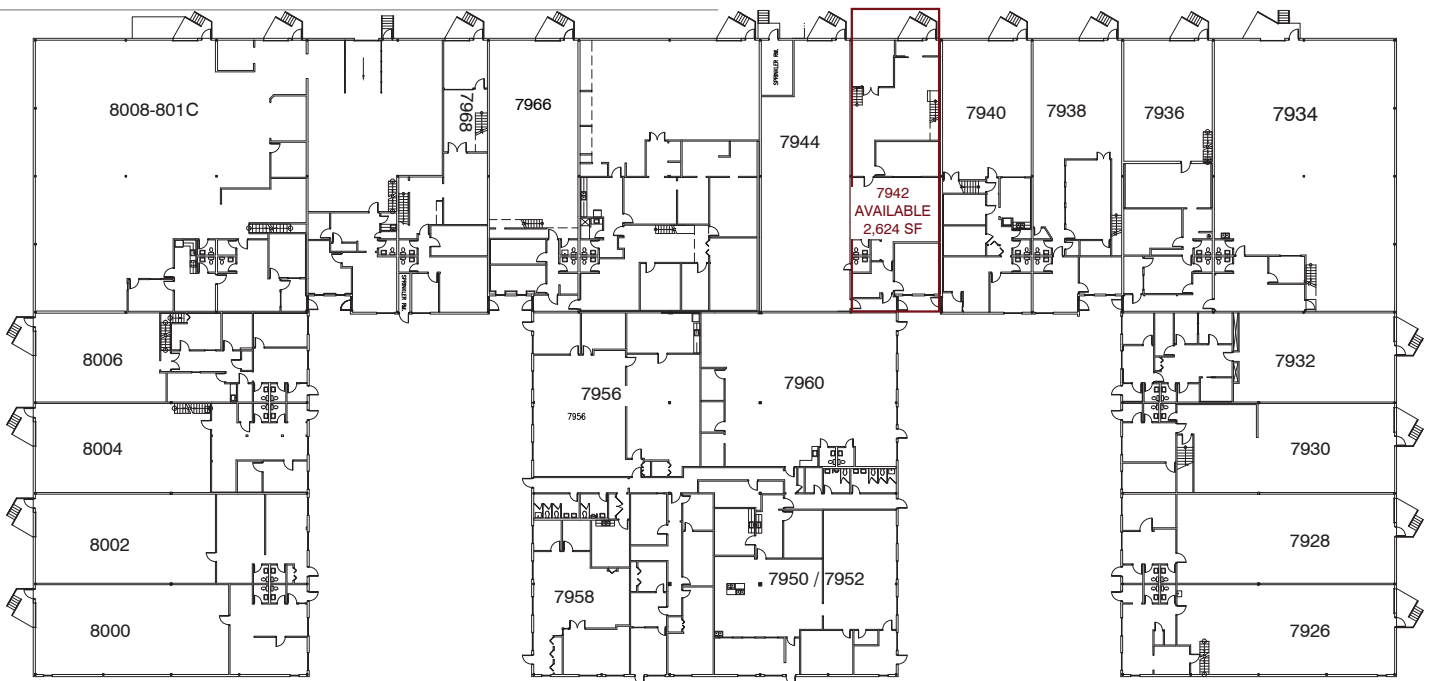

2,624 SF

LAST INDUSTRIAL UNIT

