



# For Sale or Lease

**+/- 44,275 SF**

## Building specifications

- **Building size:** ± 44,275 SF
- **Available space:** ± 44,275 SF
- **Office:** ± 7,251 SF (can be reduced)
- **Loading:** 4
- **Ceiling height:** 18'6"
- **Column spacing:** 19' x 39'
- **Power** 1,200 Amps

## Location

- 7 miles to Lincoln Tunnel
- 9 miles to George Washington Bridge
- Easy access to NJ Turnpike, Interstate 80, and Routes 3 and 17

**850 Washington Ave  
Carlstadt, New Jersey**

**Michael Palmeri**  
Senior Vice President  
+1 908 361 2461  
[michael.palmeri@am.jll.com](mailto:michael.palmeri@am.jll.com)

**Dean Brody**  
Executive Managing Director  
+1 201 528 4410  
[dean.brody@am.jll.com](mailto:dean.brody@am.jll.com)

**Gregg Brody**  
Vice President  
+1 201 966 4729  
[gregg.brody@am.jll.com](mailto:gregg.brody@am.jll.com)



**Site plan:**

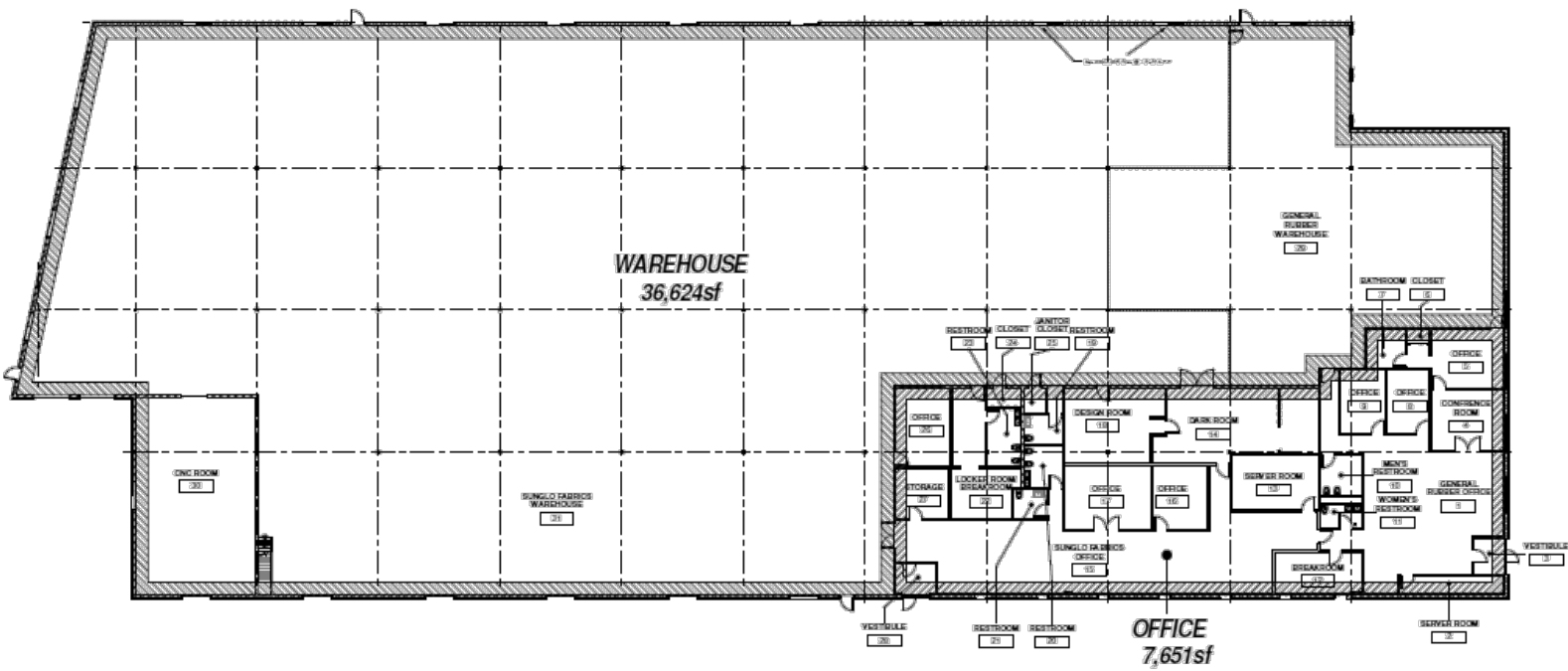

**Location:**

