

FOR LEASE

**8925 Carroll Way**

San Diego, California 92121

**Voit**

REAL ESTATE SERVICES



### Property Highlights

- ±21,500 SF
- 10% Office Build-out
- 1 Double Dock Door
- 1 Ramp
- 2 Grade Level Doors
- 27' Clearance
- Sprinklered (.65 GPM/3,000 SF)
- Gas Service
- Just off Miramar Road
- Lease Rate: \$0.72 PSF NNN



**Todd Holley**

Vice President  
Lic #01046508  
858.458.3349  
tholley@voitco.com

**Randy LaChance, SIOR**

Senior Vice President  
Lic #00969674  
858.458.3374  
rlachance@voitco.com

# FOR LEASE

## 8925 Carroll Way

San Diego, California 92121

### Availability

Suite	Size	Asking Rate	Comments	Available	To Show
C	21,500 SF	\$0.72 NNN (Nets=\$0.15)	Reception, 3 Offices, 1 Double Dock Door, 1 Ramp, 2 Grade Level Doors	With 30 Day Notice	Appointment

Site Plan

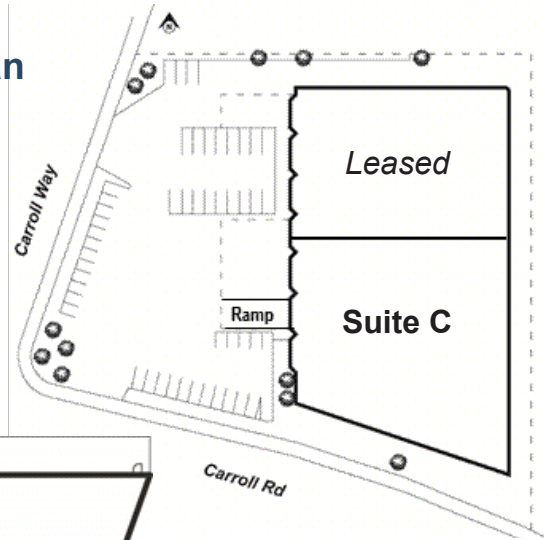

Floor Plan

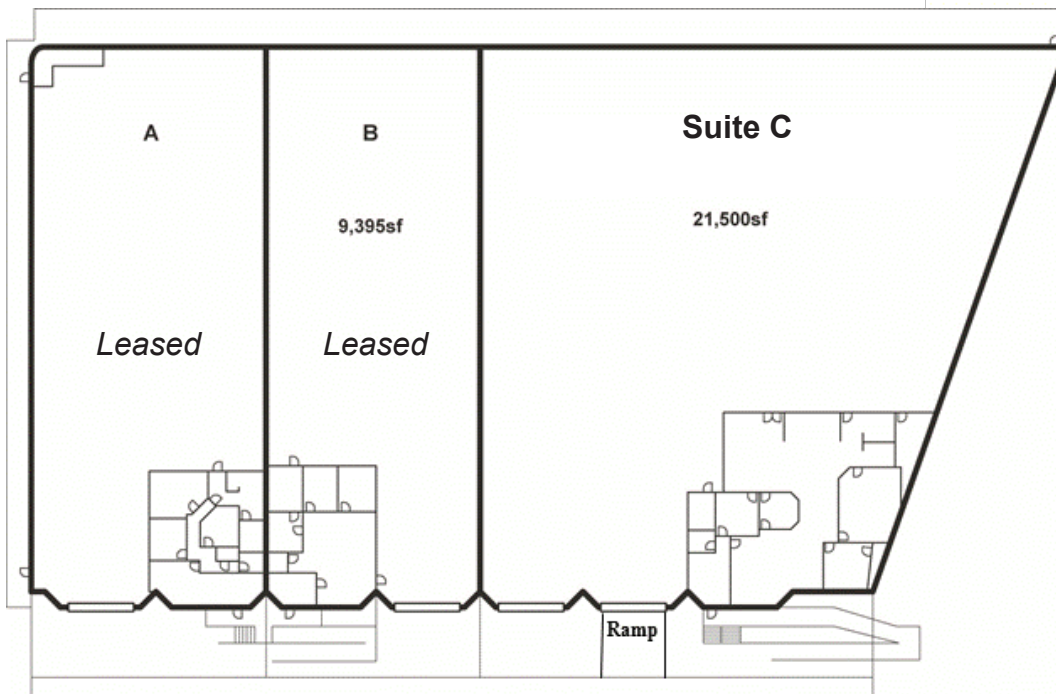

**Todd Holley**  
Vice President  
Lic #01046508  
858.458.3349  
tholley@voitco.com

**Randy LaChance, SIOR**  
Senior Vice President  
Lic #00969674  
858.458.3374  
rlachance@voitco.com

**Voit**  
REAL ESTATE SERVICES

4370 La Jolla Village Dr., Suite 990, San Diego, CA 92122 • 858.453.0505 • 858.453.1981 Fax • Lic #01333376 | www.voitco.com