

TEMPERATURE CONTROLLED

REFRIGERATED SPACE



FOR SALE OR LEASE
112,140 SF on 10.5 Acres
Divisible to 15,000 SF

Property Highlights

- 8,500 SF Office Area
- 28,207 SF Temperature Controlled
- 12,000 SF Refrigerated Space
- 17' - 22' Ceiling Height
- 11 Loading Docks
- 3 Drive-in Doors
- 48' x 60' Column Spacing
- 800 Amps Power
- Taxes \$136,000
- Call for Pricing

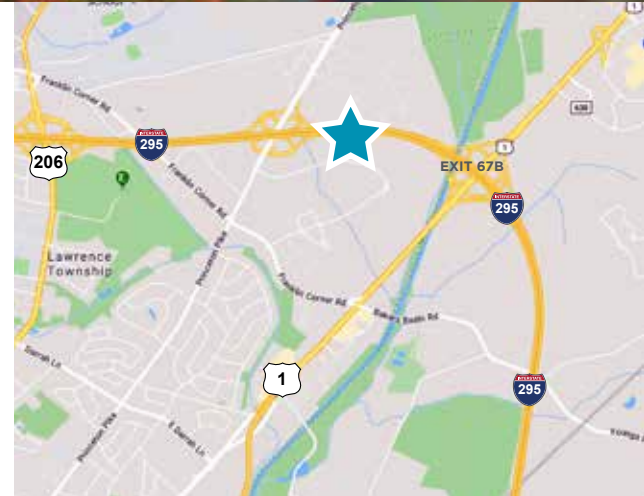

Charles Fern
Vice Chairman
T +1 732 243 3101
chuck.fern@cushwake.com

Gary C. Casaletto
Director
+1 732 243 3106
gary.casaletto@cushwake.com

Jason Barton, SIOR
Executive Director
+1 732 243 3104
jason.barton@cushwake.com

99 Wood Avenue South
8th Floor
Iselin, NJ 08830
Main: + 1 732 623 4700
cushmanwakefield.com



FOR SALE OR LEASE

6 Princess Road

Lawrenceville, New Jersey





**CUSHMAN &
WAKEFIELD**

FOR SALE OR LEASE

6 Princess Road

Lawrenceville, New Jersey

Tax Map



Site Plan

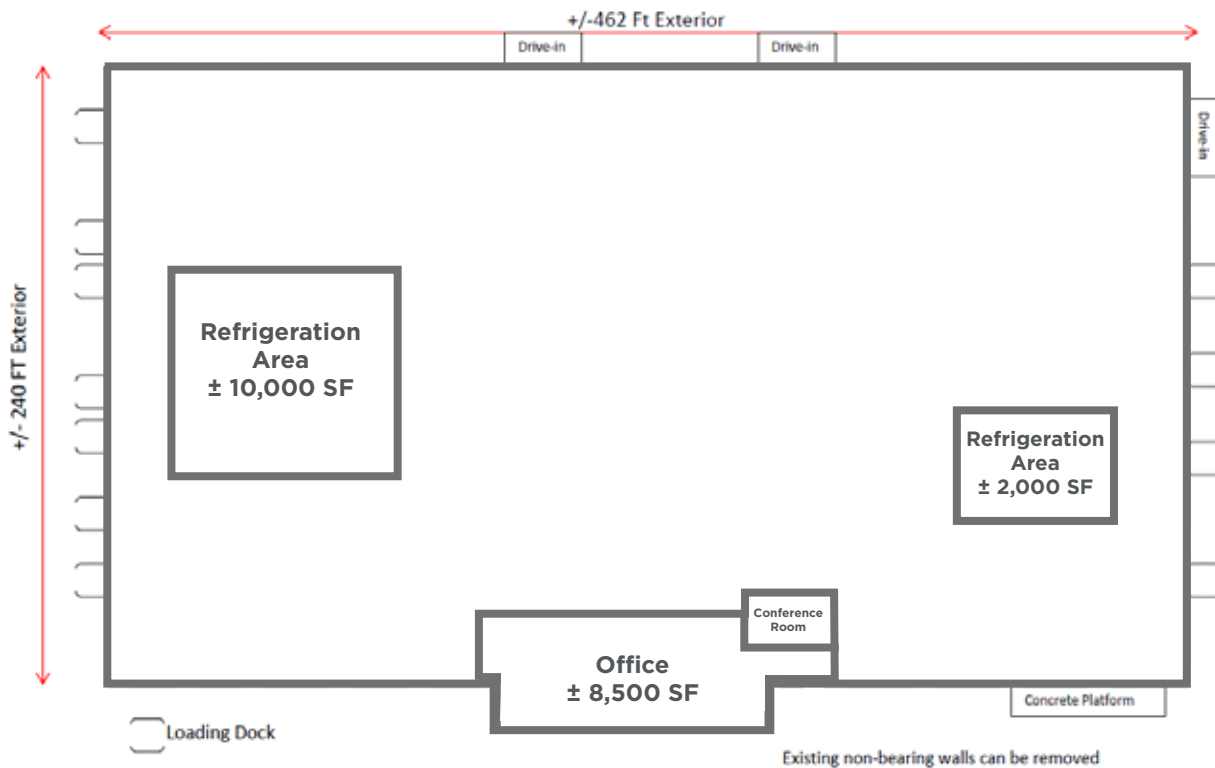



**CUSHMAN &
WAKEFIELD**

FOR SALE OR LEASE

6 Princess Road

Lawrenceville, New Jersey

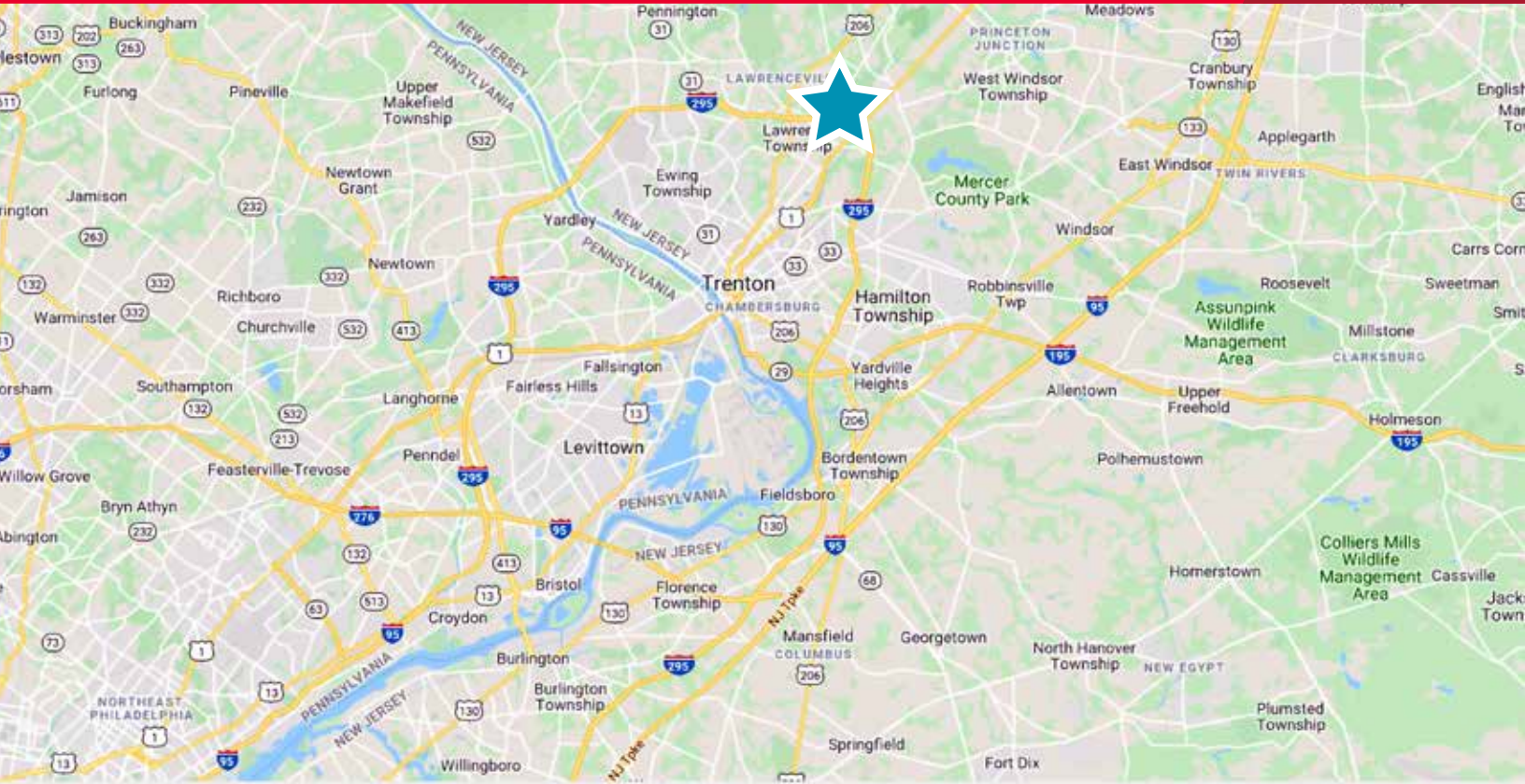

Location

- 0.6 Miles to I-295, Exit 68A
- 3.8 Miles to US 1 South

Join Corporate Neighbors

- Bristol-Meyers Squibb
- Datacolor International
- Fox Rothschild
- Princeton Healthcare Systems
- Sirius XM Radio
- Stark & Stark

Charles Fern
Vice Chairman

T +1 732 243 3101
chuck.fern@cushwake.com

Gary C. Casaletto
Director

+1 732 243 3106
gary.casaletto@cushwake.com

Jason Barton, SIOR
Executive Director

+1 732 243 3104
jason.barton@cushwake.com

99 Wood Avenue South
8th Floor
Iselin, NJ 08830
Main: + 1 732 623 4700
cushmanwakefield.com