

PRIME RETAIL SPACE ADJACENT TO KOHL'S

Roswell, GA 30075 | 620 W. Crossville Road | Hwy 92 & Woodstock Rd | #445



- 24,700 SF junior anchor space available
- Directly adjacent to Michael's
- Located at the busy retail intersection of Hwy 92 and Woodstock Rd
- Area retailers include Publix, The Home Depot, Trader Joe's, Petsmart and OfficeMax

DEMOGRAPHICS	1 MILE	3 MILES	5 MILES	TRAFFIC COUNTS	
2018 POPULATION	5,427	57,291	160,372	W. Crossville Road	52,800 AADT
2018 DAYTIME POPULATION	7,274	62,638	171,238		
2018 AVERAGE HH INCOME	132,106	149,535	128,749		
2018 MEDIAN HH INCOME	102,689	110,717	96,782		

AVAILABLE SF:
24,700 SF

FRONTAGE:
APPROX. 98'2"

ZONING:
COMMERCIAL

RATES:
CALL FOR DETAILS

AREA ANCHORS



FOR MORE INFORMATION, CONTACT EXCLUSIVE AGENT(S):
PATRICK BENTLEY • patrick.bentley@tscg.com • 770.955.2434



PRIME RETAIL SPACE ADJACENT TO KOHL'S

Roswell, GA 30075 | 620 W. Crossville Road | Hwy 92 & Woodstock Rd | #445



FOR MORE INFORMATION, CONTACT EXCLUSIVE AGENT(S):
 PATRICK BENTLEY • patrick.bentley@tscg.com • 770.955.2434



Demographics: Esri 2018 No warranty expressed or implied has been made as to the accuracy of the information provided herein, no liability assumed for error or omissions.

PRIME RETAIL SPACE ADJACENT TO KOHL'S

Roswell, GA 30075 | 620 W. Crossville Road | Hwy 92 & Woodstock Rd | #445

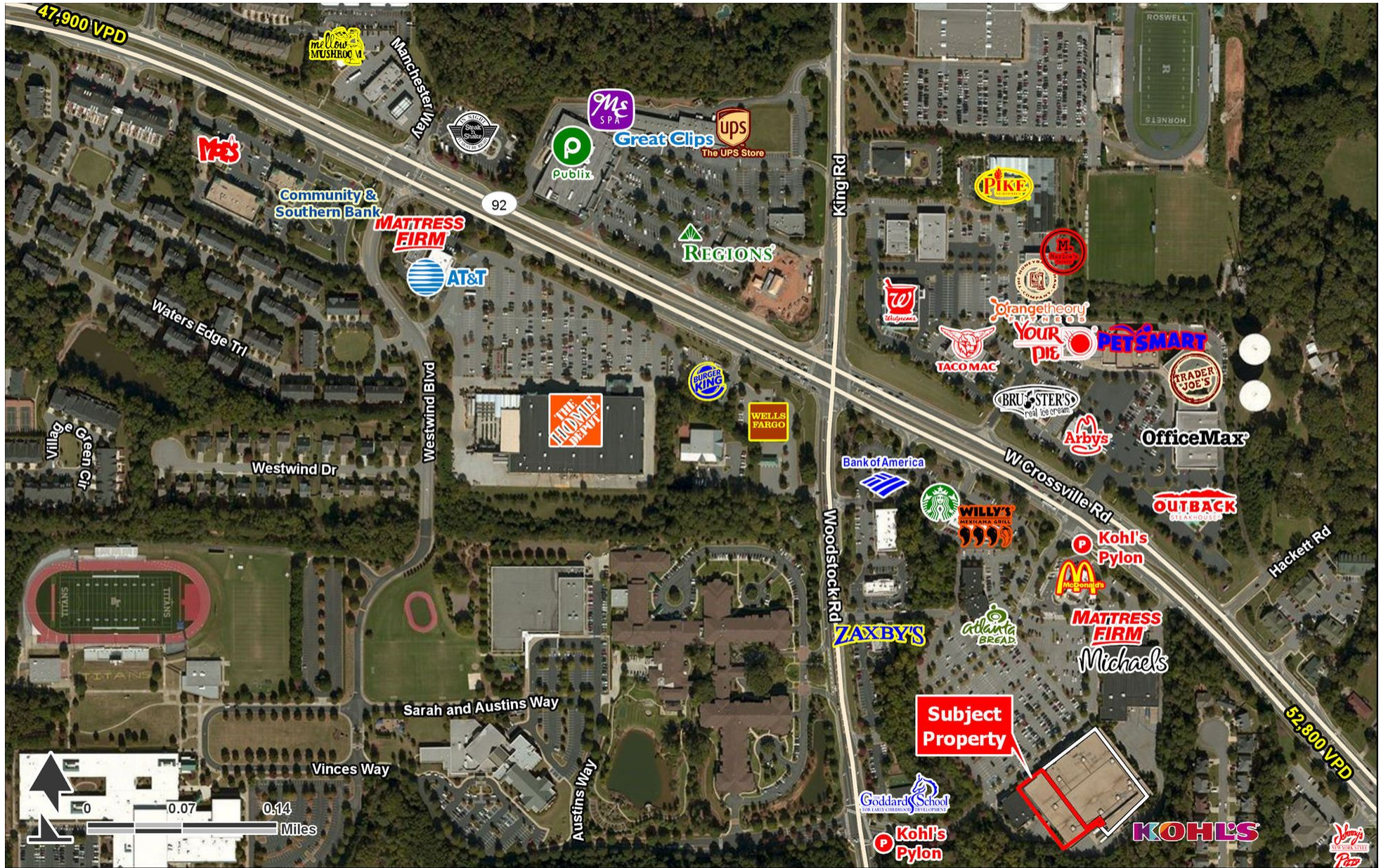

FOR MORE INFORMATION, CONTACT EXCLUSIVE AGENT(S):
PATRICK BENTLEY • patrick.bentley@tscg.com • 770.955.2434



Demographics: Esri 2018 No warranty expressed or implied has been made as to the accuracy of the information provided herein, no liability assumed for error or omissions.

PRIME RETAIL SPACE ADJACENT TO KOHL'S

Roswell, GA 30075 | 620 W. Crossville Road | Hwy 92 & Woodstock Rd | #445

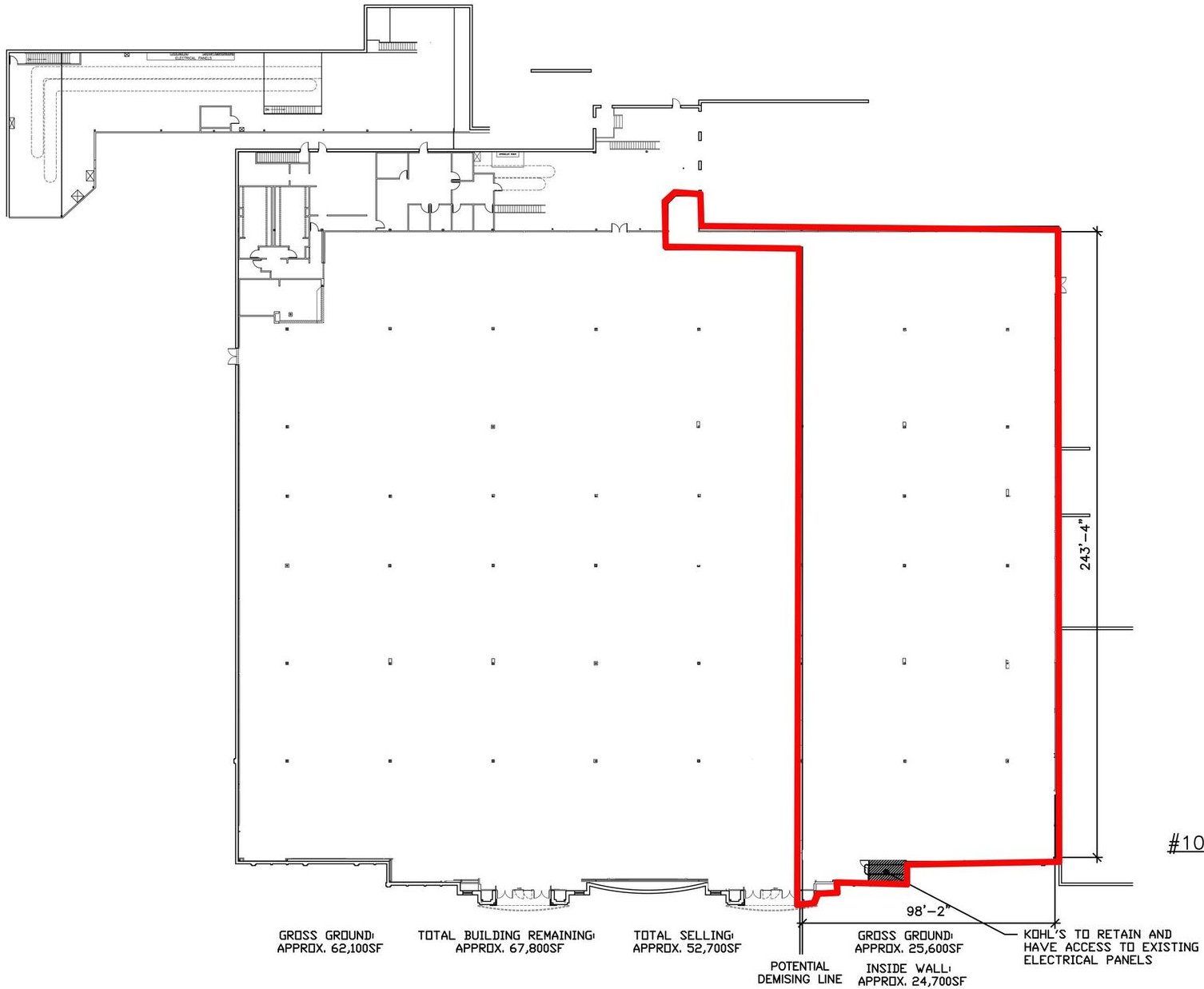

#10445 Roswell, GA
Updated: 3/6/18



FOR MORE INFORMATION, CONTACT EXCLUSIVE AGENT(S):
PATRICK BENTLEY • patrick.bentley@tscg.com • 770.955.2434

