



**Available
For Lease**

- ◆ **Street Level Retail**
- ◆ **Build to suit 2nd floor mezzanine office space**
- ◆ **3rd Floor Office**
- ◆ **Prime Beach drive location**
- ◆ **Multi-million dollar renovation recently completed**

Downtown St. Petersburg

Bayfront Tower is a mixed use condo development located in the heart of Downtown St. Petersburg. Available commercial space includes street level retail space along with second and third floor office space. Take this opportunity to lease in the Bayfront Tower which has recently undergone a multi-million dollar renovation.

Located on Beach Drive, just steps from the city's best restaurants, shopping and entertainment. Across the street from the Tom James art museum, ONE St. Pete, Pioneer Park, Al Lang Stadium (Home of the Rowdies), the St. Petersburg Yacht Club and adjacent to Straub Park, the building could not be in a better location to enjoy all that Downtown St. Petersburg has to offer.

**Contact:
Blakemore Kearney**

**125 FIFTH STREET SOUTH
SUITE 201
ST. PETERSBURG, FL 33701**

**727.823.1230 EXT. 228
C: 727.455.5150
F: 727.823.4067
E: BKearney@VectorRealty.com
W: VectorRealty.com**

Suite Number	Size	Space Type	Lease Type	Rental Rate	Date Available
106	1,650 RSF	Street Level Retail	Modified Gross	\$35/SF/YR	March 1, 2019
201M	10,000 RSF	Office	Modified Gross	\$21/SF/YR	April 1, 2019
304	1,118 RSF	Office	Modified Gross	\$21/SF/YR	Immediate

1st Floor
Street Level Office/Retail
Suite 106 - 1,650 RSF

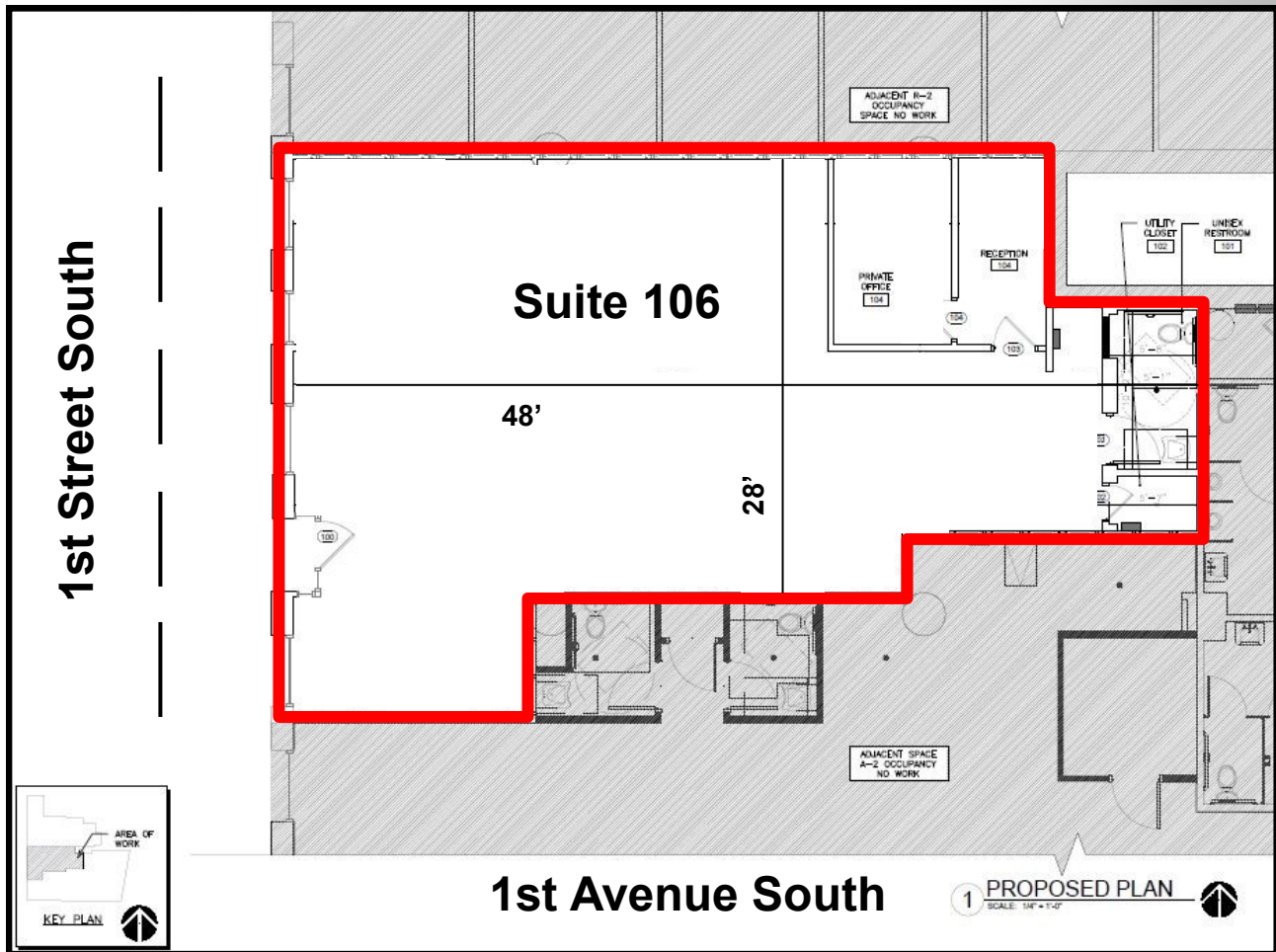

3rd Floor Plan
Suite 304 - 1,118 RSF

