

720 BELLEVILLE TURNPIKE, KEARNY, NEW JERSEY 07032



• LEASING BROCHURE •

INDUSTRIAL SPACE FOR LEASE

720 BELLEVILLE

• NOVEMBER 2018 •

Located less than 8 miles from downtown Manhattan,
720 Belleville Turnpike in Kearny, New Jersey is a
76,972-square-foot warehouse positioned to deliver.





BELLEVILLE TURNPIKE (NJ ROUTE 7)

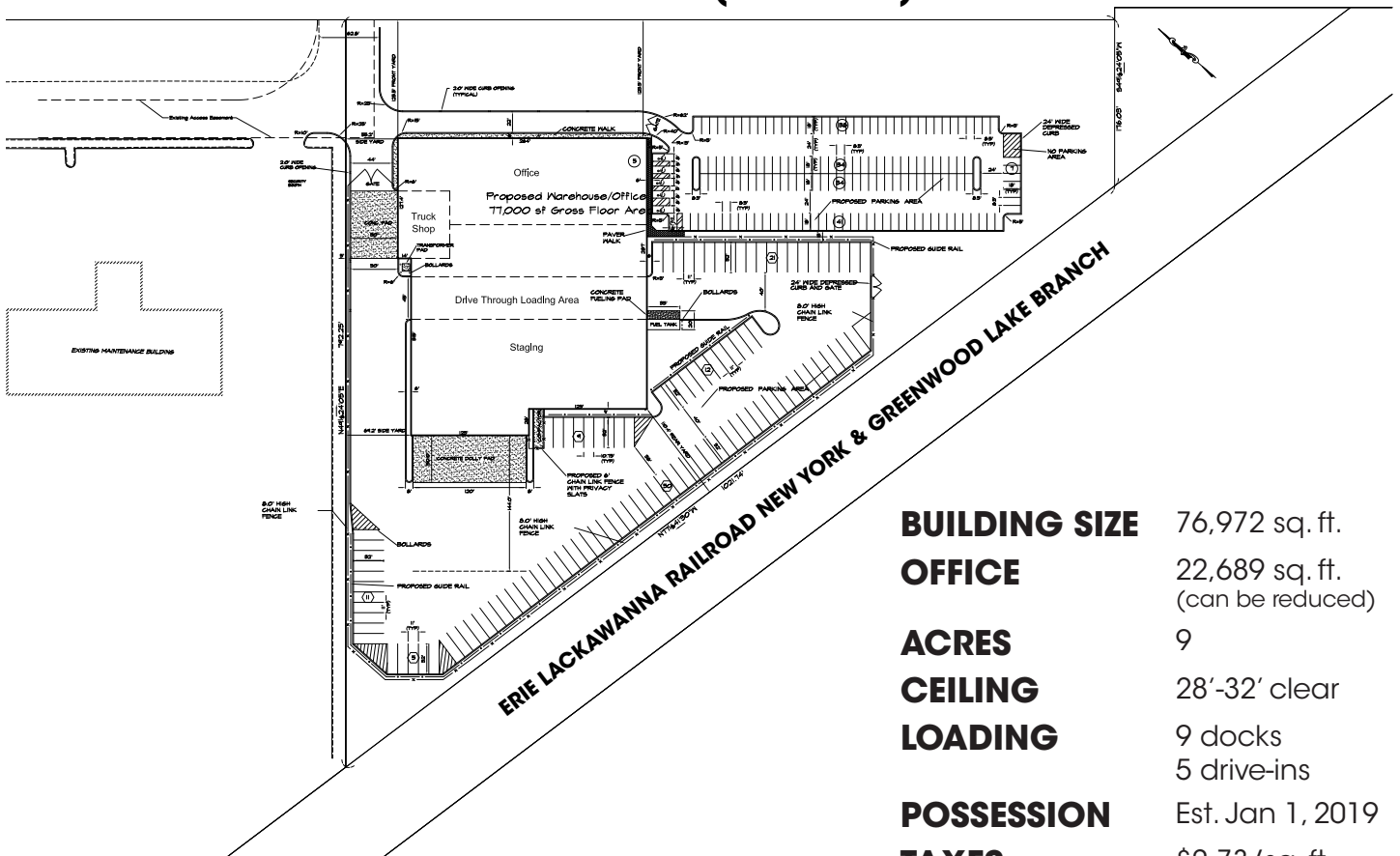

BUILDING SIZE	76,972 sq. ft.
OFFICE	22,689 sq. ft. (can be reduced)
ACRES	9
CEILING	28'-32' clear
LOADING	9 docks 5 drive-ins
POSSESSION	Est. Jan 1, 2019
TAXES	\$2.73/sq. ft.
CAM	\$0.65/sq. ft.
PARKING	±3 acres

720 BELLEVILLE

CBRE



PROPERTY DETAILS

Kitchen/breakrooms

Fleet shop

- Room with three drive-ins (10'x16'), floor drains and ventilation

Drive-through in main warehouse

- Two oversized doors
- 9 dock doors

Trash compactor

Secure fence

Parking

- 159 car spaces
- 112 truck spaces

720 BELLEVILLE

CBRE

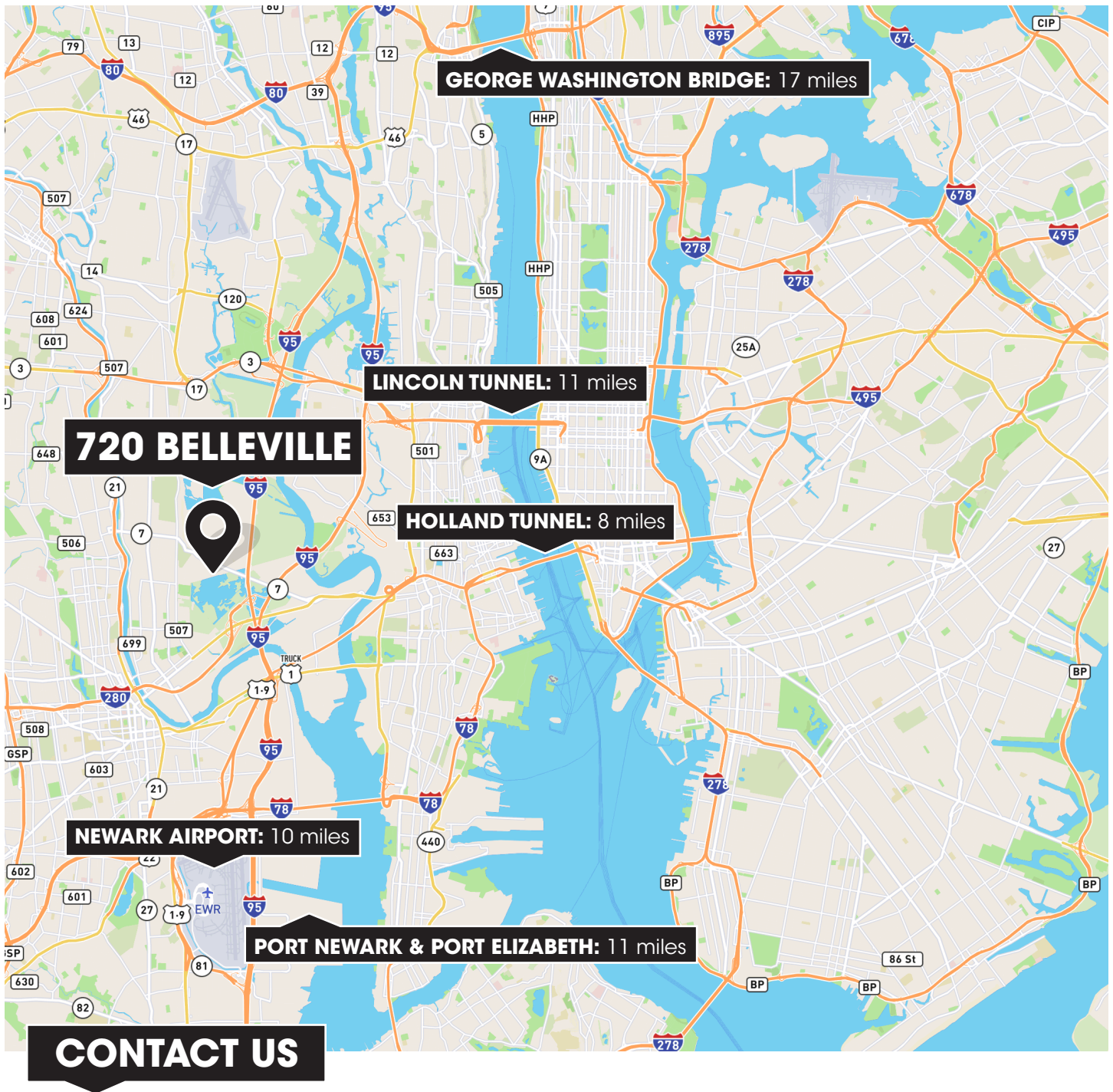

WILLIAM WAXMAN
Executive Vice President
+1 201 712 5810
william.waxman@cbre.com

KEVIN DUDLEY
First Vice President
+1 201 712 5837
kevin.dudley@cbre.com

NICHOLAS KLACIK
Associate
+1 201 712 5615
nicholas.klacik@cbre.com

JUSTIN PASSARETTI
Associate
+1 201 712 5829
justin.passaretti@cbre.com

720 BELLEVILLE

© 2019 CBRE, Inc. All rights reserved. This information has been obtained from sources believed reliable, but has not been verified for accuracy or completeness. You should conduct a careful, independent investigation of the property and verify all information. Any reliance on this information is solely at your own risk.

CBRE