

# 500 EAST 14TH STREET



# SPACE DETAILS

**LOCATION**

South block between Avenues A and B

**APPROXIMATE SIZE**

Ground Floor 12,718 SF

**CEILING HEIGHT**

Ground Floor 15 FT

**FRONTAGE**

114 FT on East 14th Street

**POSSESSION**

Immediate

**SITE STATUS**

New Construction

**NEIGHBORS**

Target, Trader Joe's, CVS pharmacy, T-Mobile, Duane Reade

**COMMENTS**

- Multiple divisions considered
- At the base of a 106-unit residential building
- Adjacent to recently opened Target
- Space can be vented for cooking

**GROUND FLOOR**

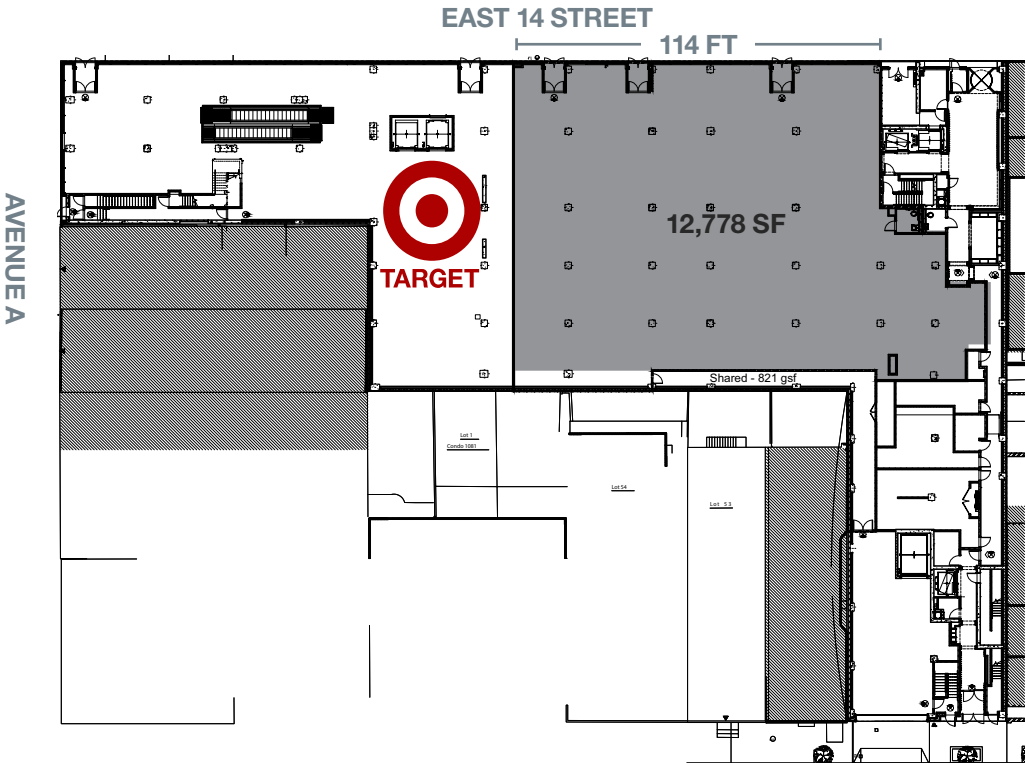

# AREA RETAIL



## CONTACT EXCLUSIVE AGENTS

**HARRISON ABRAMOWITZ**

212.372.2467

habramowitz@ngkf.com



NGKF.COM



RKF.COM