

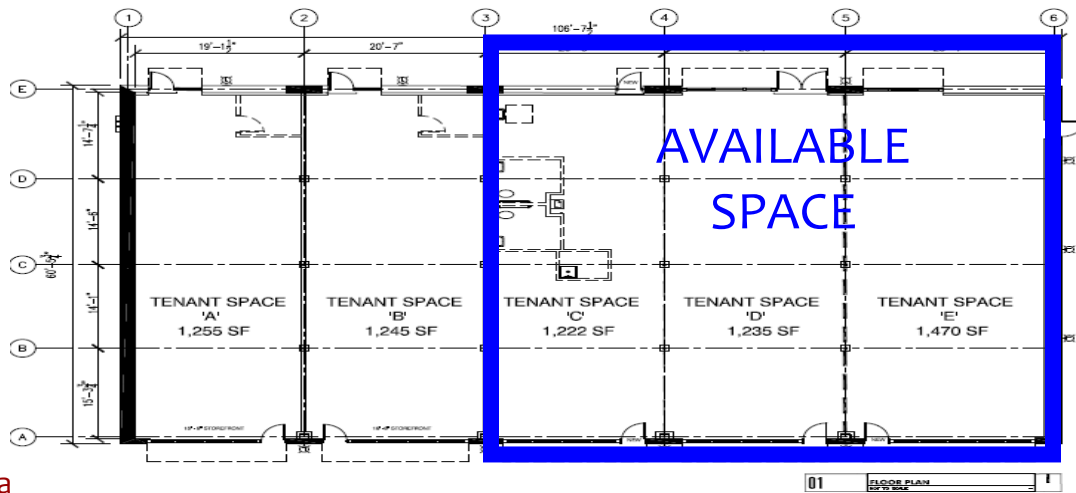

7501 W. Roosevelt Rd.

FOREST PARK, IL

**FOR SALE/LEASE**



**Leasing Informa**

Available space: 1,245 SF min  
 3,927 SF max  
 Lease Rate: \$20.00/SF – Triple Net  
 Taxes/CAM: \$9.00/SF  
 Building Size: 6,427 square feet  
 Parking space: 25 spaces

**Building Features**

- One story building
- Newer construction

**Area Features**

- 1 Mile to Eisenhower Expressway, I-290

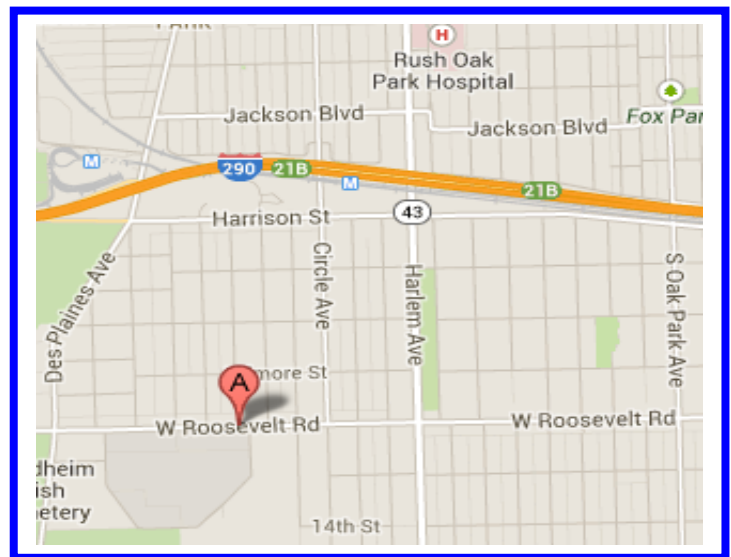

**Peter C. Cacciatore** 312.264.6027 [pcacciatore@jos-cacciatore.com](mailto:pcacciatore@jos-cacciatore.com)

527 S. Wells St., Suite 700

Chicago, IL 60607

[www.jos-cacciatore.com](http://www.jos-cacciatore.com)