

FOR SALE
OR LEASE

Office Condominium

8949 Complex Drive, Suite B, San Diego, California 92123



PROPERTY DETAILS

SIZE	1,864 SF
100% IMPROVED	Second Floor Corner Unit
LOCATION	A Well-Maintained 155,000 SF Business Park
ACCESS	Excellent Access to Hwy 52, Hwy 163, I-805, & I-15
FIBER OPTICS	Former Cox Co-Location Data Center Near One of the Main Fiber Optic Loops in San Diego
POWER	Exterior Generator Pad Available for Purchase
COMMON AREA RESTROOMS	Not Part of Unit Square Footage
ADDITIONAL FEATURES	I.T. Room, One New 5-ton HVAC Unit, Outside Lunch Area, & 200 Amp Service

SALE PRICE:
LEASE RATE:

\$370,936 (\$199 PSF)
To Be Determined

Jon Danton

Senior Associate

jdanton@voitco.com

858.458.3376

Lic. #01800488

Ryan Bracker

Senior Associate

rbracker@voitco.com

858.458.3355

Lic. #01353870

4747 Executive Dr., Suite 800, San Diego, CA 92121

858.453.0505 | 858.408.3976 Fax | Lic #01333376 | www.voitco.com

Voit

REAL ESTATE SERVICES

**FOR SALE
OR LEASE**

Office Condominium

8949 Complex Drive, Suite B, San Diego, California 92123

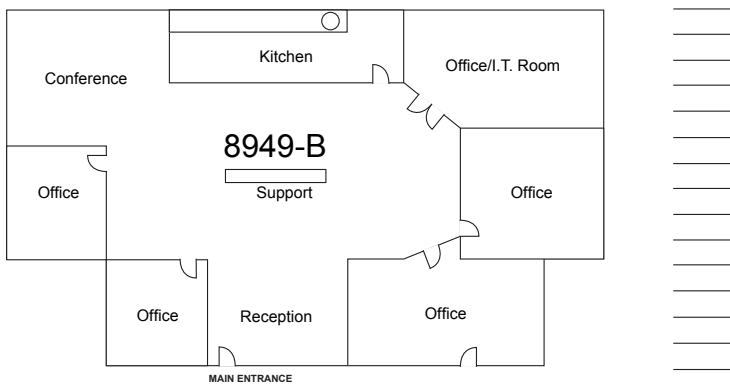

Jon Danton
Senior Associate
jdanton@voitco.com
858.458.3376
Lic. #01800488

Ryan Bracker
Senior Associate
rbracker@voitco.com
858.458.3355
Lic. #01353870

4747 Executive Dr., Suite 800, San Diego, CA 92121
858.453.0505 | 858.408.3976 Fax | Lic #01333376 | www.voitco.com

The information contained herein has been obtained from sources we deem reliable. While we have no reason to doubt its accuracy, we do not guarantee it.
©2012 Voit Real Estate Services, Inc. All Rights Reserved. Real People. Real Solutions.® is a registered trademark of Voit Real Estate Services.



Voit
REAL ESTATE SERVICES