



## Industrial Space Available For Sale or Lease

17 Imclone Drive, Branchburg, New Jersey



### Location

- Direct access to NJ Route 202
- 7 minutes from Route 206
- 8 minutes from Route 22
- 9 minutes from I 287
- Close to area amenities including Bridgewater Commons

### Facility

- 55,233 SF total building size
- 25,600 SF available
- 2,435 SF office
- 22' clear ceiling height
- 30 car parking spaces
- 2 loading docks
- Fully air conditioned building
- ESFR system

---

### For more information, please contact:

**Chad Hillyer**, Managing Director | + 1 201 528 4429 | [chad.hillyer@am.jll.com](mailto:chad.hillyer@am.jll.com)

**Jenna Imperatore**, Senior Vice President | + 1 201 528 4418 | [jenna.imperatore@am.jll.com](mailto:jenna.imperatore@am.jll.com)

**Harold Imperatore**, Associate | +1 201 528 4430 | [harold.imperatore@am.jll.com](mailto:harold.imperatore@am.jll.com)

# 17 Imclone Drive, Branchburg, New Jersey

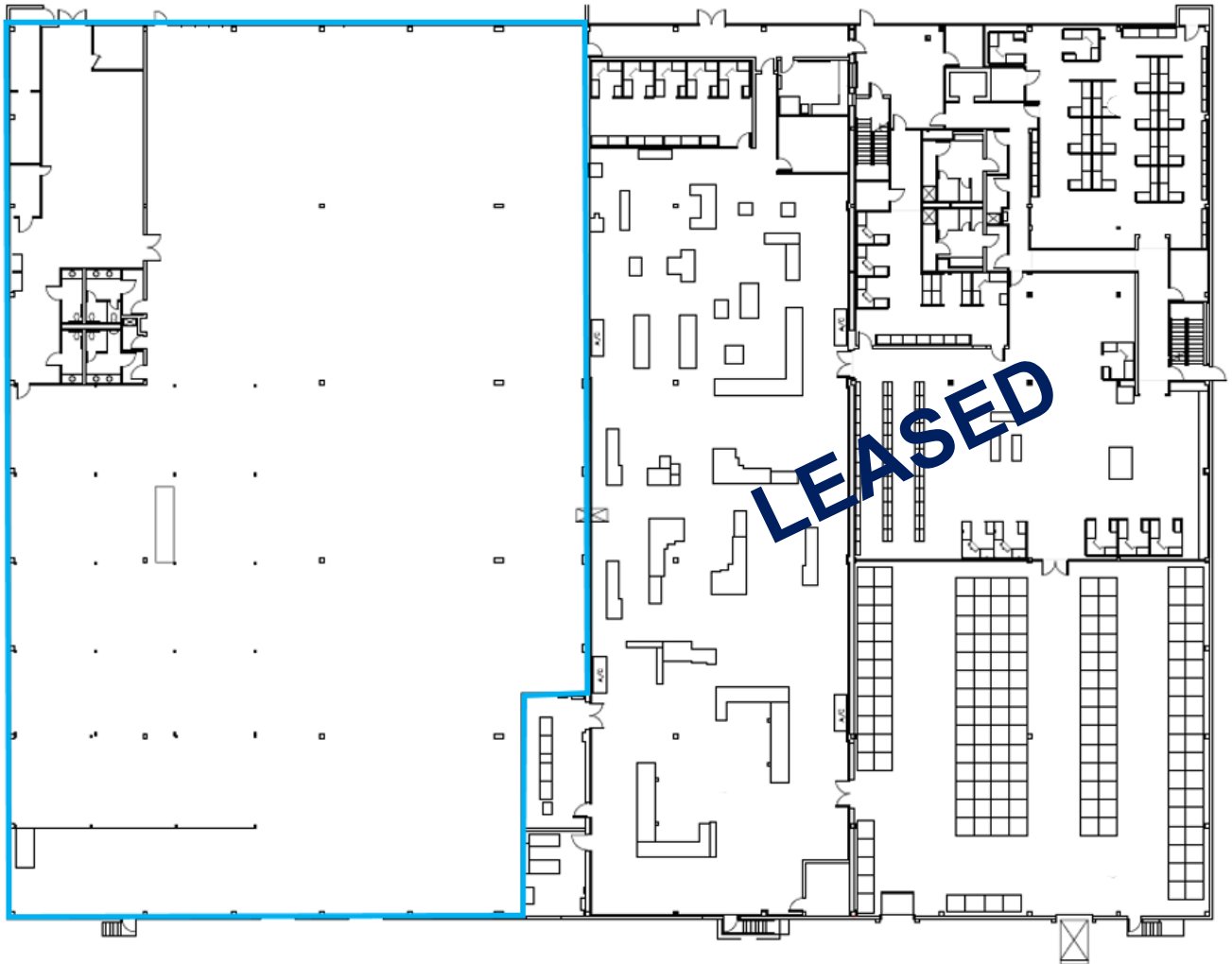

**For more information, please contact:**

**Chad Hillyer**, Managing Director | + 1 201 528 4429 | [chad.hillyer@am.jll.com](mailto:chad.hillyer@am.jll.com)

**Jenna Imperatore**, Senior Vice President | + 1 201 528 4418 | [jenna.imperatore@am.jll.com](mailto:jenna.imperatore@am.jll.com)

**Harold Imperatore**, Associate | +1 201 528 4430 | [harold.imperatore@am.jll.com](mailto:harold.imperatore@am.jll.com)