

For Lease

Lincoln Park (Morris County), NJ

VITA & VITA REALTY CORP.

Andrew S. Vita, Jr.

Andrew@VitaRealty.com

Anthony Vita

Tony@VitaRealty.com

T - 973-227-5233

F - 973-227-5133

Lincoln Park Plaza

- ***44+ Year Bank Location
Coming Available***
- +/-300 Car Parking
- Plaza GLA +/-58,752 Sq. Ft.
- National/Regional Co-Tenants include: ACE Home Center, McDonalds's, Carvel, Frank's Pizza, Verizon Wireless, Fed Ex, and Allstate.
- Adjacent to CVS Pharmacy, NJ Transit Train Station, Grammar School, Town Hall, Public Library, Police, Fire, & Emergency Services.



Lincoln Park, NJ Morris County

VITA & VITA REALTY CORP.

Andrew S. Vita, Jr.

Andrew@VitaRealty.com

Anthony Vita

Tony@VitaRealty.com

T - 973-227-5233

F - 973-227-5133



Lincoln Park, NJ

Morris County

VITA & VITA REALTY CORP.

Andrew S. Vita, Jr.

Andrew@VitaRealty.com

Anthony Vita

Tony@VitaRealty.com

T - 973-227-5233

F - 973-227-5133



- Two Signalized Intersections
- 5 Curb Cuts
- Direct Highway Access
- Excellent Visibility
- Minutes to I-287 & 80 and Routes 23 & 46
- Population 137,883 (5 Mile)
- Average Household Income \$119,210 (3 Mile)
- Average Household Income \$129,653 (5 Mile)

Lincoln Park, NJ Leasing Plan

VITA & VITA REALTY CORP.

Andrew S. Vita, Jr.
Andrew@VitaRealty.com
 Anthony Vita
Tony@VitaRealty.com
 T - 973-227-5233
 F - 973-227-5133

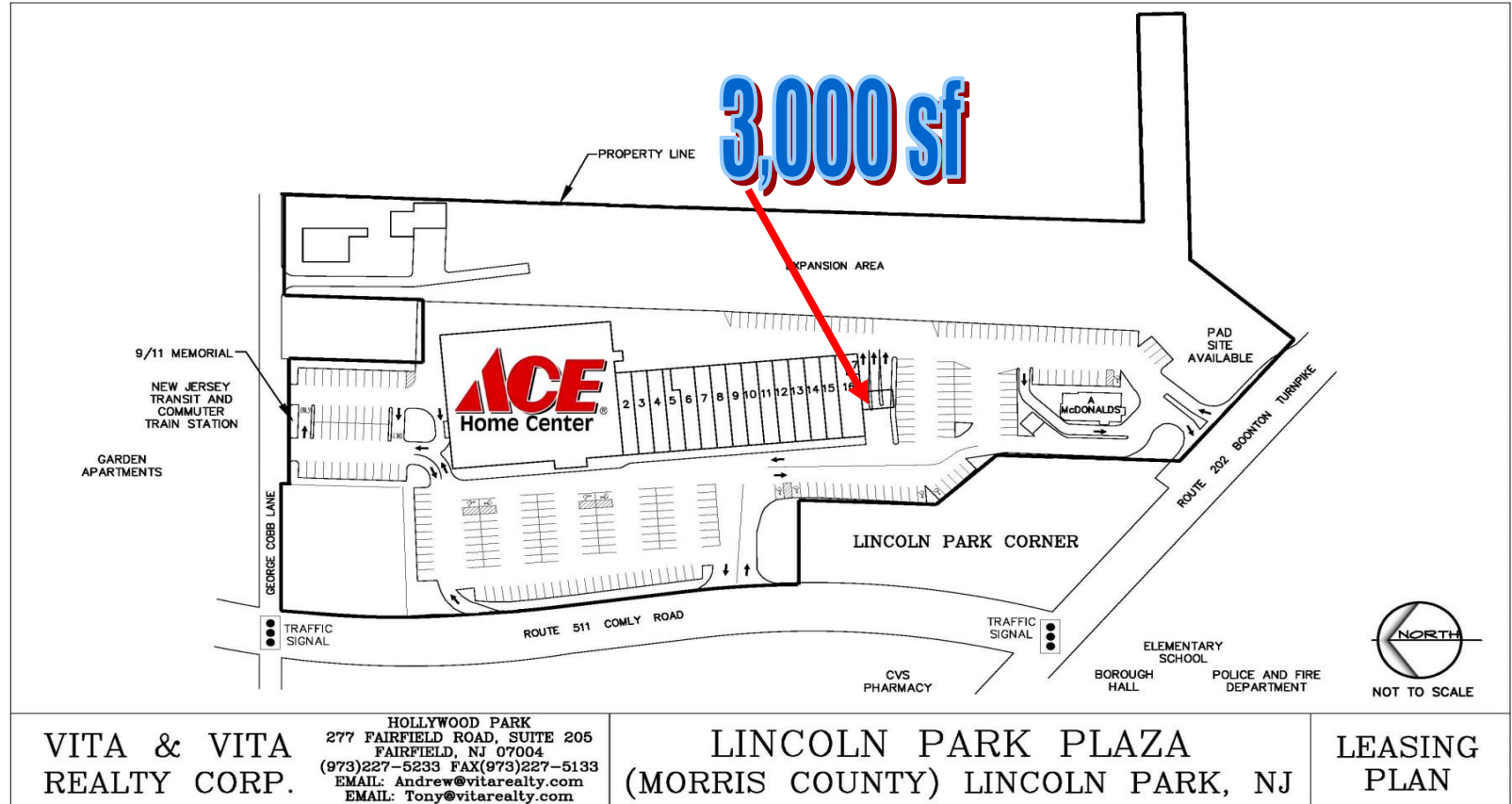

VITA & VITA
REALTY CORP.

HOLLYWOOD PARK
 277 FAIRFIELD ROAD, SUITE 205
 FAIRFIELD, NJ 07004
 (973)227-5233 FAX(973)227-5133
 EMAIL: Andrew@vitarealty.com
 EMAIL: Tony@vitarealty.com

LINCOLN PARK PLAZA
 (MORRIS COUNTY) LINCOLN PARK, NJ

LEASING
PLAN

Lincoln Park, NJ

Morris County

VITA & VITA REALTY CORP.

Andrew S. Vita, Jr.

Andrew@VitaRealty.com

Anthony Vita

Tony@VitaRealty.com

T - 973-227-5233

F - 973-227-5133

