



CUSHMAN &  
WAKEFIELD

**FOR SUBLEASE**

**180 MADISON AVENUE  
NEW YORK, NY**



**Entire 23rd Floor  
8,433 RSF**

Term: June 29, 2025

Comments:

- Full floor available for sublease built & furnished
- Exposed ceilings, oversized windows, great natural light
- Installation includes 64 workstations, 6 offices/meeting rooms, 3 conference rooms and a pantry
- Easy access to Penn Station/Grand Central as we all as multiple subway lines

ADAM ARDISE  
Vice Chairman  
+1 212 318 9741  
[Adam.Ardise@cushwake.com](mailto:Adam.Ardise@cushwake.com)

STEPHEN BELLWOOD  
Senior Managing Director  
+1 212 318 9785  
[Stephen.Bellwood@cushwake.com](mailto:Stephen.Bellwood@cushwake.com)

GORDON HOUGH  
Associate  
+1 212 895 8927  
[Gordon.L.Hough@cushwake.com](mailto:Gordon.L.Hough@cushwake.com)

JOHN HARRIS  
Associate  
+1 212 841 7633  
[John.Harris@cushwake.com](mailto:John.Harris@cushwake.com)



# FLOOR PLAN

180 MADISON AVENUE



## Contact

**ADAM ARDISE**  
Vice Chairman  
+1 212 318 9741

[Adam.Ardise@cushwake.com](mailto:Adam.Ardise@cushwake.com)

**STEPHEN BELLWOOD**  
Senior Managing Director  
+1 212 318 9785

[Stephen.Bellwood@cushwake.com](mailto:Stephen.Bellwood@cushwake.com)

**GORDON HOUGH**  
Associate  
+1 212 895 8927

[Gordon.L.Hough@cushwake.com](mailto:Gordon.L.Hough@cushwake.com)

**JOHN HARRIS**  
Associate  
+1 212 841 7633

[John.Harris@cushwake.com](mailto:John.Harris@cushwake.com)

# FLOOR PLAN

180 MADISON AVENUE

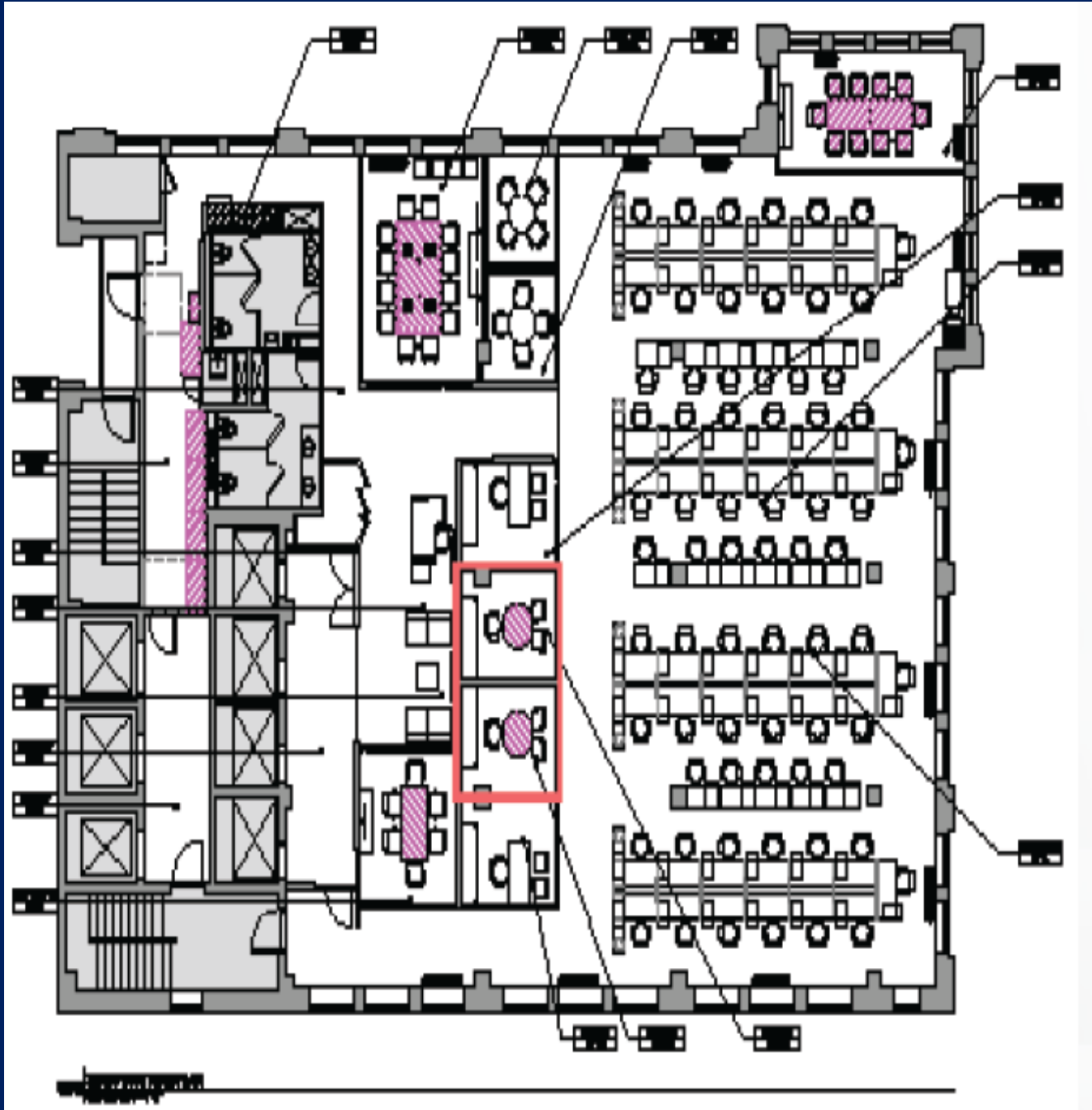

## Contact

ADAM ARDISE  
Vice Chairman  
+1 212 318 9741

[Adam.Ardise@cushwake.com](mailto:Adam.Ardise@cushwake.com)

STEPHEN BELLWOOD  
Senior Managing Director  
+1 212 318 9785

[Stephen.Bellwood@cushwake.com](mailto:Stephen.Bellwood@cushwake.com)

GORDON HOUGH  
Associate  
+1 212 895 8927

[Gordon.L.Hough@cushwake.com](mailto:Gordon.L.Hough@cushwake.com)

JOHN HARRIS  
Associate  
+1 212 841 7633

[John.Harris@cushwake.com](mailto:John.Harris@cushwake.com)