

20,703 SF

Industrial Space For Lease



Prologis Stemmons

1195 Empire Central
Dallas, TX 75247 USA

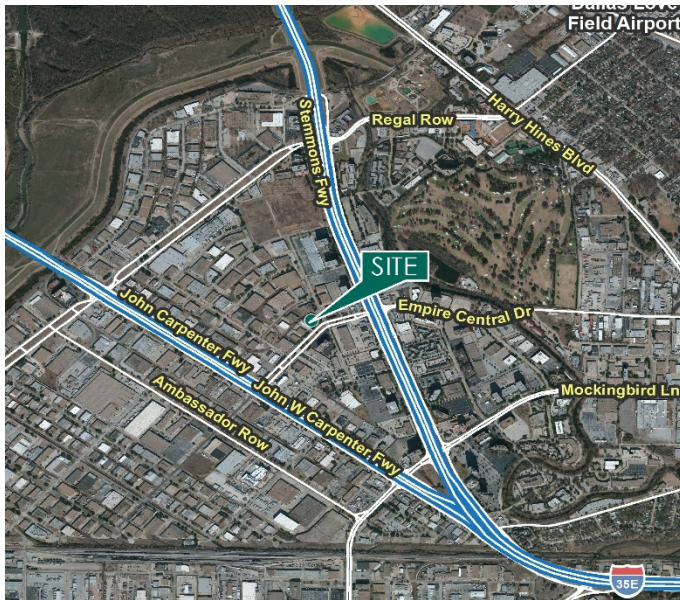

LOCATION

- Easy access to major highways including I-35E (0.3 mi.), TX-183 (0.4 mi.) and TX-12 (2.7 mi.)
- Ten minutes to Love Field

FACILITY

- 20,703 sf available
- ±3,500 sf office
- ±3,000 sf A/C production rooms
- 16' clear height
- 41' x 20' column spacing
- 2 (10' x 10') overhead dock doors
- 1 (10' x 12') overhead dock door with ramp
- 1,100 Amps of 480V 3-phase power

ADVANTAGES AND AMENITIES

- Floor drains for food grade user
- 26 parking spaces

20,703 SF

Industrial Space For Lease

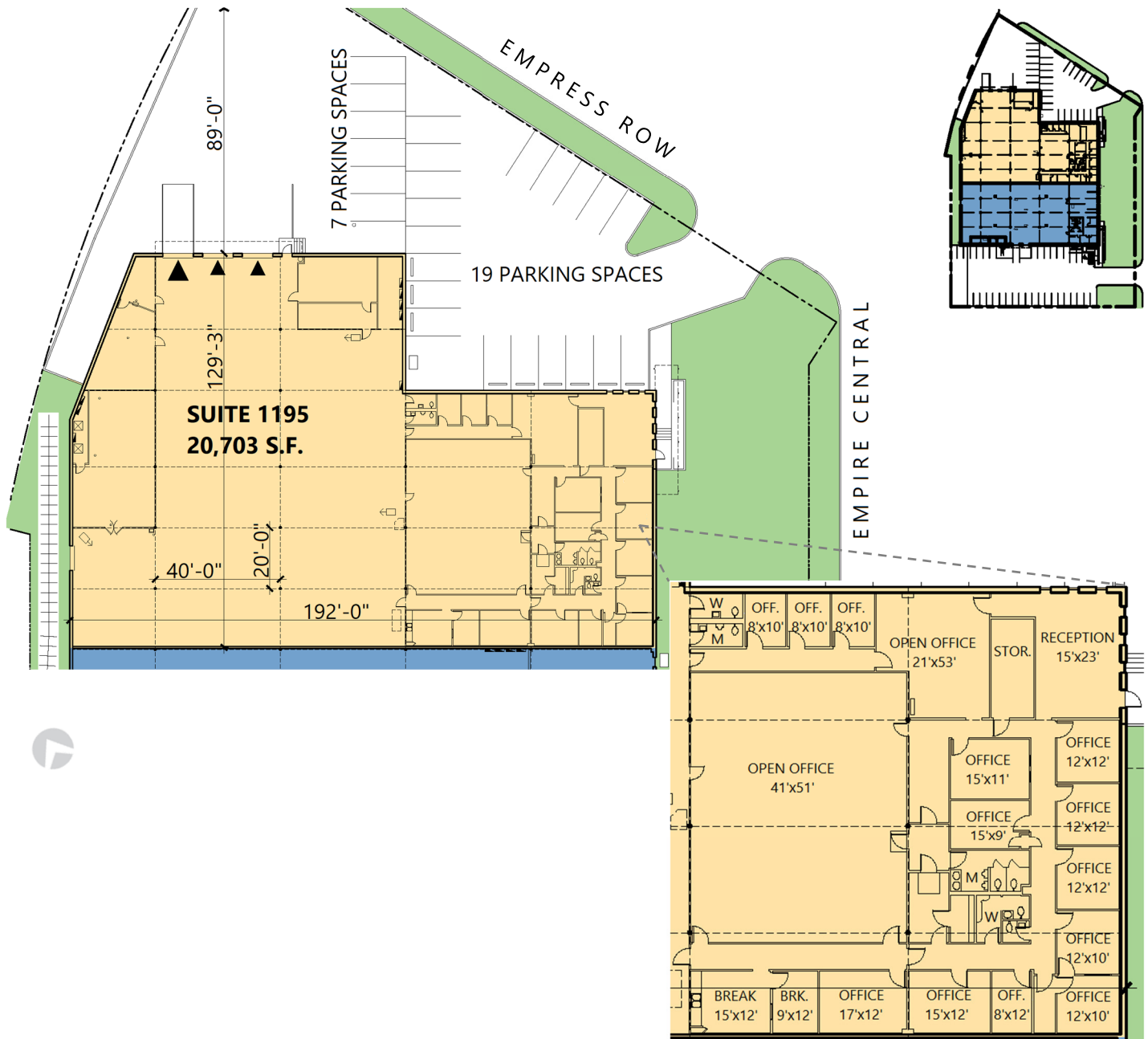

Lee & Associates

Adam Graham, SIOR, CCIM
agraham@lee-associates.com
ph +1 972 934 4011
cell +1 214 335 3320
15455 Dallas Parkway
Suite 400
Addison, TX 75201 USA

Lee & Associates

Stephen Williamson
swilliamson@lee-associates.com
ph +1 972 934 4045
cell +1 817 705 5470
15455 Dallas Parkway
Suite 400
Addison, TX 75201 USA

Prologis

Whitney Williamson
wwilliamson@prologis.com
ph +1 972 884 9244
cell +1 817 781 5186
2021 McKinney Avenue
Suite 1050
Dallas, TX 75201 USA