

# RETAIL SPACE FOR LEASE

**KOWIT & COMPANY**  
REAL ESTATE GROUP  
www.KowitRealEstate.com



## Property Highlights

- 2,800 SF of prominent retail space available in the heart of Woodmere Village
- Located in one of the busiest trade areas in Northeast Ohio
- Available: October 2018
- Less than half a mile away from Interstate 271
- High traffic counts on Chagrin Boulevard and surrounding streets/highways
- Nearby upscale tenants include Eton Collection and Village Square

## Demographics:

Estimated Population	Daytime Employees	Average HH Income
3 Miles: 45,331	3 Miles: 63,660	3 Miles: \$143,218
5 Miles: 176,768	5 Miles: 167,863	5 Miles: \$99,341
7 Miles: 364,737	7 Miles: 246,815	7 Miles: \$85,369



## Contact Agent:

**Amy Doroba**

216.514.1400 x124

adoroba@kowitzrealstate.com

# RETAIL SPACE FOR LEASE SITE PLAN

27879 Chagrin Blvd  
Woodmere Village, Ohio

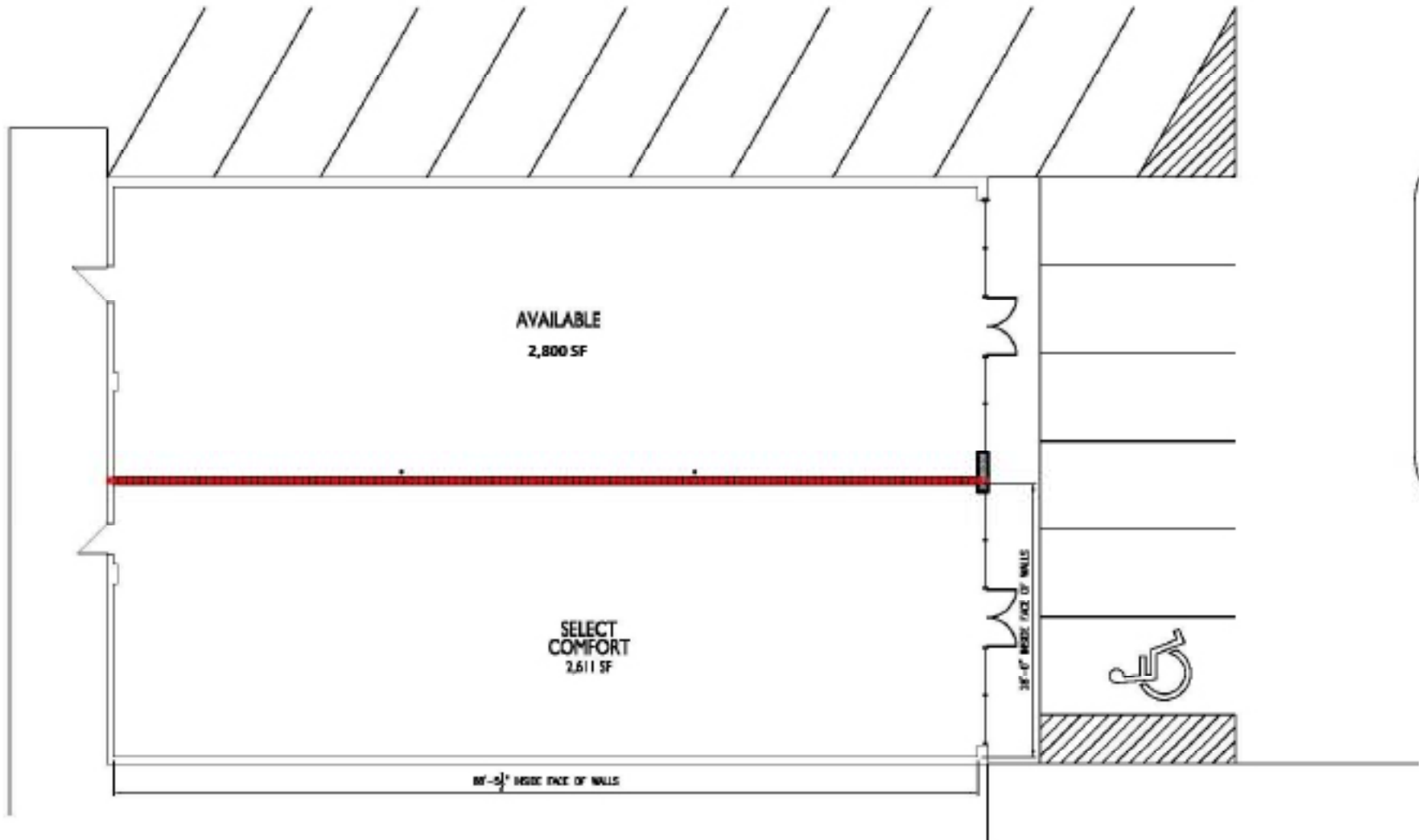

**KOWIT & COMPANY**  
REAL ESTATE GROUP

6009-B Landerhaven Drive, Suite B  
Mayfield Heights, Ohio 44124  
P: 216.514.1400 | [www.kowitrealestate.com](http://www.kowitrealestate.com)

**Contact Agents:**

**Amy Doroba**  
216.514.1400 x124  
[adoroba@kowitrealestate.com](mailto:adoroba@kowitrealestate.com)



# RETAIL SPACE FOR LEASE AERIAL

27879 Chagrin Blvd  
Woodmere Village, Ohio



**KOWIT & COMPANY**  
REAL ESTATE GROUP

6009-B Landerhaven Drive, Suite B  
Mayfield Heights, Ohio 44124  
P: 216.514.1400 | www.kowitrealestate.com

**Contact Agents:**

**Amy Doroba**  
216.514.1400 x124  
adoroba@kowitrealestate.com

# RETAIL SPACE FOR LEASE DEMOGRAPHICS

27879 Chagrin Blvd  
Woodmere Village, Ohio

27879 Chagrin Blvd Woodmere, OH 44122		3 mi radius	5 mi radius	7 mi radius
POPULATION	2018 Estimated Population	45,331	176,768	364,737
	2023 Projected Population	43,453	168,070	354,298
	2010 Census Population	46,309	182,438	375,453
	2000 Census Population	46,401	193,863	416,945
	Projected Annual Growth 2018 to 2023	-0.8%	-1.0%	-0.6%
	Historical Annual Growth 2000 to 2018	-0.1%	-0.5%	-0.7%
	2018 Median Age	44.7	42.1	41.1
HOUSEHOLDS	2018 Estimated Households	18,816	77,500	162,036
	2023 Projected Households	18,285	74,997	160,330
	2010 Census Households	18,575	77,082	160,736
	2000 Census Households	18,482	79,881	171,540
	Projected Annual Growth 2018 to 2023	-0.6%	-0.6%	-0.2%
	Historical Annual Growth 2000 to 2018	0.1%	-0.2%	-0.3%
RACE AND ETHNICITY	2018 Estimated White	59.4%	52.3%	45.5%
	2018 Estimated Black or African American	32.5%	41.1%	47.8%
	2018 Estimated Asian or Pacific Islander	5.5%	3.8%	3.9%
	2018 Estimated American Indian or Native Alaskan	0.1%	0.1%	0.1%
	2018 Estimated Other Races	2.4%	2.7%	2.6%
	2018 Estimated Hispanic	2.2%	2.3%	2.0%
INCOME	2018 Estimated Average Household Income	\$143,218	\$99,341	\$85,369
	2018 Estimated Median Household Income	\$101,868	\$72,541	\$62,232
	2018 Estimated Per Capita Income	\$60,094	\$43,780	\$38,085
EDUCATION (AGE 25+)	2018 Estimated Elementary (Grade Level 0 to 8)	1.4%	1.7%	1.9%
	2018 Estimated Some High School (Grade Level 9 to 11)	3.0%	4.7%	6.3%
	2018 Estimated High School Graduate	16.5%	21.9%	24.8%
	2018 Estimated Some College	18.5%	20.6%	21.3%
	2018 Estimated Associates Degree Only	5.9%	7.0%	7.1%
	2018 Estimated Bachelors Degree Only	24.8%	22.1%	19.8%
	2018 Estimated Graduate Degree	29.9%	22.0%	18.8%
BUSINESS	2018 Estimated Total Businesses	4,476	9,614	16,005
	2018 Estimated Total Employees	63,660	167,863	246,815
	2018 Estimated Employee Population per Business	14.2	17.5	15.4
	2018 Estimated Residential Population per Business	10.1	18.4	22.8



6009-B Landerhaven Drive, Suite B  
Mayfield Heights, Ohio 44124  
P: 216.514.1400 | www.kowitrealestate.com

**Contact Agents:**

**Amy Doroba**  
216.514.1400 x124  
adoroba@kowitrealestate.com



# RETAIL SPACE FOR LEASE AREA MAP

27879 Chagrin Blvd  
Woodmere Village, Ohio

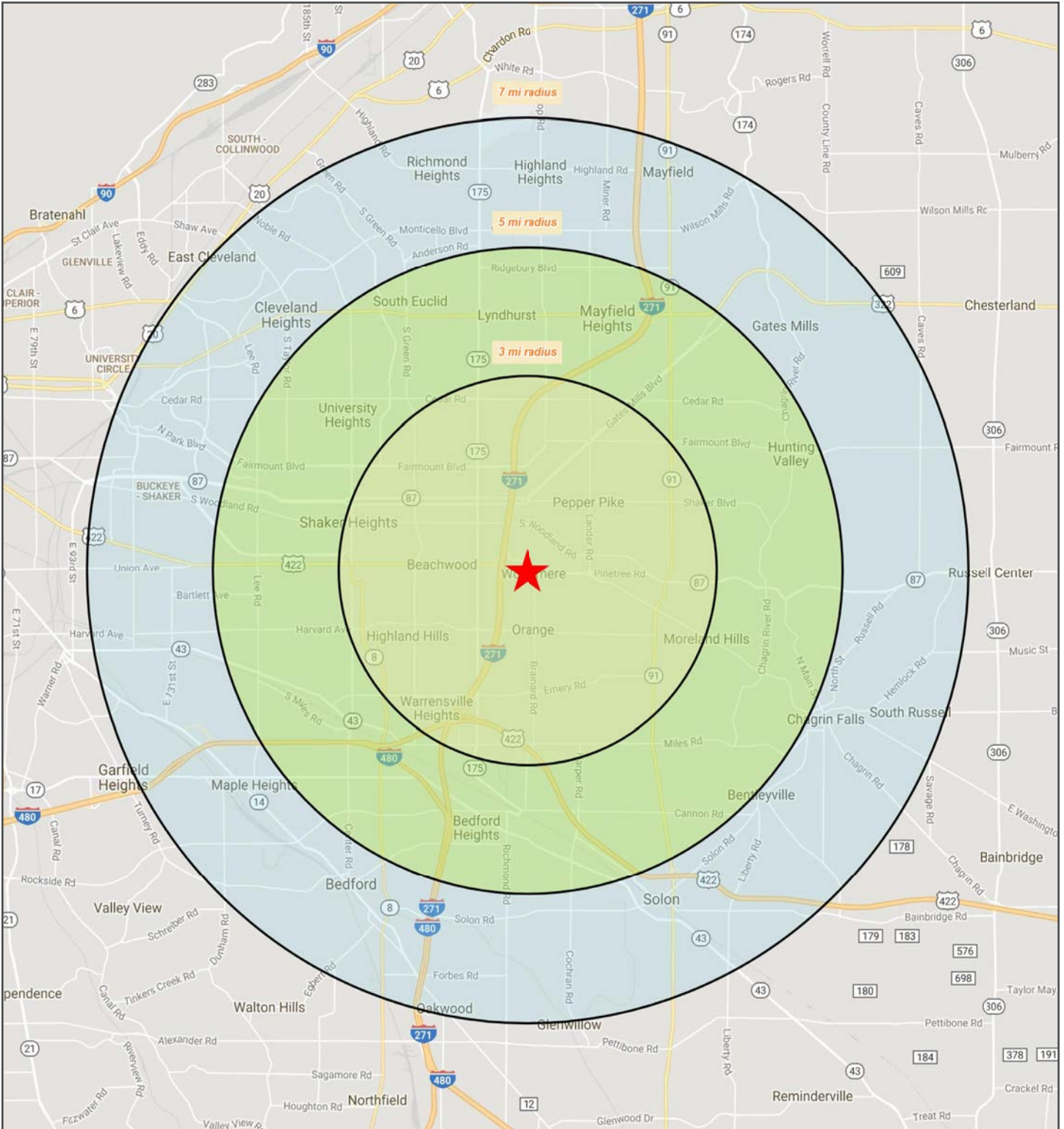

**KOWIT & COMPANY**  
REAL ESTATE GROUP

6009-B Landerhaven Drive, Suite B  
Mayfield Heights, Ohio 44124  
P: 216.514.1400 | [www.kowitrealestate.com](http://www.kowitrealestate.com)

**Contact Agents:**

**Amy Doroba**  
216.514.1400 x124  
[adoroba@kowitrealestate.com](mailto:adoroba@kowitrealestate.com)