

Willows III Building

14712 NE 91st Street,
Redmond, WA

Suite 100: 3,980 SF
(1,965 SF office and
2,015 SF warehouse)

Excellent Willows location with
visibility from Willows Road

Minutes from SR-520 and I-405

Multiple private offices,
conference room and break area
(see floorplan on reverse)

3-phase power, 14' clear height
and grade level loading

Video surveillance, security
and phone system equipment
available

Lease rates:

\$1.30/SF, NNN Office

\$0.60/SF, NNN Warehouse



Location

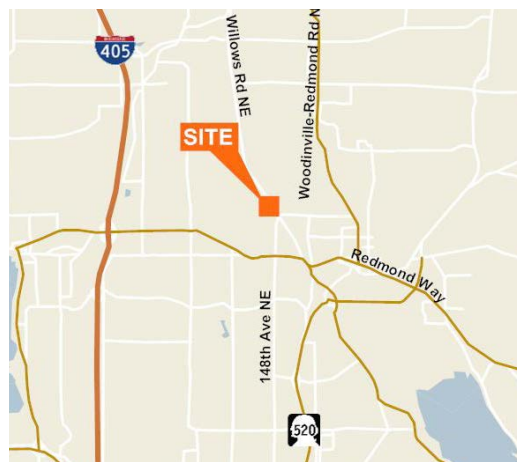

Contact

Zach Vall-Spinosa

425.450.1115

zachv@kiddermathews.com

James Leptich

425.450.1159

jleptich@kiddermathews.com

Willows Road Building

Suite 100

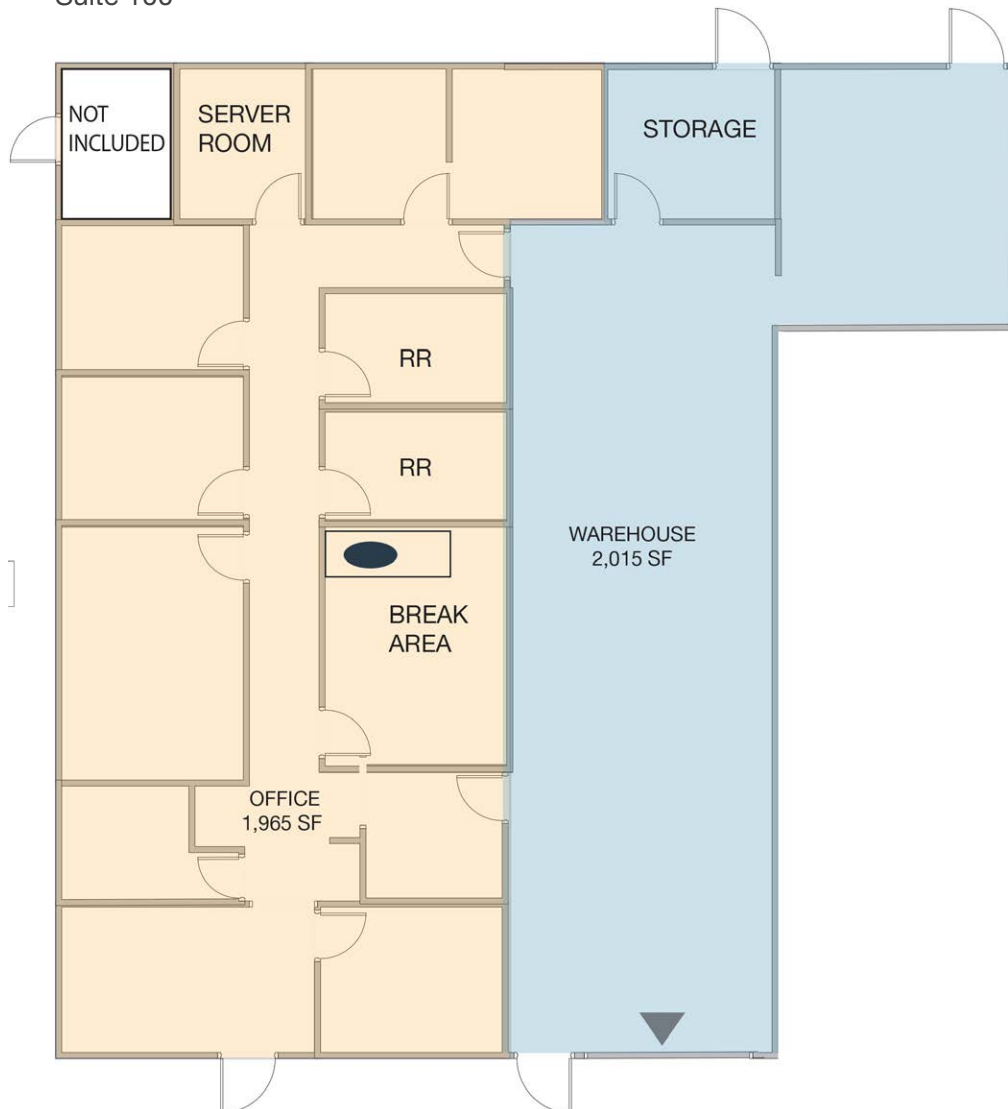

* Not to scale

Contact

Zach Vall-Spinosa
425.450.1115
zachv@kiddermathews.com

James Leptich
425.450.1159
jleptich@kiddermathews.com