

Spruce Business Center

1558 E Spruce / Olathe, KS

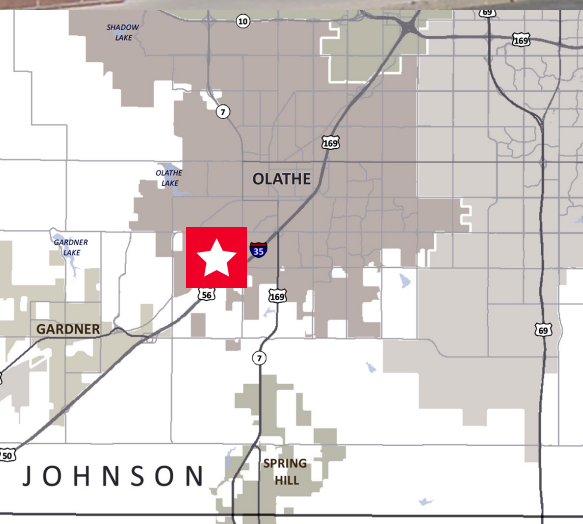

±1,800 SF Industrial Space
Lease Rate: \$8.50 PSF Gross Industrial

Property Highlights

- ±1,000 SF office area
- One (1) double man door
- 16' clear height
- Built in 1987
- Excellent access to Interstate 35

Joseph S. Accurso, SIOR
Executive Director
+1 816 412 0216
joe.accurso@cushwake.com

Jack Goldsborough, CCIM
Associate
+1 816 412 0326
jack.goldsborough@cushwake.com

4600 Madison Avenue, Suite 800
Kansas City, MO 64112
Main +1 816 221 2200
Fax +1 816 842 2798
cushmanwakefield.com

Floor Plan

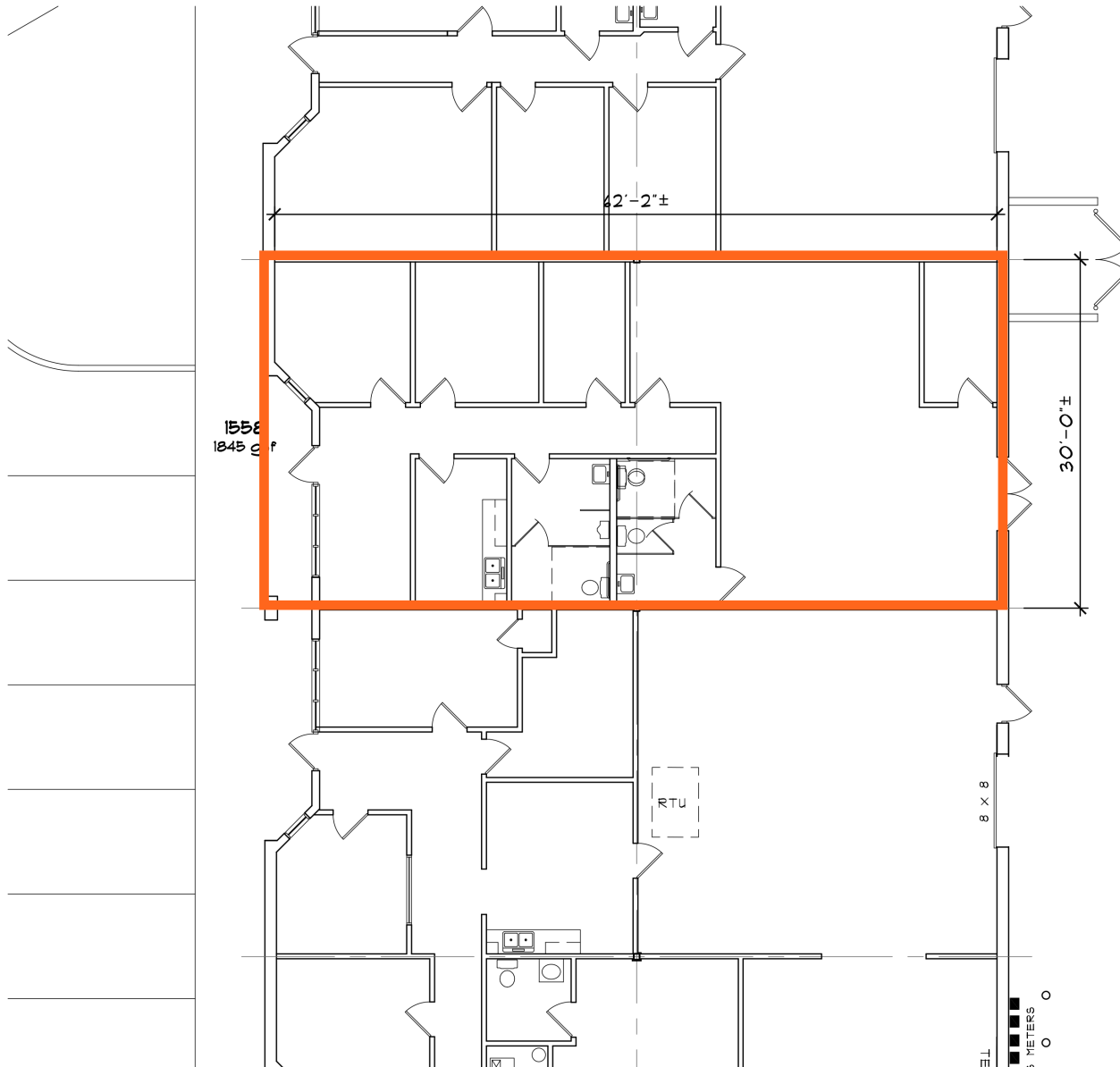

Building Features

Construction Type:	Cherokee Block
Floor Type:	6' Poured Concrete
Roof Type:	Single-Ply Membrane
Electrical:	200 Amp, 3 Phase
Lighting:	Fluorescent Tubes
Heat Type:	Overhead Gas Fired Units
Parking:	2 Per 1,000



FOR LEASE

Spruce Business Center

1558 E Spruce / Olathe, KS

Aerial

