

469 Route 17

Paramus, New Jersey

Availability

- +/- 3,434 SF (Former Restaurant)
- +/- 12,481 SF (Available 11/1/20)

Traffic Counts

- 147,199 VPD

Site Description

- Site is situated along the heavily traveled Route 17 corridor with over 147,000 vehicles passing the site daily; less than a mile from the Garden State Parkway
- Pylon sign slots available along the highway. The site also provides for ample parking with 146 spaces surrounding the building on 3 sides
- Strong median income levels at over \$124,000 within 2 miles
- Paramus is one of the largest retail markets in the United States, drawing shoppers from all over New Jersey, Rockland County New York and New York City while generating billions of dollars in sales

Demographics

Radius	Population	Total Daytime Population	Median HH Income
1 Mile	6,566	21,108	\$114,843
2 Mile	38,750	53,228	\$124,289
3 Mile	111,814	141,340	\$127,661

Retail for Lease - Contact

Jason Pierson
Ph. 732-707-6900 x1
jason@piersonre.com

Gregg Medvin
Ph. 732-707-6900 x3
gregg@piersonre.com

PIERSON
COMMERCIAL REAL ESTATE.®

469 Route 17 Paramus, New Jersey



Retail for Lease - Contact

Jason Pierson
Ph. 732-707-6900 x1
jason@piersonre.com

Gregg Medvin
Ph. 732-707-6900 x3
gregg@piersonre.com

PIERSON
COMMERCIAL REAL ESTATE.

469 Route 17 Paramus, New Jersey

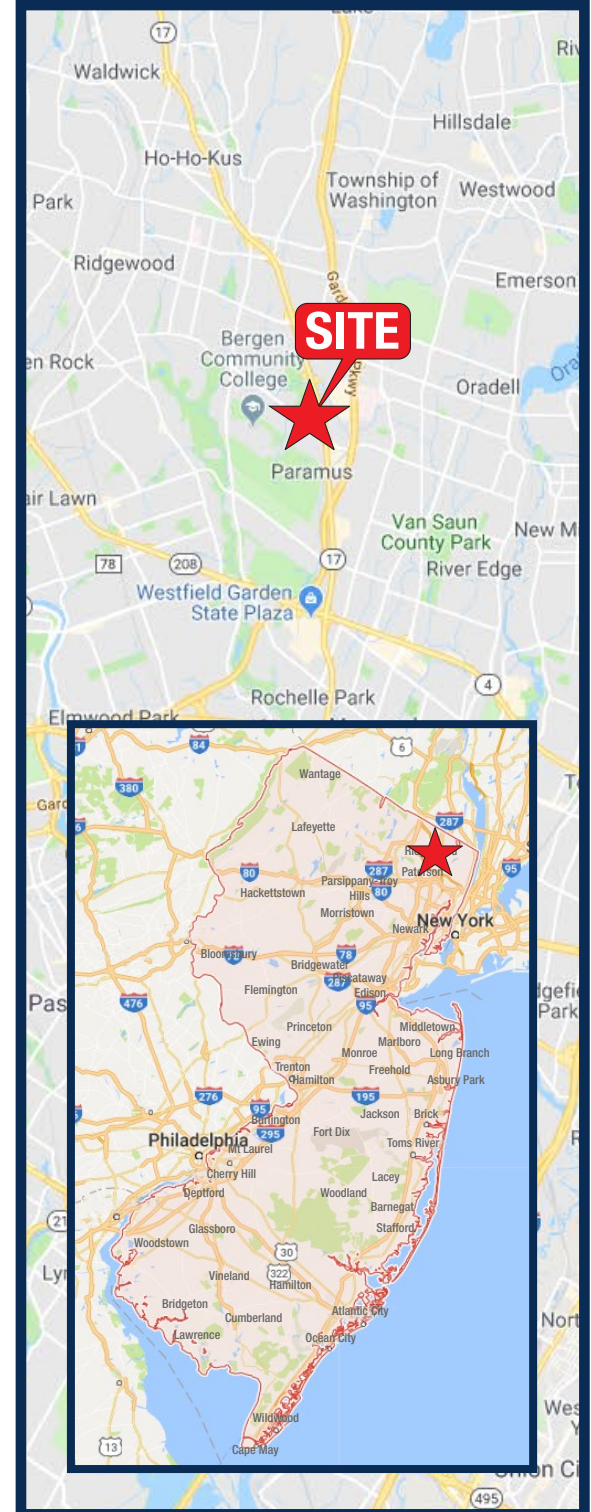
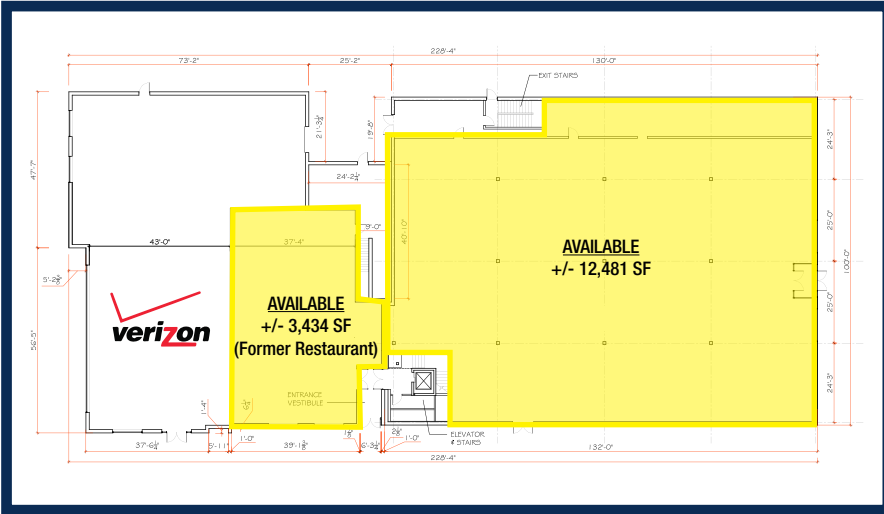

Retail for Lease - Contact

Jason Pierson
Ph. 732-707-6900 x1
jason@piersonre.com

Gregg Medvin
Ph. 732-707-6900 x3
gregg@piersonre.com

PIERSON
COMMERCIAL REAL ESTATE