

Kent 228

22615 83rd Avenue South
Building B
Kent, WA

Approx 31,365 SF total

Approx 2,020 SF office

24' clear-height

Excellent access to SR-167

Well maintained park

5 dock-high doors

1 drive-in

M-3 zoning

\$0.42 / \$0.75, NNN

Available July 1, 2015



Location



Contact

Christopher J. Corr, SIOR

206.248.7324

ccorr@kiddermathews.com

Matt Wood, SIOR

206.248.7306

mwood@kiddermathews.com

Kent 228

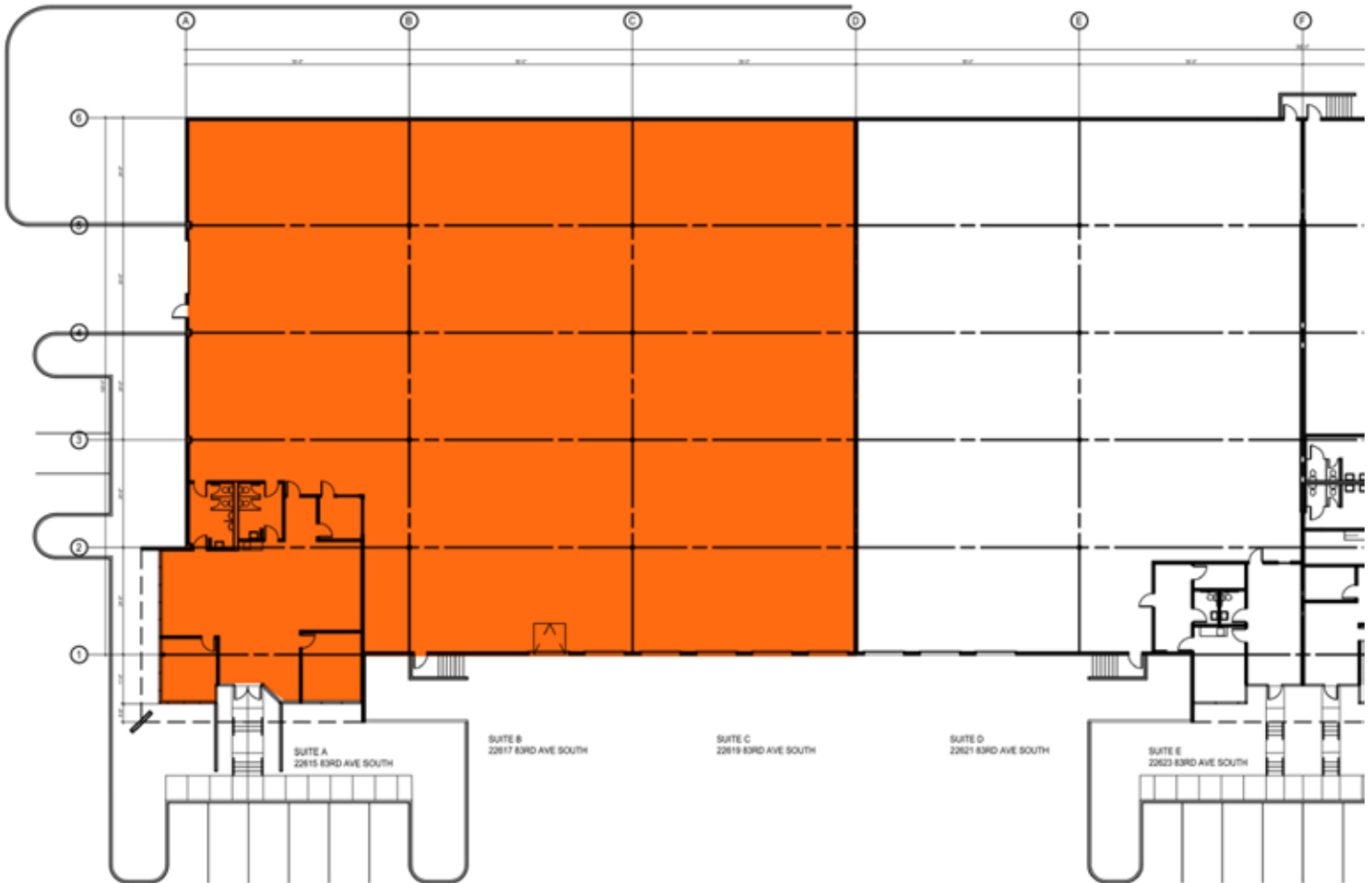

Contact

Christopher J. Corr, SIOR
206.248.7324
ccorr@kiddermathews.com

Matt Wood, SIOR
206.248.7306
mwood@kiddermathews.com