

PRIME RETAIL SPACE ADJACENT TO KOHL'S

Cary, NC 27518 | 2350 Walnut Street | Walnut St & Dillard Dr | #465



AVAILABLE SF:
24,700 SF

FRONTAGE:
APPROX 98'1"

ZONING:
COMMERCIAL

RATES:
CALL FOR DETAILS

AREA ANCHORS



- Located in the dominant Super Regional Shopping district on Cary, at the intersection of US 1 and I-440.
- 176,000 AADT at the Walnut Street - US 1 interchange
- Co-Tenants include Bj's Wholesale, Joann Fabrics, PetSmart, Cost Plus World Market, Panera Bread, and others.
- Other retailers in immediate area include: Lowes, Home Depot, REI, Michaels, Marshalls, DSW, Best Buy, Bed Bath and Beyond, Dicks Sporting Goods, and HomeGoods.

DEMOGRAPHICS	1 MILE	3 MILES	5 MILES	TRAFFIC COUNTS	
2018 Population Density	9,794	71,233	173,482	Highway 1	138,000 AADT
2018 Daytime Population	10,701	42,927	108,442	Walnut St	38,000 AADT
2018 Average HH Income	\$83,228	\$88,304	\$92,893		
2018 Median HH Income	\$65,905	\$61,367	\$65,215		



FOR MORE INFORMATION, CONTACT EXCLUSIVE AGENT(S):
JEFF NIMMER, CCIM • jeff.nimmer@tscg.com • 919.380.8041
TYLER QUINN • tyler.quinn@tscg.com • 919.380.8041
TAYLOR DROUILLARD • taylor.drouillard@tscg.com • 919.380.8041

Demographics: Esri 2018 No warranty expressed or implied has been made as to the accuracy of the information provided herein, no liability assumed for error or omissions.



PRIME RETAIL SPACE ADJACENT TO KOHL'S

Cary, NC 27518 | 2350 Walnut Street | Walnut St & Dillard Dr | #465



FOR MORE INFORMATION, CONTACT EXCLUSIVE AGENT(S):
 JEFF NIMMER, CCIM • jeff.nimmer@tscg.com • 919.380.8041
 TYLER QUINN • tyler.quinn@tscg.com • 919.380.8041
 TAYLOR DROUILLARD • taylor.drouillard@tscg.com • 919.380.8041



Demographics: Esri 2018 No warranty expressed or implied has been made as to the accuracy of the information provided herein, no liability assumed for error or omissions.

PRIME RETAIL SPACE ADJACENT TO KOHL'S

Cary, NC 27518 | 2350 Walnut Street | Walnut St & Dillard Dr | #465

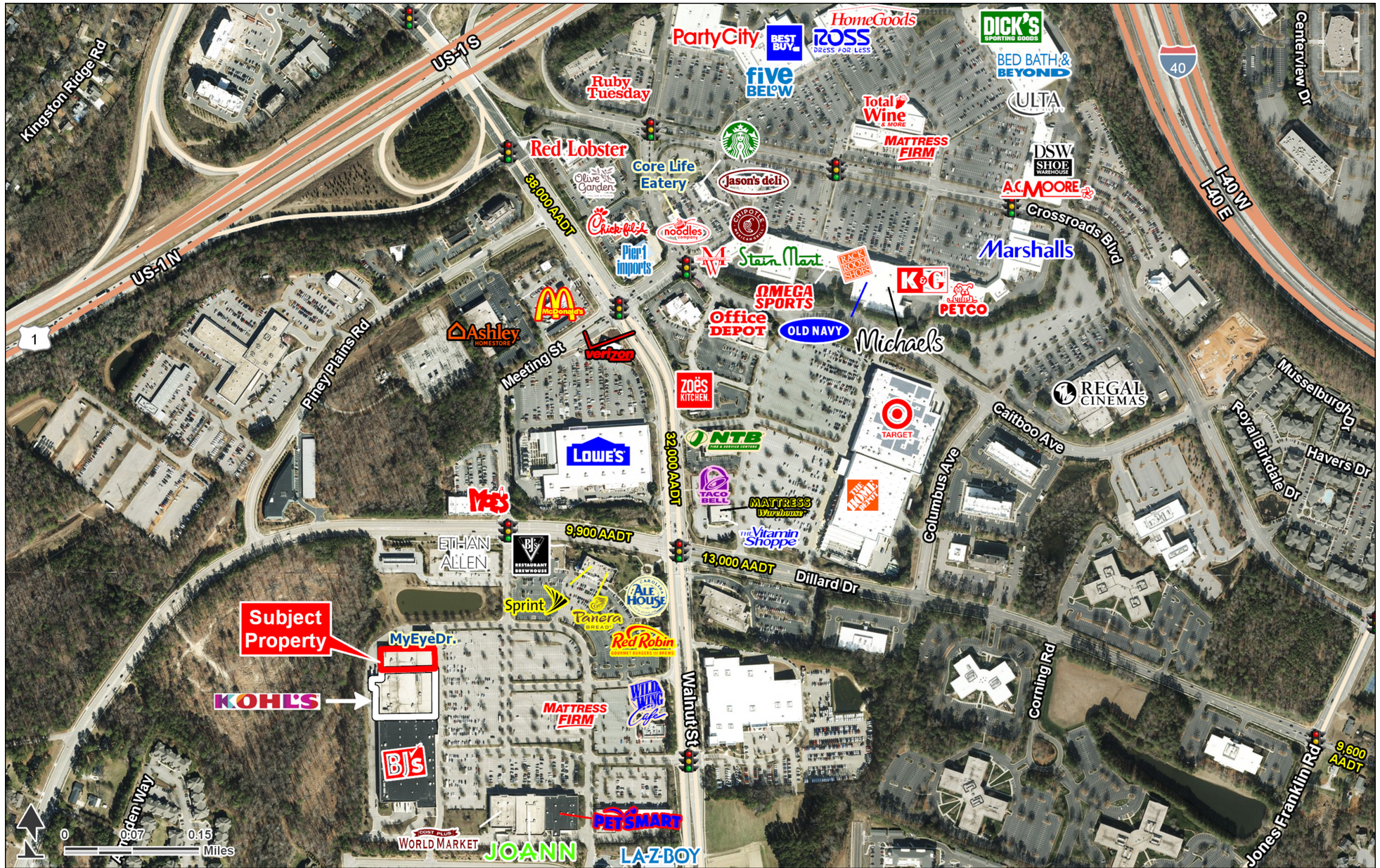

FOR MORE INFORMATION, CONTACT EXCLUSIVE AGENT(S):
 JEFF NIMMER, CCIM • jeff.nimmer@tscg.com • 919.380.8041
 TYLER QUINN • tyler.quinn@tscg.com • 919.380.8041
 TAYLOR DROUILLARD • taylor.drouillard@tscg.com • 919.380.8041

Demographics: Esri 2018 No warranty expressed or implied has been made as to the accuracy of the information provided herein, no liability assumed for error or omissions.



PRIME RETAIL SPACE ADJACENT TO KOHL'S

Cary, NC 27518 | 2350 Walnut Street | Walnut St & Dillard Dr | #465

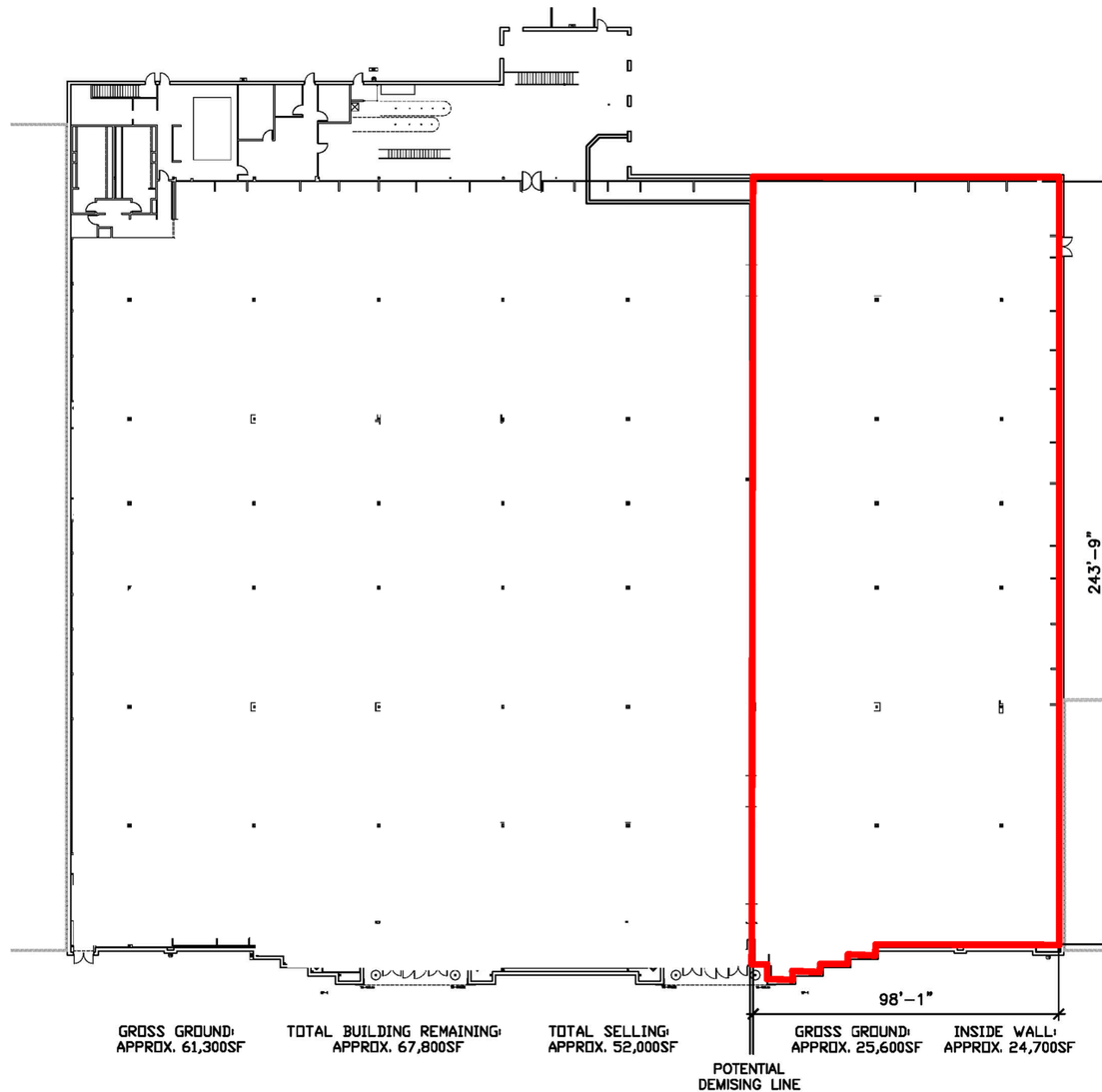

#10465 Cary Crossing, NC
Updated: 4/17/18



FOR MORE INFORMATION, CONTACT EXCLUSIVE AGENT(S):

JEFF NIMMER, CCIM • jeff.nimmer@tscg.com • 919.380.8041

TYLER QUINN • tyler.quinn@tscg.com • 919.380.8041

TAYLOR DROUILLARD • taylor.drouillard@tscg.com • 919.380.8041

Demographics: Esri 2018 No warranty expressed or implied has been made as to the accuracy of the information provided herein, no liability assumed for error or omissions.

