

# 736 Beachland Boulevard

Vero Beach, FL



## Opportunity

Beachland Commercial building is conveniently located on the south side of Beachland Boulevard just east of the A1A intersection in Vero Beach, Florida

- 1,665 sf
- Great beachside location on busy street with traffic count of 9,200 ADT.
- Well maintained property offers great street visibility, signage, and ample parking providing easy access to the unit.
- Currently built out with reception, conference room, and private offices.
- Available immediately.

## Rate

- \$25 per sf / Modified Gross

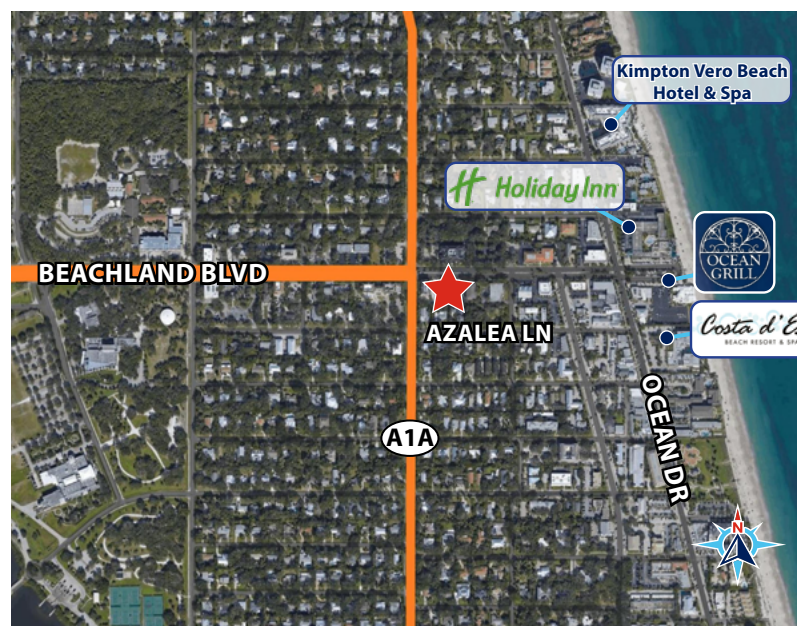

**Derek Arden**, Senior Associate  
561 209 2711  
derek.arden@avisonyoung.com



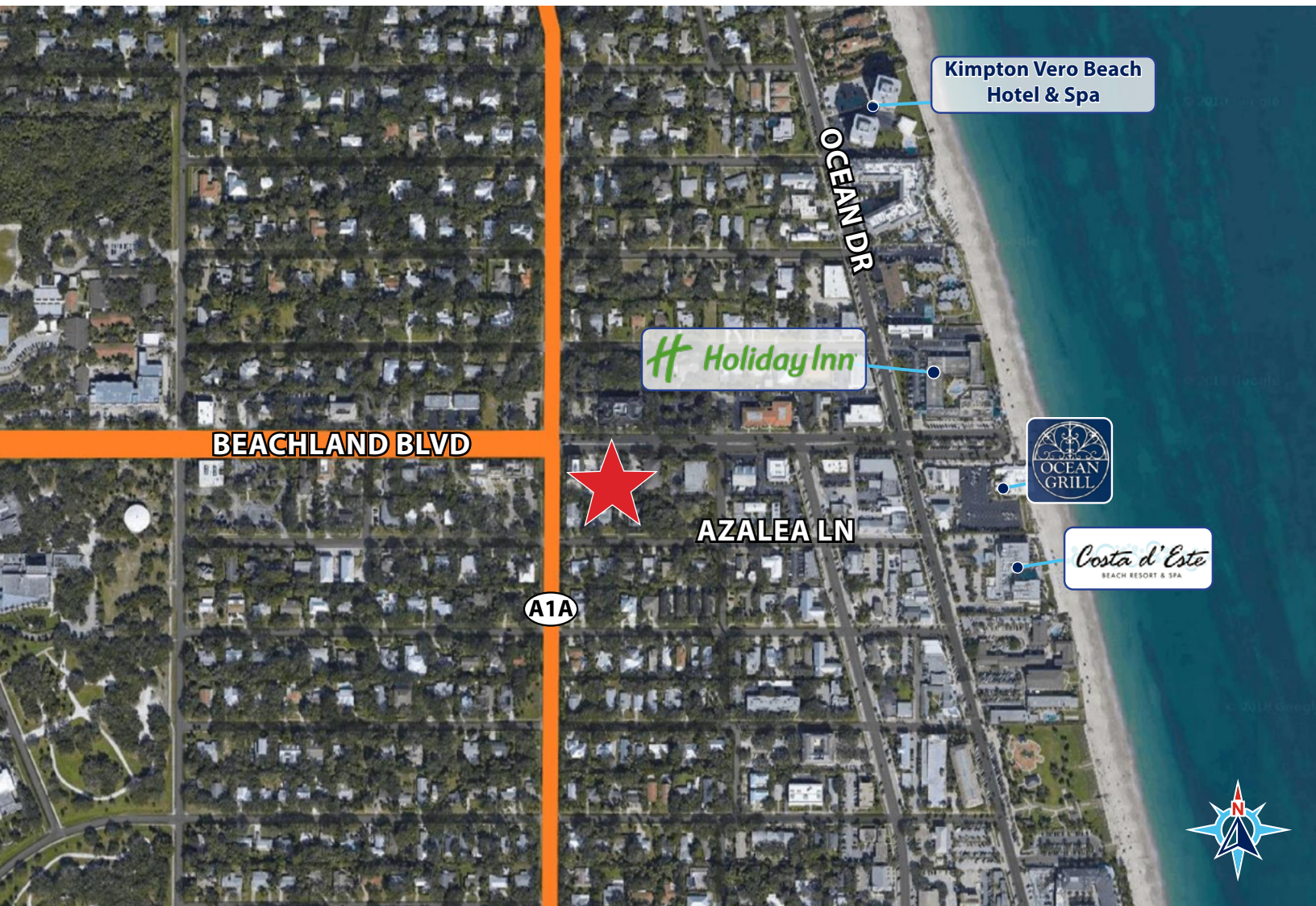

## Property Highlights



**12 minutes**  
from Vero Beach  
Regional Airport



**5 minute**  
walking distance  
to the Beach



**Daytime**  
Population  
24,597



**Average HH**  
Income  
\$87,222

**AVISON  
YOUNG**

[avisonyoung.com](http://avisonyoung.com)

**Derek Arden**, Senior Associate  
561 209 2711  
[derek.arden@avisonyoung.com](mailto:derek.arden@avisonyoung.com)