

FOR LEASE

# 25 HANOVER ROAD CORPORATE CENTER

25 Hanover Road, Florham Park, NJ 07932



## FEATURES

- Recently renovated building lobbies and newly landscaped
- Walking distance to downtown Florham Park, access to a wide variety of shops and restaurants
- On-site management
- Full service cafe with outdoor seating
- Parking ratio of 5 cars per 1,000 sq. ft.
- New fitness center and conference center
- Close proximity to Routes 24, 10, I-78, I-287 and I-280
- 15 minutes to Newark Liberty International Airport

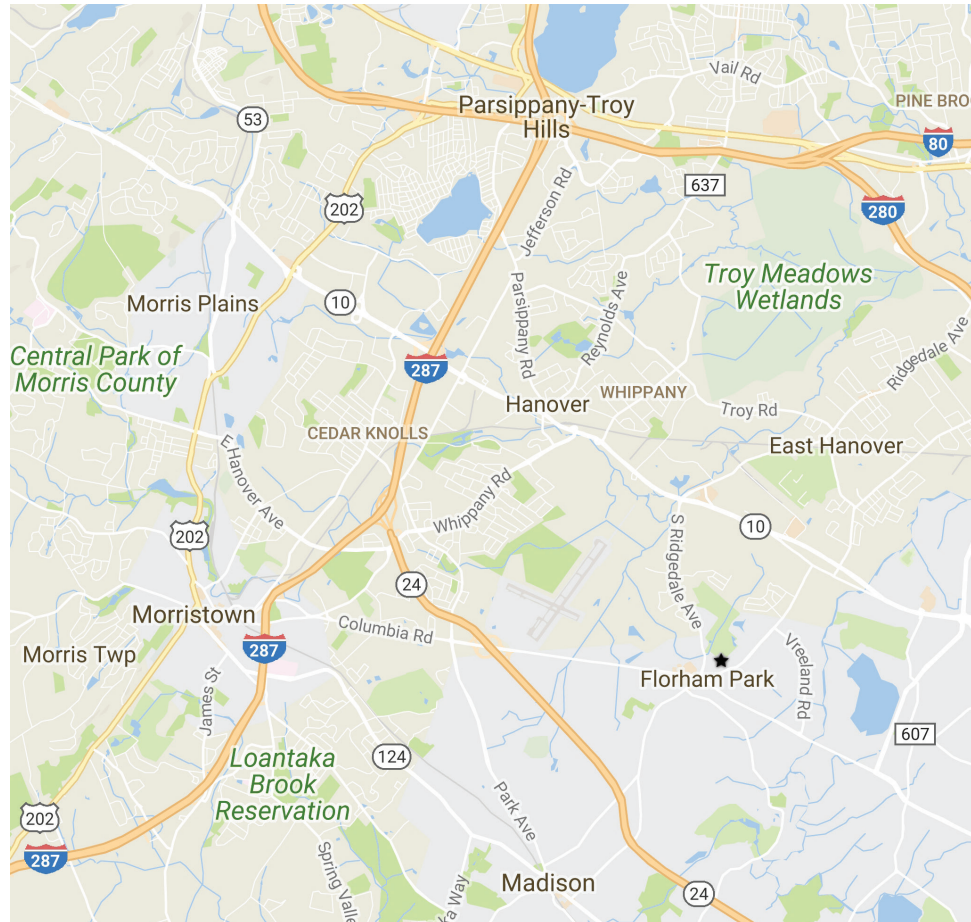

25 HANOVER ROAD  
BUILDING B

PARTIAL 2nd FLOOR 5,816 RSF  
(Divisible as per plan below)

**BUILDING B** 65,311 TOTAL SF

2nd Floor - 5,816 RSF - Divisible

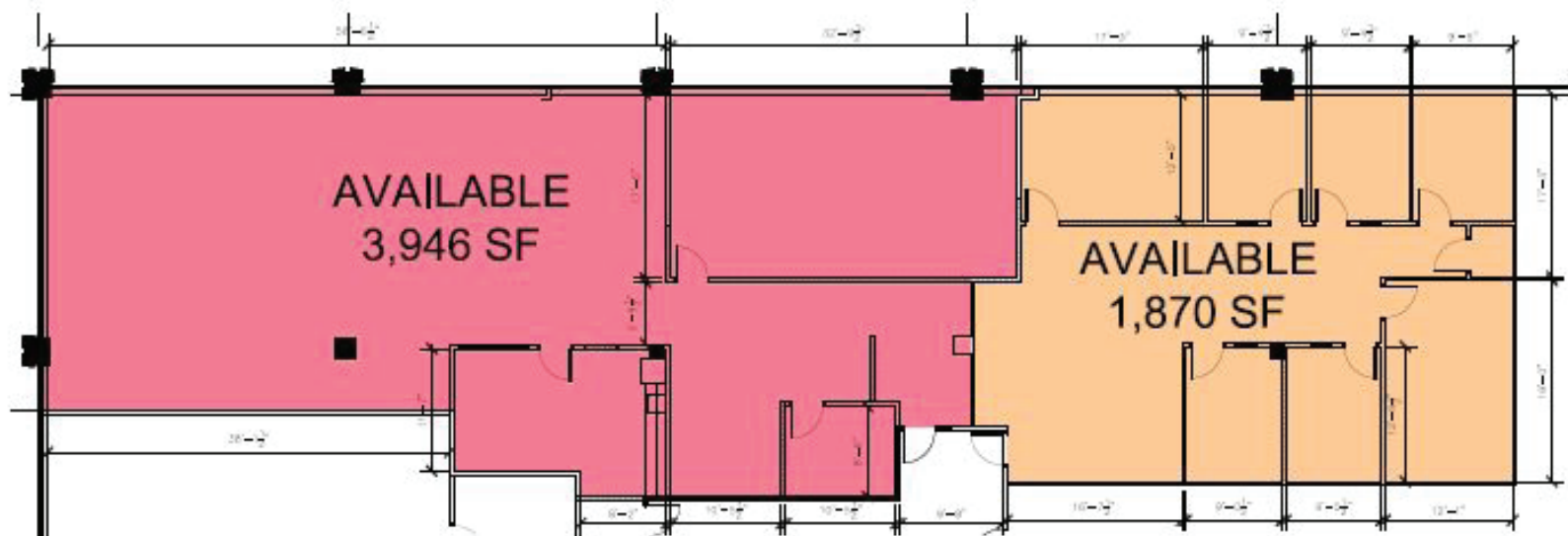

# 25 HANOVER ROAD CORPORATE CENTER

---

## PLEASE CONTACT:

### Peter N. Shikar

First Vice President  
+1 732 509 8915  
peter.shikar@cbre.com  
Lic. 0564752

### Owned & Managed



© 2020 CBRE, Inc. All rights reserved. This information has been obtained from sources believed reliable, but has not been verified for accuracy or completeness. You should conduct a careful, independent investigation of the property and verify all information. Any reliance on this information is solely at your own risk. CBRE and the CBRE logo are service marks of CBRE, Inc. All other marks displayed on this document are the property of their respective owners, and the use of such logos does not imply any affiliation with or endorsement of CBRE. Photos herein are the property of their respective owners. Use of these images without the express written consent of the owner is prohibited.

25 HANOVER ROAD, FLORHAM PARK, NJ 07932