

1,400 -6,239 SF of Office Space | 2 Outlots Available

Columbia Woods Health & Wellness Building

3300 Greenwich Road | Norton, OH | 44203



Dan McCall
330.344.9136
dmccall@albrechtinc.com

ALBRECHT
INCORPORATED

17 S. MAIN STREET, AKRON, OH 44308 | 330.376.6611 | ALBRECHTINC.COM

1,400 - 6,239 SF of Office Space | 2 Outlots Available

Columbia Woods Health & Wellness Building

3300 Greenwich Road | Norton, OH | 44203



Dan McCall
330.344.9136
dmccall@albrechtinc.com

ALBRECHT
INCORPORATED

17 S. MAIN STREET, AKRON, OH 44308 | 330.376.6611 | ALBRECHTINC.COM

1,400 - 6,239 SF of Office Space | 2 Outlots Available

Columbia Woods Health & Wellness Building

3300 Greenwich Road | Norton, OH | 44203

TENANT NAME	UNIT NUMBER	UNIT SIZE (SF)
Snap Fitness	1	5,161
Available (Divisible)	2	6,239
Pioneer Physicians	3	5,550
US Renal Care	4	1,506
Available (Divisible)	5	3,573
The Medicine Shoppe	6	1,920
Peoples Bank	7	Not a Part
Available (Outlot)	8	.94 Acres
Available (Outlot)	9	.49 Acres

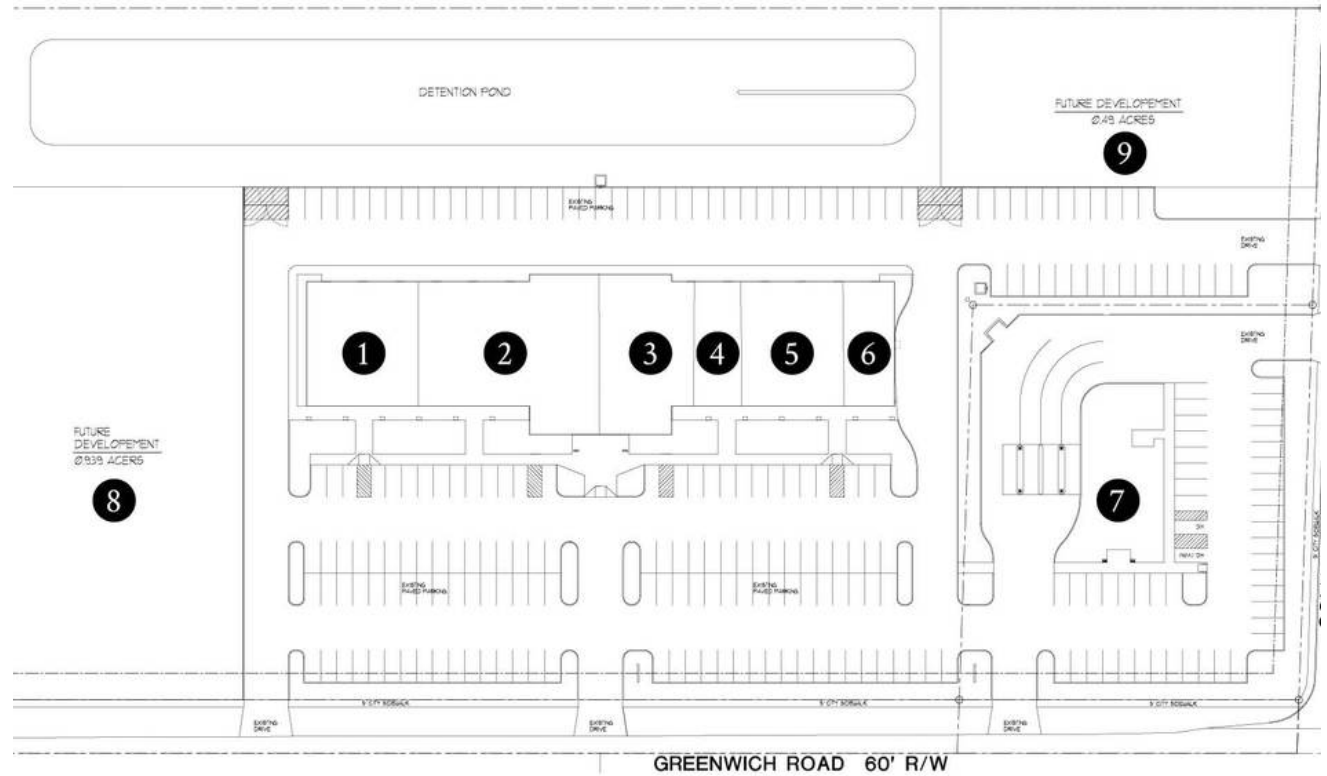

1,400 - 6,239 SF of Office Space | 2 Outlots Available

Columbia Woods Health & Wellness Building

3300 Greenwich Road | Norton, OH | 44203

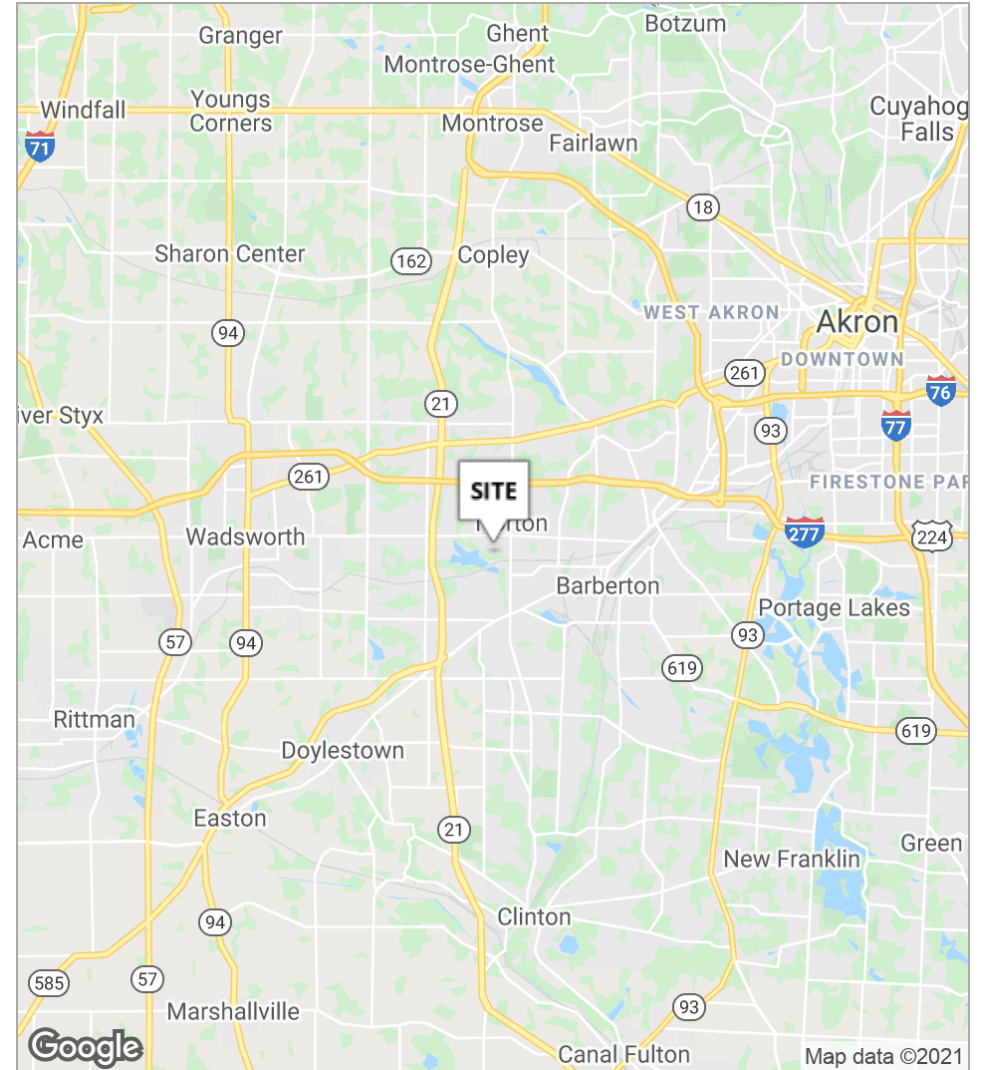

Dan McCall
330.344.9136
dmccall@albrechtinc.com

ALBRECHT
INCORPORATED

17 S. MAIN STREET, AKRON, OH 44308 | 330.376.6611 | ALBRECHTINC.COM

1,400 - 6,239 SF of Office Space | 2 Outlots Available

Columbia Woods Health & Wellness Building

3300 Greenwich Road | Norton, OH | 44203

	1 MILE	5 MILES	10 MILES
Total households	887	31,734	136,567
Total persons per hh	2.4	2.4	2.4
Average hh income	\$58,588	\$54,204	\$58,702
Average house value		\$143,521	\$183,796

	1 MILE	5 MILES	10 MILES
Total population	2,172	77,652	330,767
Median age	44.1	41.0	39.7
Median age (male)	43.3	39.2	38.0
Median age (female)	44.3	42.5	41.1

	1 MILE	5 MILES	10 MILES
Total population - White / % White	2,129 / 98.0%	70,462 / 90.7%	255,650 / 77.3%
Total population - Black / % Black	16 / 0.7%	5,396 / 6.9%	62,872 / 19.0%
Total population - Asian / % Asian	4 / 0.2%	368 / 0.5%	4,519 / 1.4%
Total population - Hawaiian / % Hawaiian	0 / 0.0%	0 / 0.0%	50 / 0.0%
Total population - Indian / % Indian	0 / 0.0%	111 / 0.1%	430 / 0.1%
Total population - Other / % Other	2 / 0.1%	147 / 0.2%	1,639 / 0.5%

	1 MILE	5 MILES	10 MILES
Total population - Hispanic	18 / 0.8%	1,000 / 1.3%	5,340 / 1.6%

* Demographic data derived from 2010 US Census