

Wood Village Town Center

NE Glisan & 223rd in Wood Village, OR

Price: \$1,145,000

Freestanding 2 tenant drive-thru restaurant building and shop space

3,194 SF vacant restaurant space

1,160 SF unimproved shop space

4,354 SF total building size situated on 40,581 SF of land

Located on a dominant pad site at the NE Glisan Street entry to the shopping center

Wood Village Town Center serves the Gresham, Troutdale, Fairview and Wood Village trade areas

Traffic Counts

NE 223rd Avenue: 31,011 cars/day

NE Glisan Street: 28,016 cars/day



Location

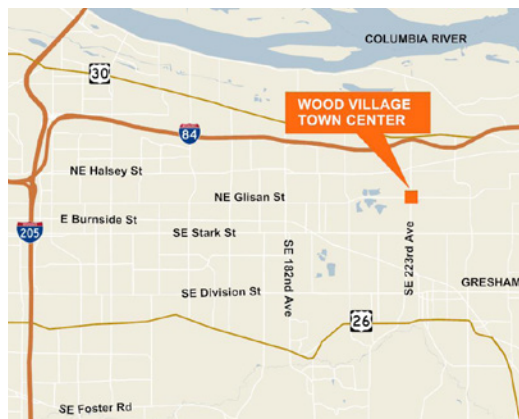

Contact

Corine Nussmeier

Vice President

503.721.2724

corinen@kiddermathews.com

Sara Daley

Senior Associate

503.721.2726

sdaley@kiddermathews.com

Ryan O'Leary

Vice President

503.221.2294

roleary@kiddermathews.com

Wood Village Town Center

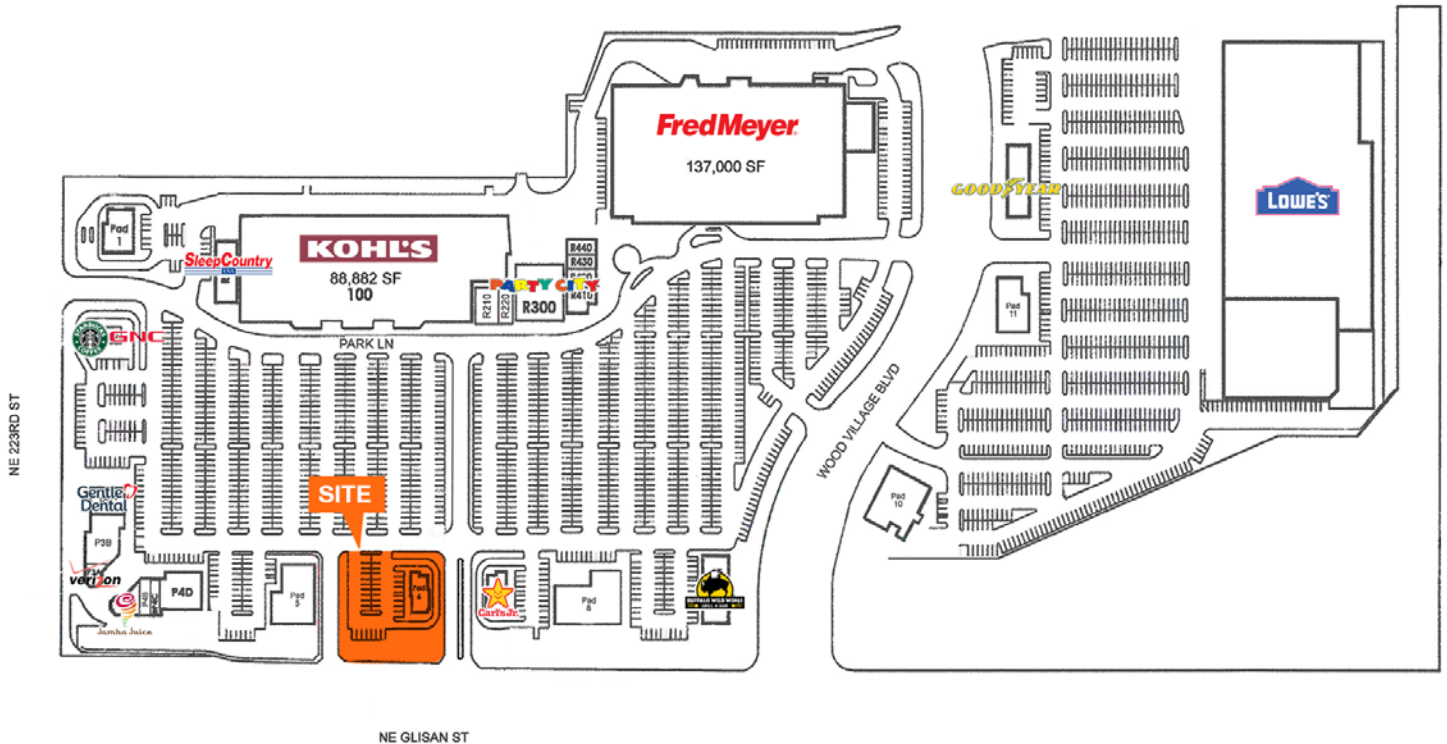

Contact

Corine Nussmeier
Vice President
503.721.2724
corinen@kiddermathews.com

Sara Daley
Senior Associate
503.721.2726
sdaley@kiddermathews.com

Ryan O'Leary
Vice President
503.221.2294
roleary@kiddermathews.com

Wood Village Town Center

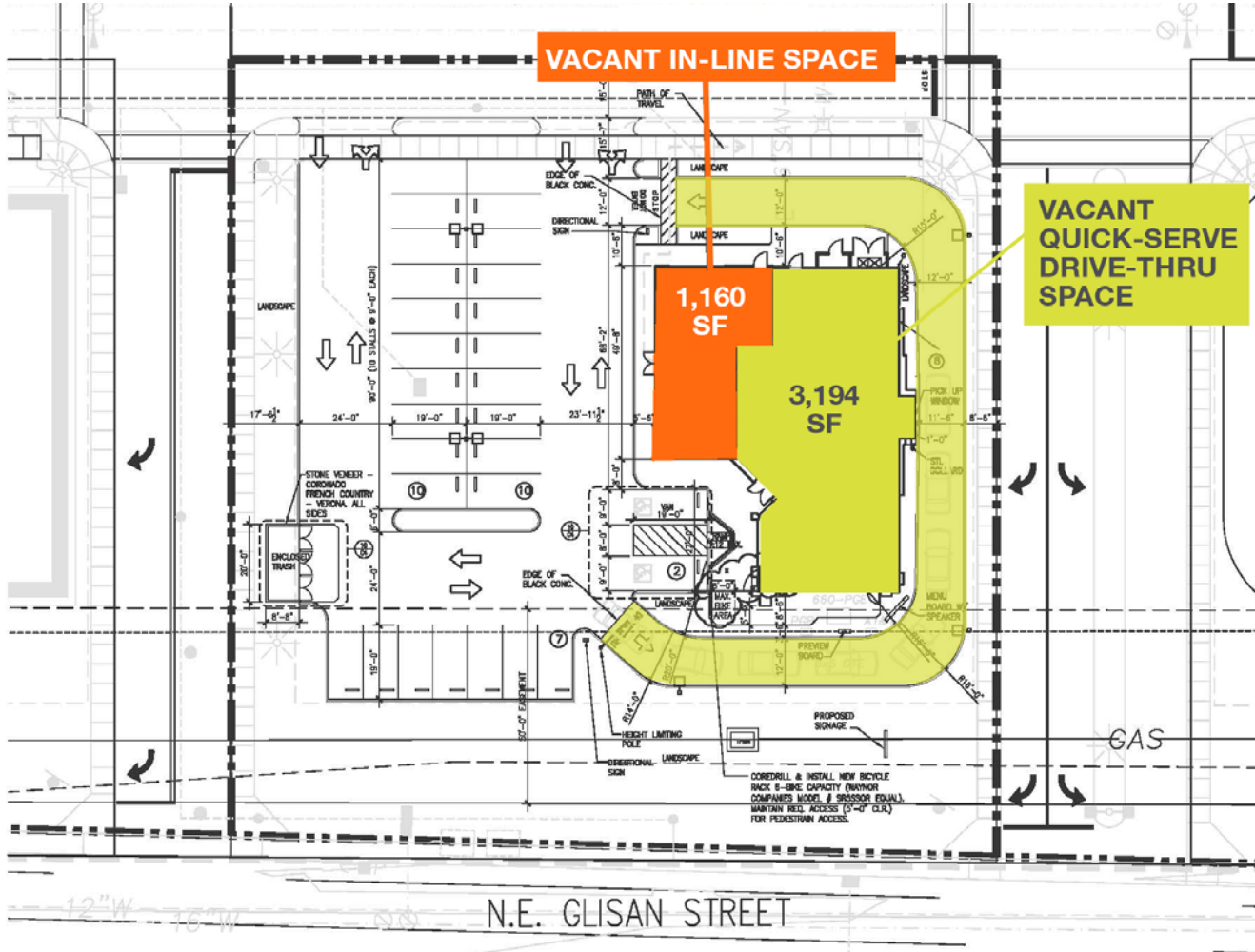

DEMOGRAPHICS	1/2 Mile	1 mile	3 miles	5 miles
Population	2,940	13,502	105,828	219,852
Population Forecast 2018	3,041	13,965	109,446	227,444
2013 Average HH Income	\$61,250	\$58,566	\$54,527	\$60,672
Employees	999	3,922	39,879	63,110

Contact

Corine Nussmeier
 Vice President
 503.721.2724
 corinen@kiddermathews.com

Sara Daley
 Senior Associate
 503.721.2726
 sdaley@kiddermathews.com

Ryan O'Leary
 Vice President
 503.221.2294
 roleary@kiddermathews.com

Wood Village Town Center

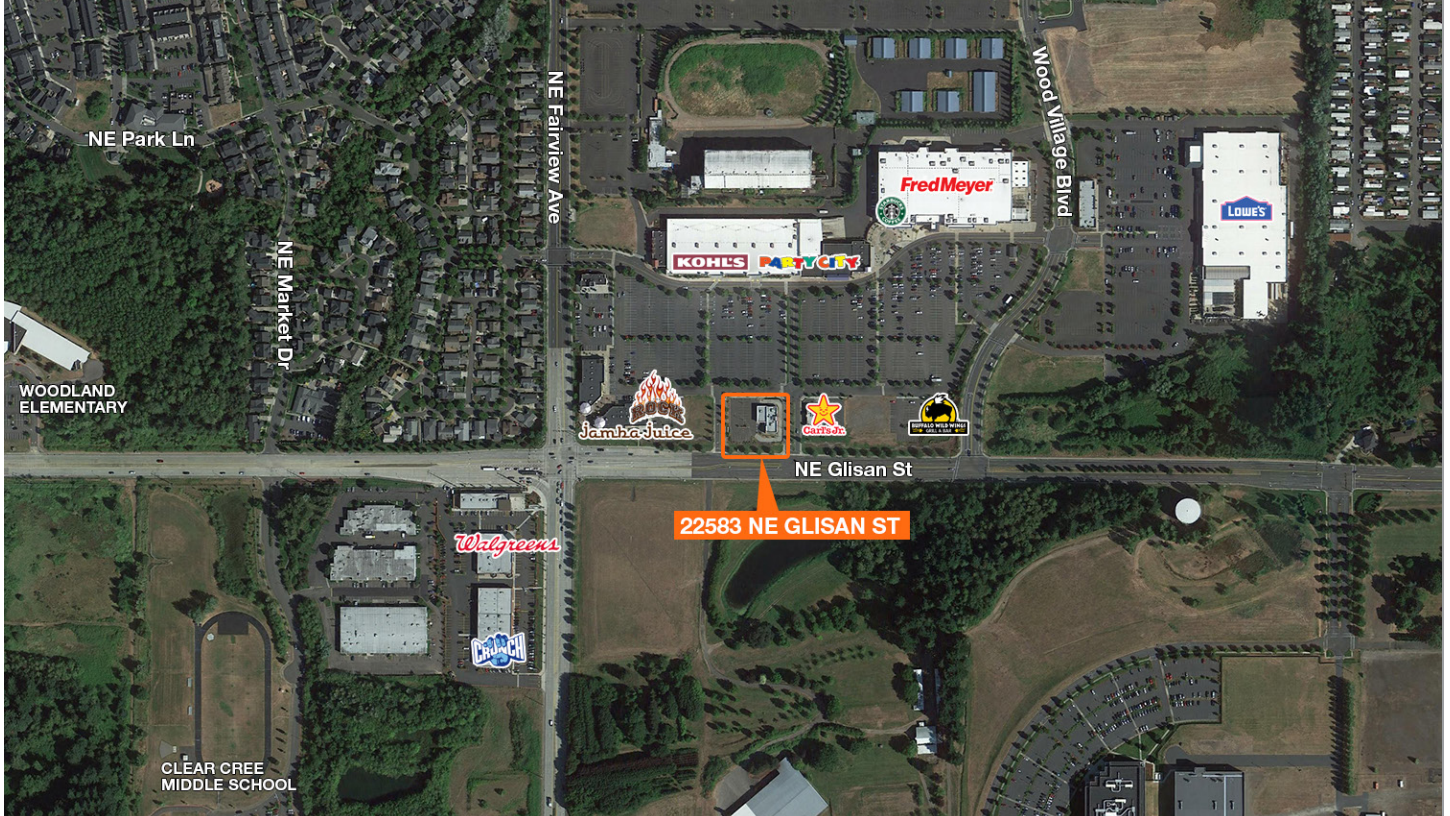

Locate your business here for almost no fees at all!

No SDC fees

No Building Permit fees

No Plan Review fees

No Business License fees

No Planning Department fees

*Per the Wood Village City Manager

Contact

Corine Nussmeier

Vice President

503.721.2724

corinen@kiddermathews.com

Sara Daley

Senior Associate

503.721.2726

sdaley@kiddermathews.com

Ryan O'Leary

Vice President

503.221.2294

roleary@kiddermathews.com