

### Building Sketch

Borrower/Client	Mary Jeanette Fontenot			
Property Address	1611 Highway 90 W			
City	New Iberia	County	Iberia	State LA Zip Code 70560
Lender	Mary Jeanette Fontenot			

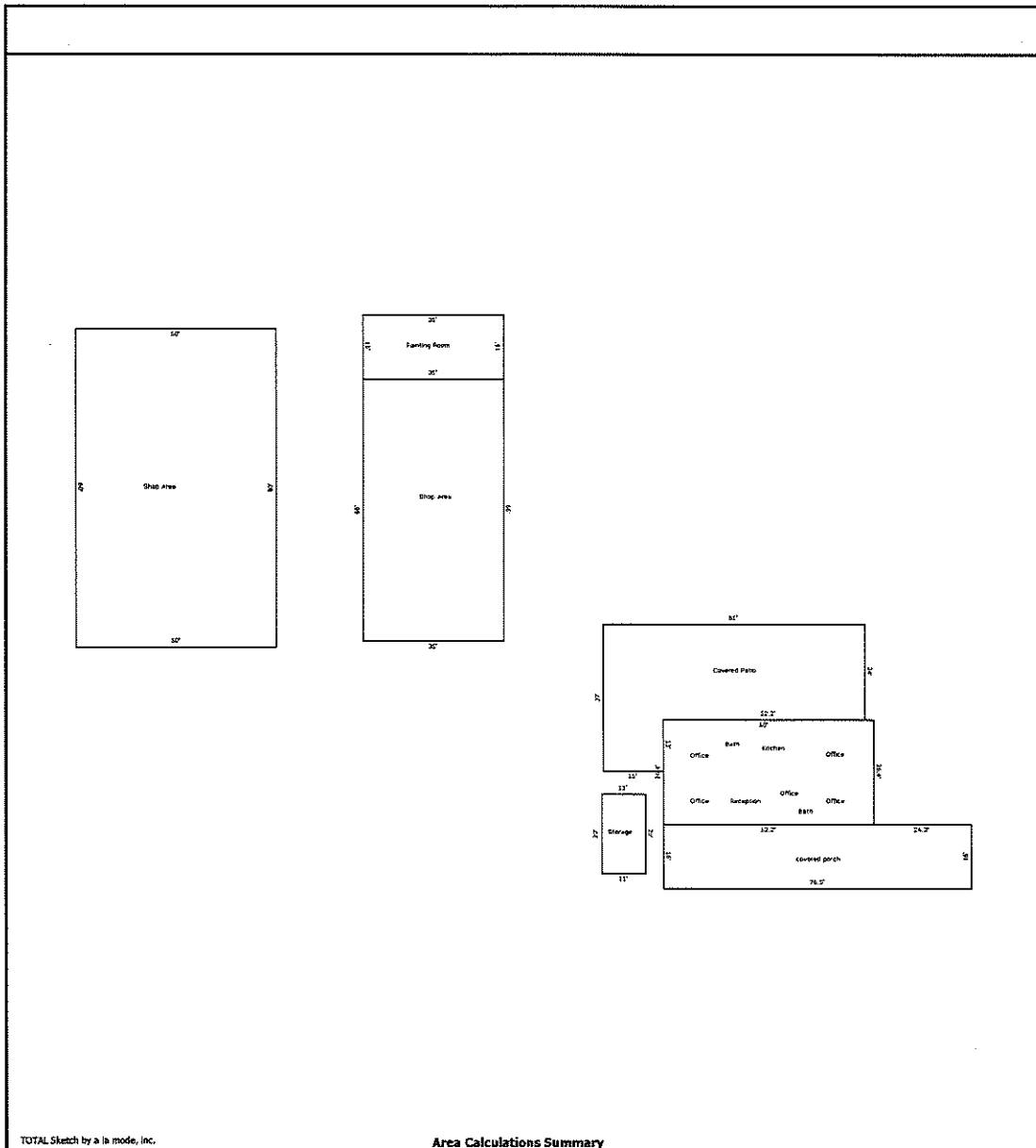

TOTAL Sketch by a la mode, inc.

Area Calculations Summary		Calculation Details
<b>Living Area</b>		
First Floor	1378.08 Sq ft	52.2 x 26.4 = 1378.08
Second Floor	4000 Sq ft	80 x 50 = 4000
Third Floor	2310 Sq ft	66 x 35 = 2310
Undefined Area	220 Sq ft	11 x 20 = 220
<b>Total Living Area (Rounded):</b>	<b>7908 Sq ft</b>	
<b>Non-living Area</b>		
Covered Porch	1224 Sq ft	76.5 x 16 = 1224
Covered Patio	1755 Sq ft	15 x 13 = 195 24 x 65 = 1560
Concrete Patio	560 Sq ft	35 x 16 = 560

*off*  
*wh*