

1516 W. 17TH STREET | TEMPE, AZ

TEMPLEONE



TEMPE ONE



BUILDING FEATURES



- Address: 1516 W. 17th Street, Tempe AZ
- Total Building Size: $\pm 106,747$ SF
- Total Availability: $\pm 106,747$ Available (Divisible)
- Clear Height: $\pm 18'$
- Situated on ± 9.06 Acres
- Building and monument signage available
- Ability to accommodate back office, light manufacturing, assembly and other uses
- Fire sprinklers
- Zoning: GID; City of Tempe
- Great access to Interstate 10; Loop 202; US 60 and SR 143
- Proximity to Sky Harbor Airport and Arizona State University
- Tremendous availability of labor within a five mile radius
- New exterior paint April 2018
- Availability to expand power to 10MW without a substation
- New slurry coat May 2018



TEMPE ONE



FLOOR PLAN

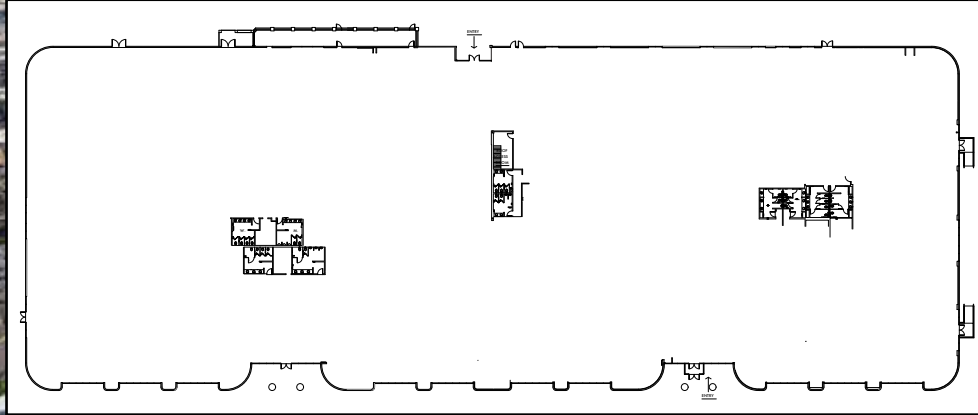



TEMPE ONE



3200 East Camelback Road
Suite 100
Phoenix, Arizona 85018
602-956-7777
www.leeearizona.com

Rick Lee
rlee@leeearizona.com
D 602.954.3742

Conner Lee
clee@leeearizona.com
D 602.474.9516

