



435 N. LaSalle	
SUITE 100	HYDROLOGY - 1 DOOR SOUTH
SUITE 100	NUHAUS - 120 W. HUBBARD ST.
SUITE 200	SIMPLE MILLS
SUITE 300	AERIS
SUITE 400	AERIS
SUITE LL2	THE BARRE CODE

435

# 435 NORTH LASALLE

3,518 SF OFFICE/RETAIL OPPORTUNITY  
LOWER LEVEL AT HUBBARD & LASALLE

**CBRE**



FLOOR 4

 aeris®



FLOOR 3

**SIMPLE**  
*Mills*®

FLOOR 2

hydrology  nuHaus 

FLOOR 1

**The Barre Code**  

LOWER LEVEL

**VACANT - 3,518 SF**

# AREA HIGHLIGHTS

## “Main & Main” River North Location

Proximity to the Loop, major expressways, and public transportation, including the Brown & Purple line L trains & CTA buses

3 minute walk from Merchandise Mart, which contains 4,000,000 SF of retailers and offices with approximately 16,000 employees and 120,000 daily visitors

## WITHIN ONE BLOCK:

















# DEMOGRAPHICS

WITHIN .5 MILES OF

## 435 NORTH LASALLE



POPULATION  
**29,399**



DAYTIME POPULATION  
**179,488**



MEDIAN AGE  
**34**



HOUSEHOLDS  
**19,278**



AVERAGE HH INCOME  
**\$155,113**



# FLOORPLAN

LASALLE

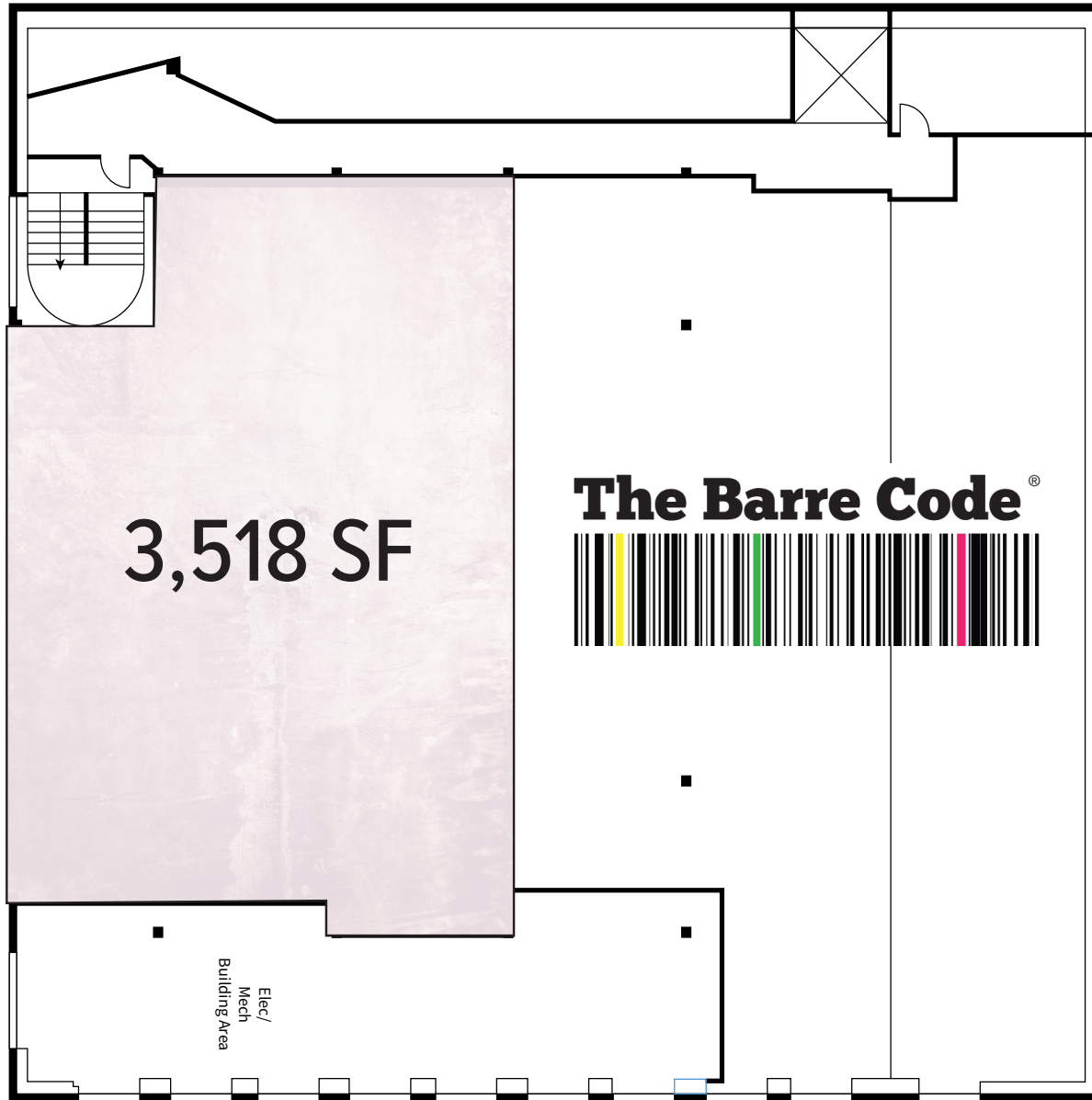

HUBBARD

# INTERIOR





# 435 NORTH LASALLE

**SHARON KAHAN**

**FIRST VICE PRESIDENT**

**312 297 7679**

**SHARON.KAHAN@CBRE.COM**

**AMY SIDER**

**FIRST VICE PRESIDENT**

**312 935 1909**

**AMY.SIDER@CBRE.COM**

**CBRE**