



OBERER

REALTY SERVICES, LTD.

FOR LEASE SHOPPES OF ENGLEWOOD

801 - 805 Union Blvd.
Englewood, Ohio 45322



- **1,200 - 3,600 +/- SF FOR LEASE** in 8,100 SF retail center on Union Blvd. at Wenger Rd.
- **PRIME LOCATION** directly in front of 125,000 SF Kroger Marketplace
- **EXCELLENT VISIBILITY** with direct frontage on Union Blvd. which provides drive-by traffic of over 11,860 vehicles per day
- **CONVENIENT ACCESS TO/FROM** Wenger Road, Hoke Road and I-70
- **CONTACT JOHN ORR at 937.910.0851 for more information**

2017 DEMOGRAPHICS	1 mile	3 mile	5 mile
POPULATION	9,215	33,964	59,858
HH INCOME	\$72,160	\$72,558	\$70,429

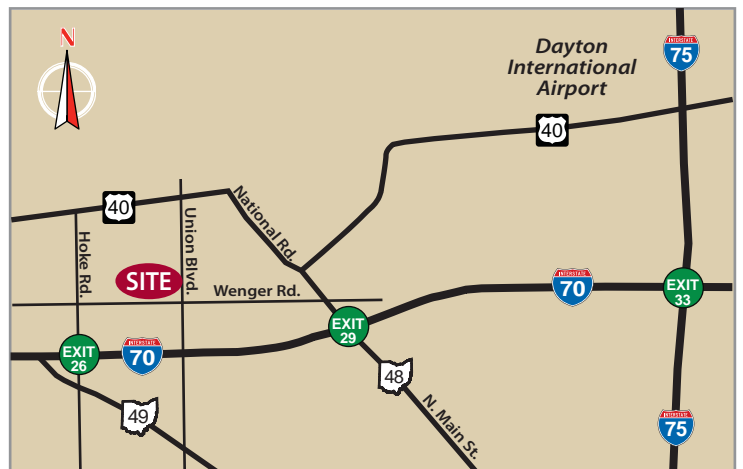

WELCOME TO THE REGION WE KNOW

937-910-0851 • 3445 Newmark Drive, Miamisburg, Ohio 45342 • www.oberer.com/commercial

FOR LEASE SHOPPES OF ENGLEWOOD

801 - 805 Union Blvd.
Englewood, Ohio 45322

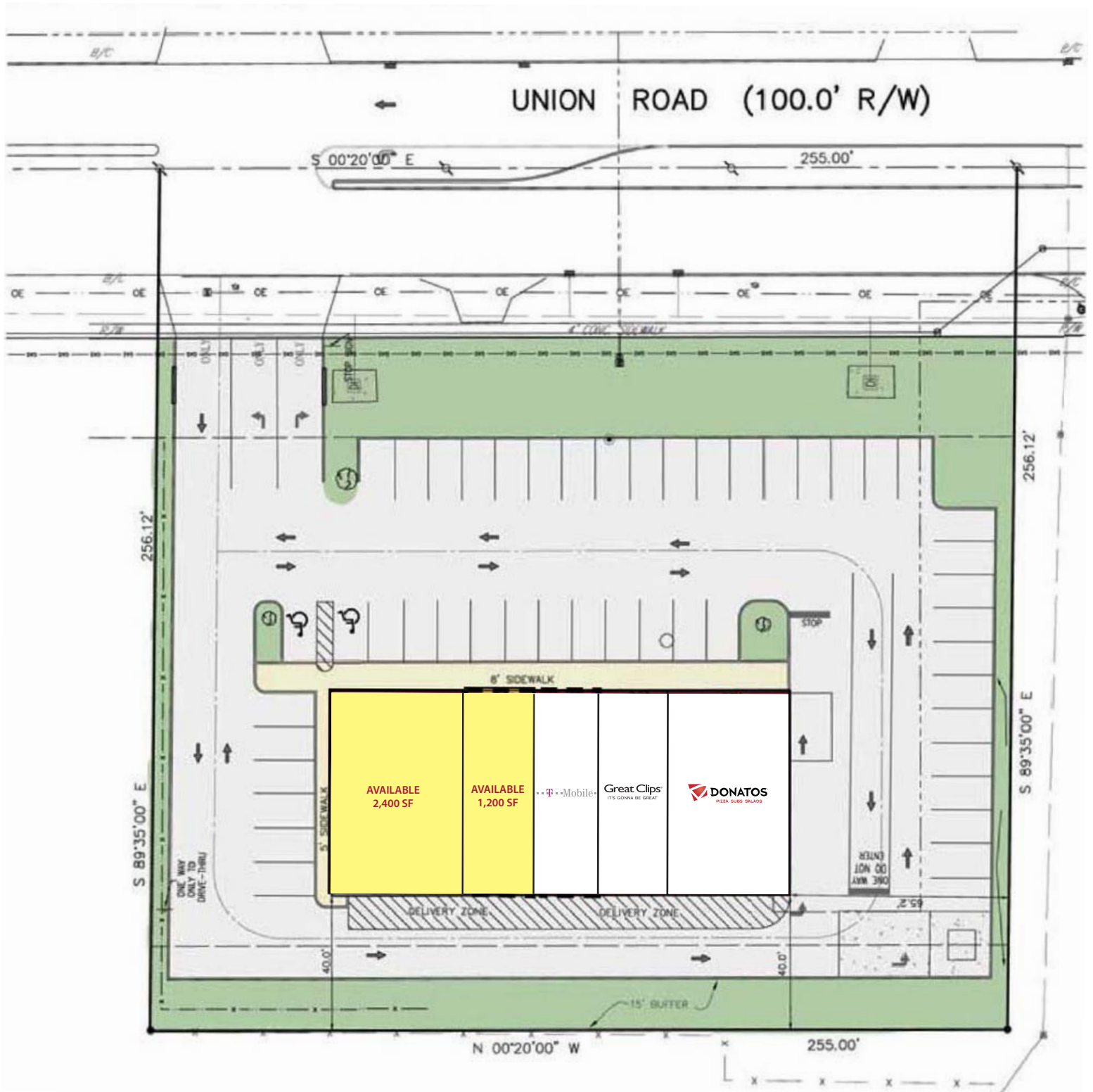

WELCOME TO THE REGION WE KNOW

937-910-0851 • 3445 Newmark Drive, Miamisburg, Ohio 45342 • www.oberer.com/commercial

FOR LEASE SHOPPES OF ENGLEWOOD

801 - 805 Union Blvd.
Englewood, Ohio 45322



WELCOME TO THE REGION WE KNOW

937-910-0851 • 3445 Newmark Drive, Miamisburg, Ohio 45342 • www.oberer.com/commercial