

Highly Sought Restaurant/Retail Space

At one of L.A.'s Busiest Intersections

FOR LEASE

11108 OLYMPIC BOULEVARD



ADDRESS: 11108 West Olympic Boulevard
Los Angeles, CA 90064

AVAILABLE SPACE: Approximately 700 square feet.

RENTAL RATE: \$3.00 per square foot, per month, net net net.
(Triple net charges are approximately \$760 per month).

TERM: Three (3) to five (5) years.

- FEATURES:**
- ❖ Tremendous restaurant/retail identity at West Olympic Boulevard and Sepulveda Boulevard.
 - ❖ Be a part of a thriving shopping center with co-tenants: Subway, Pazzo Pizzeria, California Mexican Grill, Kalbi's Korean BBQ, and Hop Woo Seafood.
 - ❖ The store front is available now!
 - ❖ Centrally located in West Los Angeles.

FOR MORE INFORMATION OR A TOUR, PLEASE CONTACT:

Michael F. Rojas

rojas@westmac.com

BRE #: 01853734

Coldwell Banker Commercial WESTMAC
1515 Sepulveda Boulevard
Los Angeles, CA 90025

(310) 478-7700
Company DRE #: 01096973



WESTMAC

This statement with the information it contains is given with the understanding that all negotiations relating to the purchase, renting, or leasing of the property described above shall be conducted through this office. The above information while not guaranteed has been secured from sources we believe to be reliable.

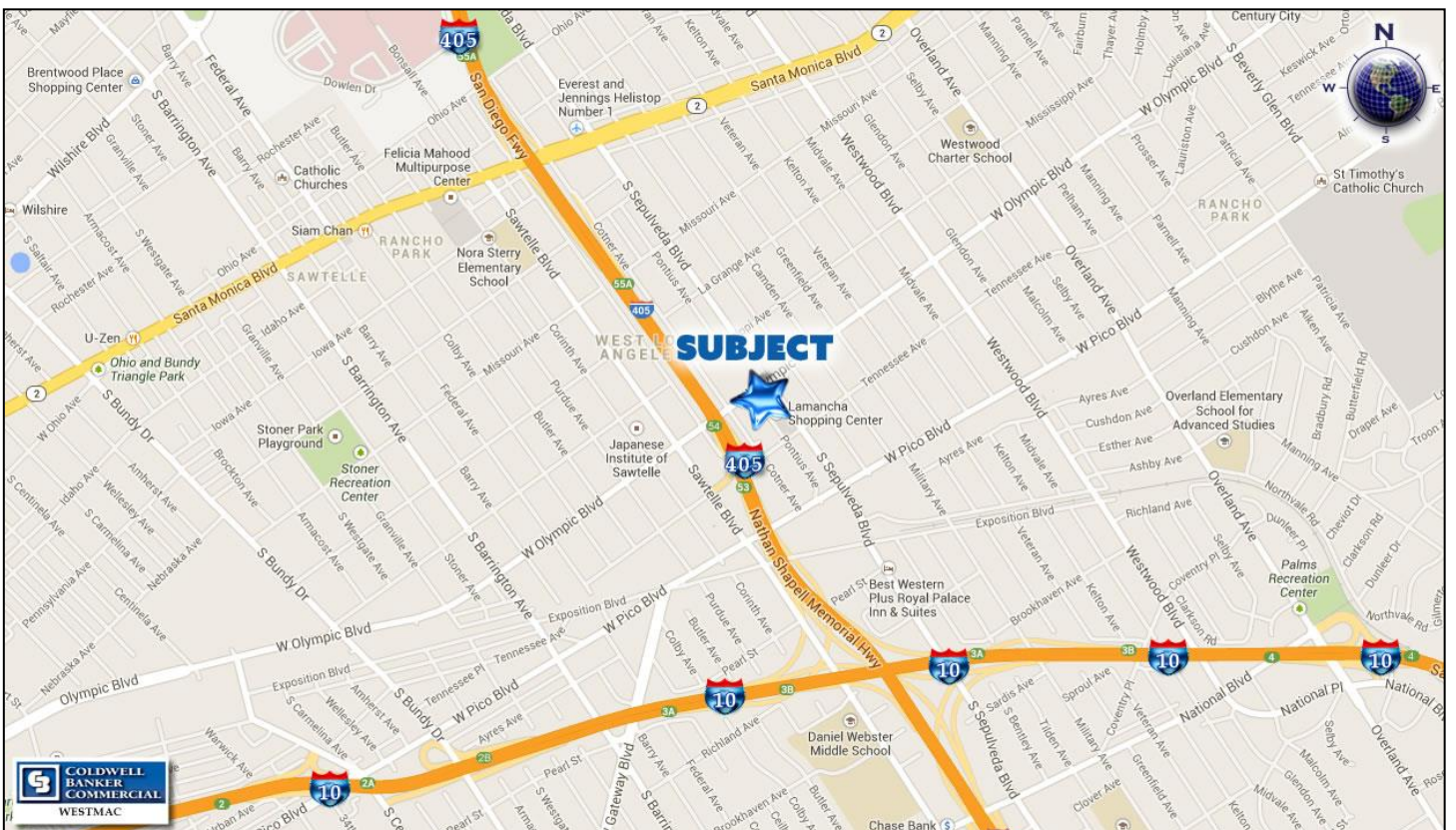
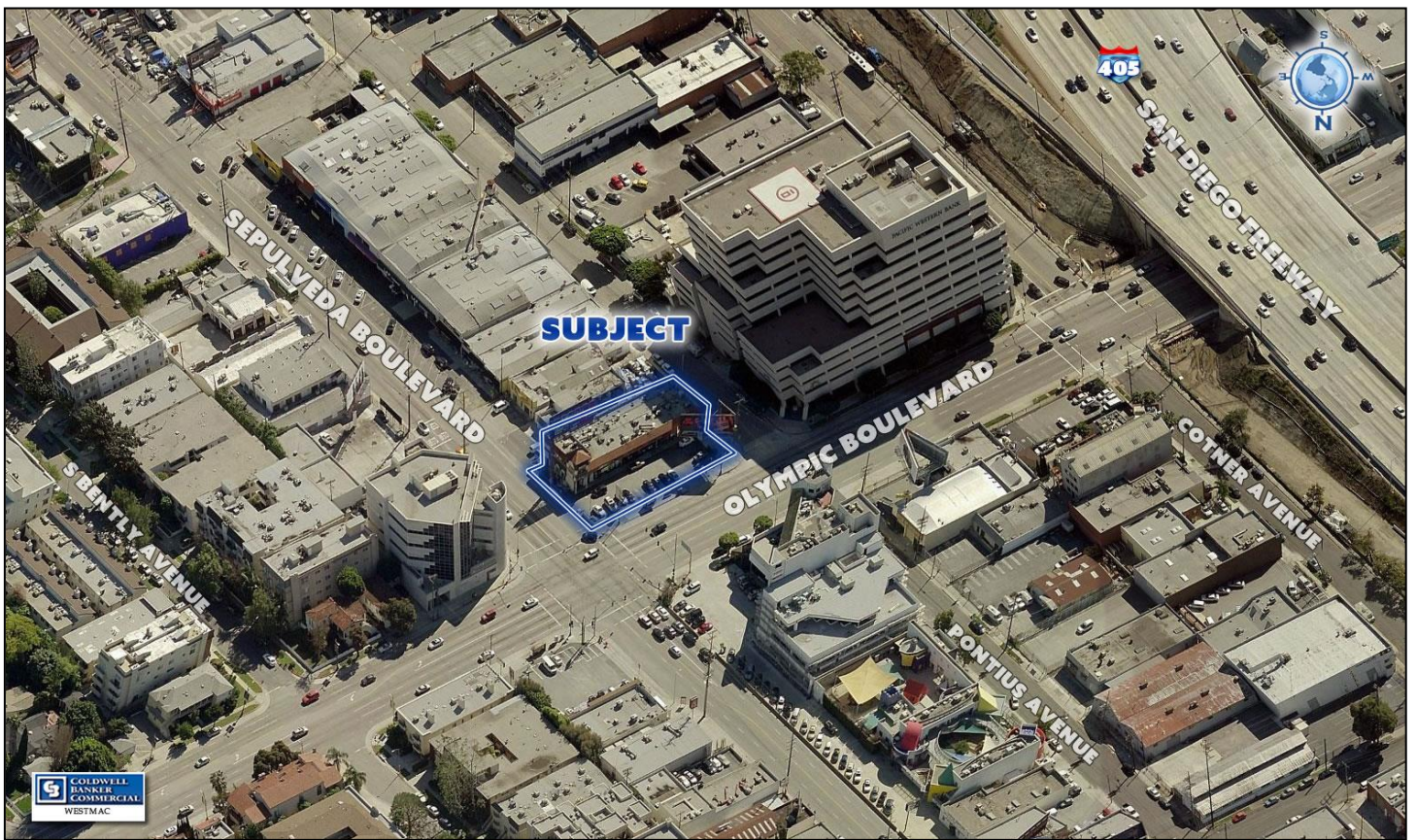

Coldwell Banker Commercial WESTMAC
 1515 Sepulveda Boulevard
 Los Angeles, CA 90025

(310) 478-7700
 Company DRE #: 01096973



WESTMAC

This statement with the information it contains is given with the understanding that all negotiations relating to the purchase, renting, or leasing of the property described above shall be conducted through this office. The above information while not guaranteed has been secured from sources we believe to be reliable