

# PROMINENT STATE STREET LOCATION RETAIL FOR LEASE

601 State Street, Santa Barbara, CA 93101



**BUILDING SF:** 4,653 SF

**LOT SIZE:** 5,227 SF

**LEASE RATE:** \$3.50 NNN

**NNN/SF:** \$1.20/SF est.

**APN:** 037-131-010

**ZONING:** C-2

**CROSS STREET:** Cota Street

**AVAILABLE:** August 1, 2018

**CSO:** 3%



## PROPERTY OVERVIEW

High profile State Street building in downtown Santa Barbara, on a hard corner at Cota Street. Corner shared with **Starbucks**, **Cost Plus World Market**, and local favorite **Joe's Cafe**. Preferred **State Street** location surrounded by popular business and buffered from future building projects (Macy's & Saks Fifth Ave). Abundant parking in nearby city lots. Street frontage 47' x 98' +/-.

Rob Adams, CCIM  
radams@lee-associates.com  
D 805.962.6700 x1111  
CalDRE #01344315

Stephen Leider  
sleider@lee-associates.com  
D 805.962.6700 x1103  
CalDRE #967865

All information furnished regarding property for sale, rental or financing is from sources deemed reliable, but no warranty or representation is made to the accuracy thereof and same is submitted to errors, omissions, change of price, rental or other conditions prior to sale, lease or financing or withdrawal without notice. No liability of any kind is to be imposed on the broker herein.

# PROMINENT STATE STREET LOCATION RETAIL FOR LEASE

601 State Street, Santa Barbara, CA 93101

**LEE & ASSOCIATES**  
COMMERCIAL REAL ESTATE SERVICES

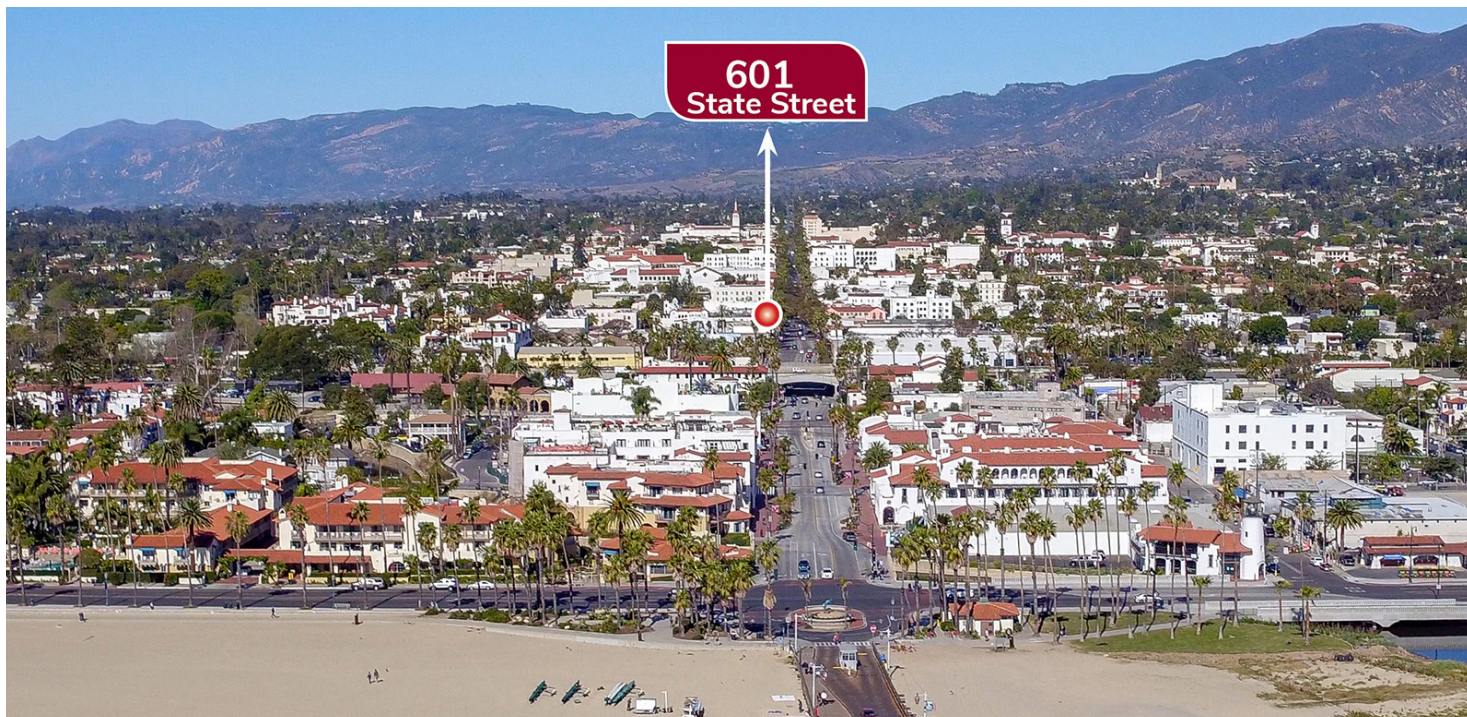

Rob Adams, CCIM  
radams@lee-associates.com  
D 805.962.6700 x1111  
CalDRE #01344315

Stephen Leider  
sleider@lee-associates.com  
D 805.962.6700 x1103  
CalDRE #967865

All information furnished regarding property for sale, rental or financing is from sources deemed reliable, but no warranty or representation is made to the accuracy thereof and same is submitted to errors, omissions, change of price, rental or other conditions prior to sale, lease or financing or withdrawal without notice. No liability of any kind is to be imposed on the broker herein.

# PROMINENT STATE STREET LOCATION RETAIL FOR LEASE

601 State Street, Santa Barbara, CA 93101

**LEE & ASSOCIATES**  
COMMERCIAL REAL ESTATE SERVICES



Rob Adams, CCIM  
radams@lee-associates.com  
D 805.962.6700 x1111  
CalDRE #01344315

Stephen Leider  
sleider@lee-associates.com  
D 805.962.6700 x1103  
CalDRE #967865

All information furnished regarding property for sale, rental or financing is from sources deemed reliable, but no warranty or representation is made to the accuracy thereof and same is submitted to errors, omissions, change of price, rental or other conditions prior to sale, lease or financing or withdrawal without notice. No liability of any kind is to be imposed on the broker herein.

# PROMINENT STATE STREET LOCATION RETAIL FOR LEASE

601 State Street, Santa Barbara, CA 93101

**LEE & ASSOCIATES**  
COMMERCIAL REAL ESTATE SERVICES



Rob Adams, CCIM  
radams@lee-associates.com  
D 805.962.6700 x1111  
CalDRE #01344315

Stephen Leider  
sleider@lee-associates.com  
D 805.962.6700 x1103  
CalDRE #967865

All information furnished regarding property for sale, rental or financing is from sources deemed reliable, but no warranty or representation is made to the accuracy thereof and same is submitted to errors, omissions, change of price, rental or other conditions prior to sale, lease or financing or withdrawal without notice. No liability of any kind is to be imposed on the broker herein.

# PROMINENT STATE STREET LOCATION RETAIL FOR LEASE

601 State Street, Santa Barbara, CA 93101

## FLOOR PLAN: 601 STATE STREET

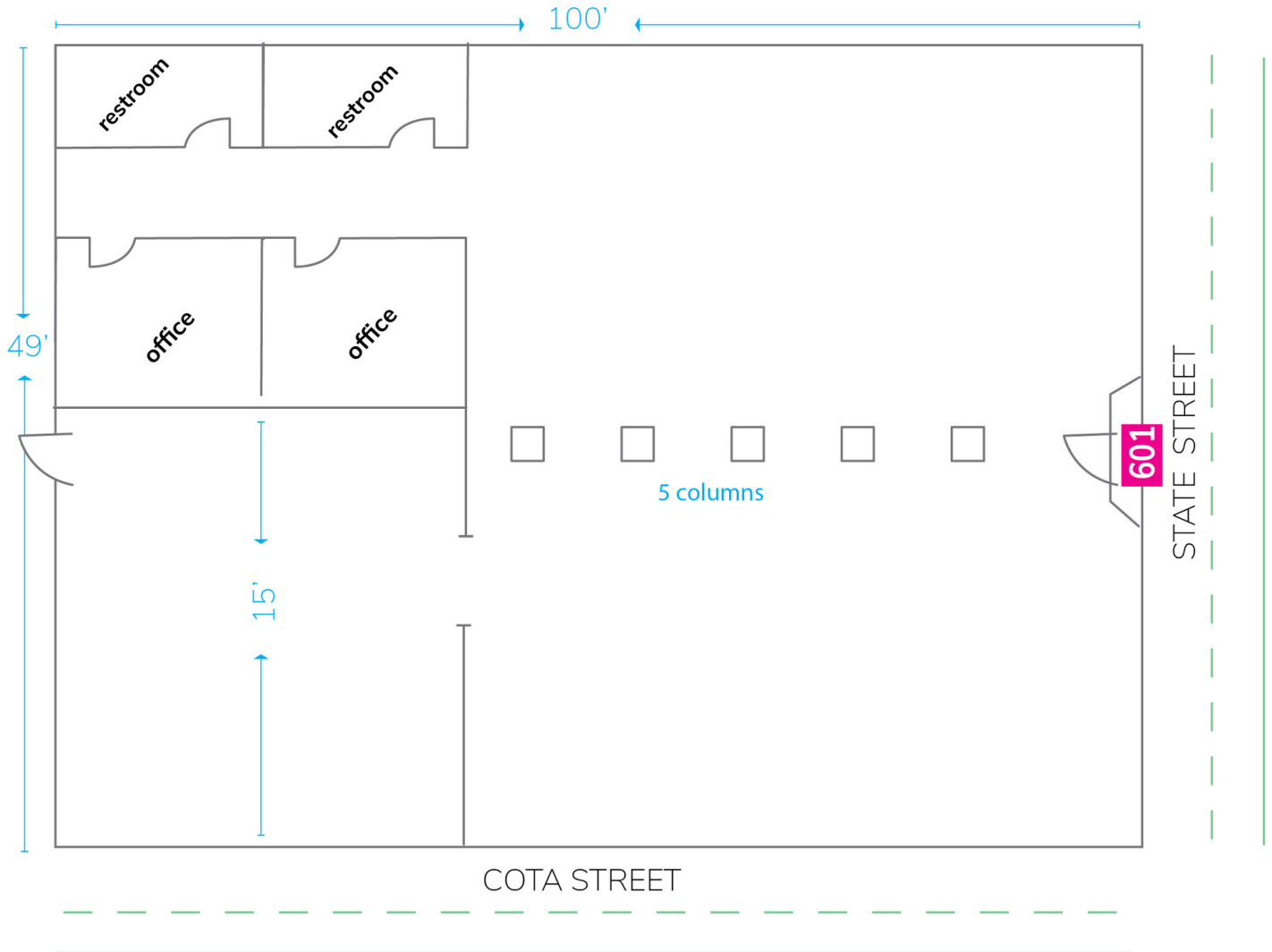

Rob Adams, CCIM  
radams@lee-associates.com  
D 805.962.6700 x1111  
CalDRE #01344315

Stephen Leider  
sleider@lee-associates.com  
D 805.962.6700 x1103  
CalDRE #967865

All information furnished regarding property for sale, rental or financing is from sources deemed reliable, but no warranty or representation is made to the accuracy thereof and same is submitted to errors, omissions, change of price, rental or other conditions prior to sale, lease or financing or withdrawal without notice. No liability of any kind is to be imposed on the broker herein.

# PROMINENT STATE STREET LOCATION

## RETAIL FOR LEASE

601 State Street, Santa Barbara, CA 93101



### Restaurants & Coffee Shops

- 1 Andersen's Bakery
- 2 Arigato Sushi
- 3 Benchmark Eatery
- 4 Bouchon
- 5 Carlitos Y Cantina
- 6 Viva Modern Mexican
- 7 Coffee Bean & Tea Leaf
- 8 Jane Restaurant
- 9 Jeannine's Bakery
- 10 Olio E Limone
- 11 Opal Restaurant & Bar
- 12 Peet's Coffee
- 13 Satellite
- 14 Savoy Café & Deli
- 15 Sommerset
- 16 Starbucks x3
- 17 The Chase Bar & Grill
- 18 The French Press
- 19 Baja Sharkeez
- 20 Red Piano
- 21 SB Brewing Company
- 22 Hibachi Steak/Sushi Bar
- 23 Natural Cafe
- 24 Sandbar

### Retail

- 25 Anthropologie
- 26 Apple Store
- 27 Coach
- 28 CVS
- 29 FedEx/Kinko's
- 30 Forever 21
- 31 Gold's Gym
- 32 La Arcada Shops
- 33 M.A.C. Cosmetics
- 34 Metropolitan Theaters
- 35 Old Navy
- 36 Public Market
- 37 Ralph's Supermarket
- 38 Samy's Camera

### Services & Hospitality

- 39 American Riviera Bank
- 40 Impact Hub
- 41 Kimpton Canary Hotel
- 42 Pacific Premier Bank
- 43 REGUS Coworking Offices



# PROMINENT STATE STREET LOCATION RETAIL FOR LEASE

601 State Street, Santa Barbara, CA 93101



## DEMOGRAPHICS

	1 MILE	3 MILES	5 MILES
Total population	23,104	87,333	117,947
Median age	32.1	36.8	39.1
Median age (male)	31.9	36.2	38.7
Median age (female)	33.6	37.9	40.0

	1 MILE	3 MILES	5 MILES
Total households	8,939	34,183	47,224
Total persons per HH	2.6	2.6	2.5
Average HH income	\$62,482	\$85,652	\$95,571
Average house value		\$908,205	\$921,929



[CLICK](#)  
to explore  
the neighbourhood



Stephen Leider  
sleider@lee-associates.com  
D 805.962.6700 x103  
CalLic. #967865

Rob Adams, CCIM  
radams@lee-associates.com  
D 805.962.6700 x111  
CalLic. #01344315

All information furnished regarding property for sale, rental or financing is from sources deemed reliable, but no warranty or representation is made to the accuracy thereof and same is submitted to errors, omissions, change of price, rental or other conditions prior to sale, lease or financing or withdrawal without notice. No liability of any kind is to be imposed on the broker herein.