

# Skyway Business Park Building



## Industrial Space for Lease

**PROJECT SIZE**

±64,894 SF  
(±6.63 Acre Site)

**YEAR BUILT**

2008

**PARKING**

188 Spaces

**AVAILABILITY**

BLDG B  
*(Up to 14,489 sf of  
contiguous space)*

Suite 106: 4,847 sf  
Suite 107: 4,825 sf  
Suite 108: 4,817 sf

BLDG C

Suite 111: 4,817 sf

**LEASE RATE**

\$.70/SF, NNN

**ZONING**

PAD - Industrial  
(Light Industrial)

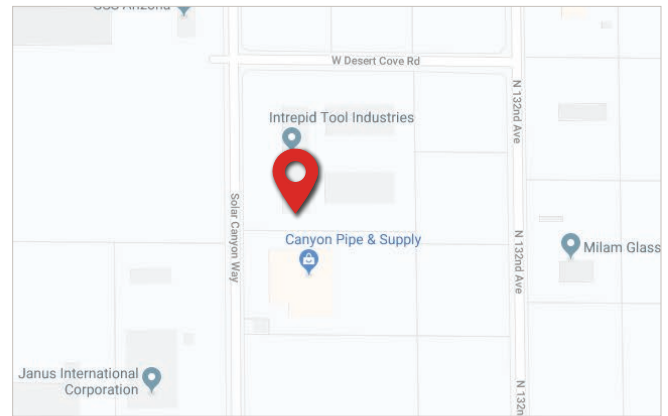

**FEATURES**

- 12'x 14' grade level roll-up doors
- Each suite has 400 SF of outdoor yard
- 18' clear height
- Power: APS
- Telecom: Cox Communications

**Kevin S. Helland, MBA**

D 480 423 7942  
C 623 293 1543  
kevin.helland@avisonyoung.com

2720 E Camelback Road  
Suite 150  
Phoenix, AZ 85016  
avisonyoung.com

FLOOR PLAN

DESERT COVE RD

S 89°11'57" E 530.84'

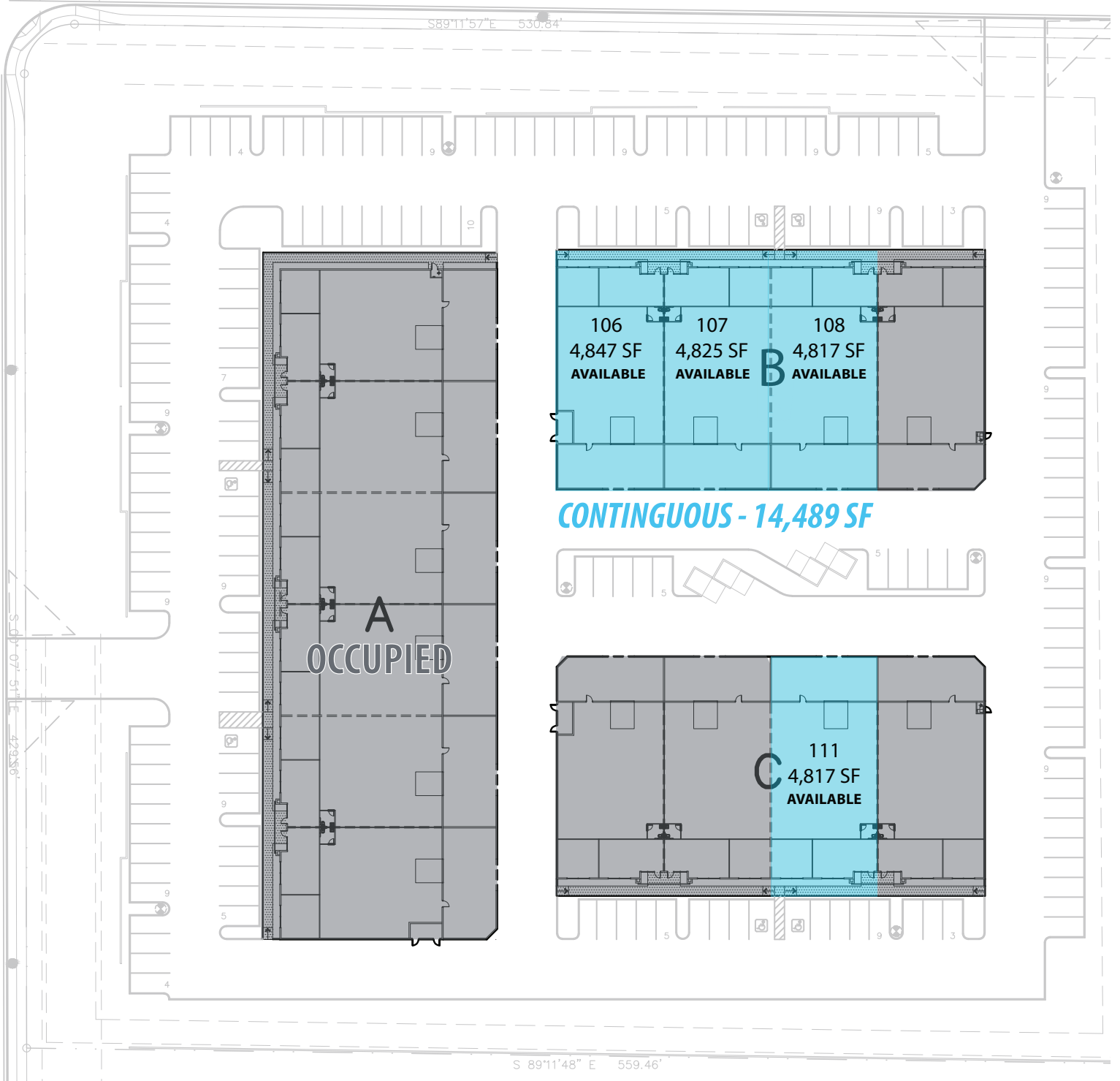



## LOCATION FEATURES

Skyway Business Park, a 300-acre rail-served industrial park, is located in Surprise, one of Arizona's fastest growing cities. Skyway Business Park is home to a variety of businesses including Crescent Crown Distributing, Intrepid Tool Industries, Southwest Products, IRIS USA, Horizon Aviation and Machining, ATEC Engineering and Milam Glass. Currently, there are over 1.4 million people within a 30-minute drive. The subject property is a 64,894 square foot multi-tenant industrial project within the park that is strategically located less than five miles between Loop 303 and Loop 101, offering direct access to the northwest corridor of the Greater Metropolitan Phoenix Area. This central connection features logistical advantages to industrial users with the capability to serve numerous large urban areas located within a one-day and two-day delivery zone.

## Employers Located in Skyway Business Park



**HORIZON AVIATION  
& MACHINING**

PARCEL AERIAL



REGIONAL MAP

