

28 WEST 14TH STREET

BETWEEN BETWEEN 5TH & 6TH AVE | UNION SQUARE

ksr
KASSIN SABBAGH REALTY



**BROWS
STUDIO**
**EYEBROWS
&
THREADING**
• EYELASH EXTENSION
• WAXING
• FACIAL
• EYEBROW TITING

MATTRESS FIRM

KING
FOR THE BEST OF
QUEEN

28 WEST 14TH STREET

BETWEEN BETWEEN 5TH & 6TH AVE | UNION SQUARE

SIZE

| | |
|------------|----------|
| Space A | 1,650 SF |
| Space B | 650 SF |
| + Basement | 3,500 SF |
| <hr/> | |
| Total | 5,800 SF |

CEILING HEIGHT

11'

FRONTAGE

30'

TRANSPORTATION



ASKING RENT

Upon Request

POSSESSION

Arranged

COMMENTS

- Wide open space on one of Union Square's busiest cross streets
- One of the most accessible locations in New York City with over 10 different transportation lines in immediate vicinity
- Additional basement storage included

FLOOR PLAN

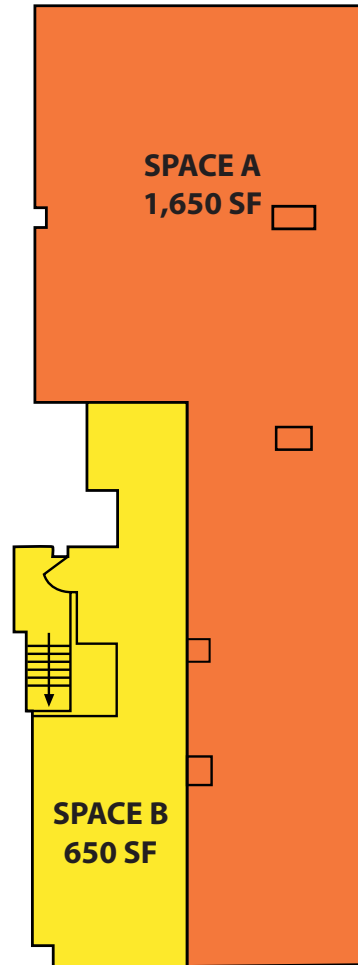

AREA MAP

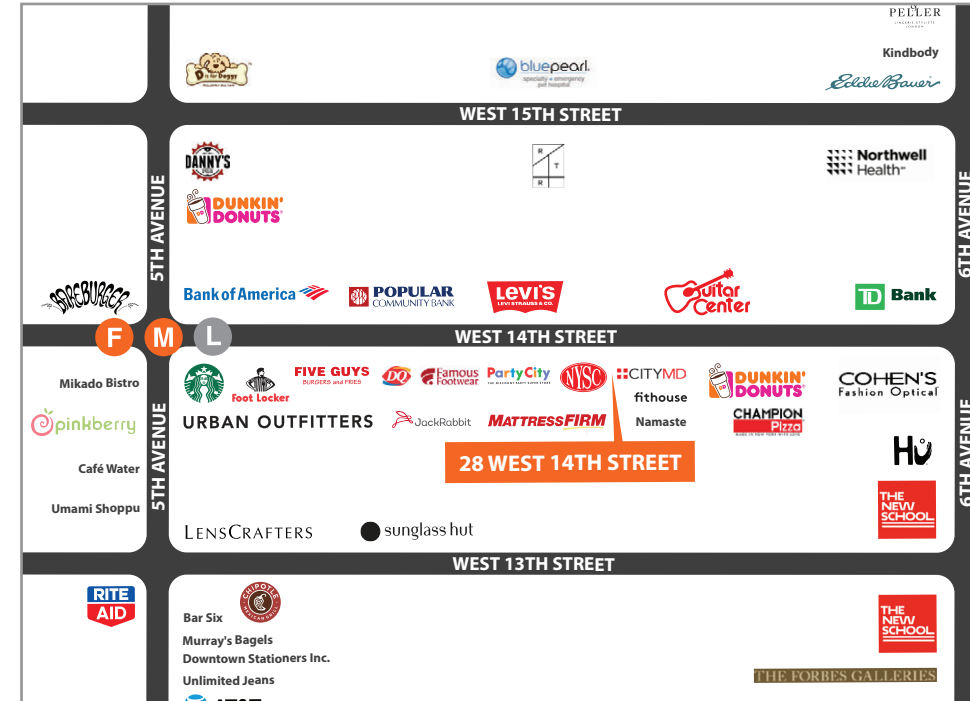

SURROUNDING RETAILERS



KASSIN SABBAGH REALTY
1385 Broadway 22nd floor
New York, NY 10018
(212) 417-9217
<https://www.ksrny.com/>

CONTACT OUR BROKER(S) FOR MORE INFORMATION

DOREL MELLOUL

DMelloul@ksrny.com

347.922.4563

MARC SITT

MSitt@ksrny.com

646.869.55288