222 East 59th Street

MIDTOWN
NEW YORK, NY



NEWMARK

222 EAST 59TH STREET

Property Details

Location

South block between Second and Third Avenues

Approximate Size

Ground Floor

Space A 1,950 SF

Space B 1,950 SF

Term

Negotiable

Frontage

Space A 20 FT on East 59th Street

Space B 20 FT on East 59th Street

Possession

Immediate

Site Status

Space A Formerly Lutron

Space B Formerly Waterworks

Neighbors

Royalton, The Shade Store, CB2, Just Shades, German Kitchen Center, JANUS at Cie, Manhattan Cabinetry, Michael Dawkins Home, De Gournay, Savoir Beds, Clarks, The Home Depot, Bloomingdale's, Jensen-Lewis Furniture and Design Within Reach

Comments

Located at the base of the D&D Building and surrounded by furniture and interior design tenants

Close proximity to the Queensboro Bridge and Roosevelt Island Tramway

Area benefits from both residential and office traffic

Spaces A and B can be combined

Floor Plans

Ground Floor

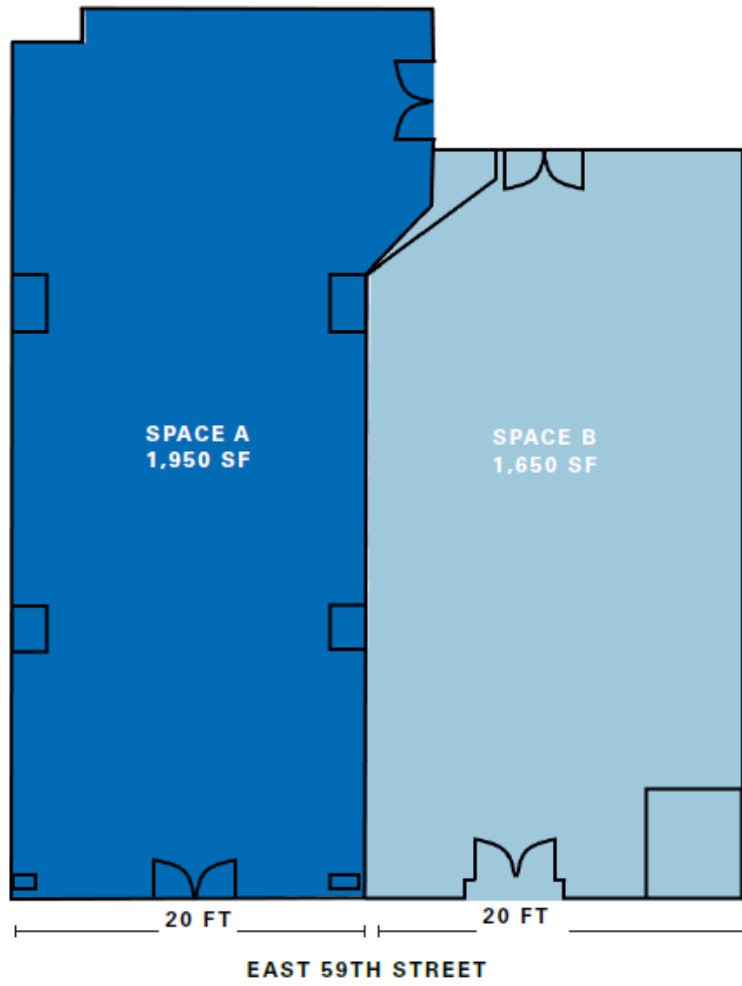

Area Neighbors



222 EAST 59TH STREET

EAST 61ST STREET

EAST 60TH STREET

EAST 59TH STREET

222 EAST 59TH STREET

EAST 58TH STREET

EAST 57TH STREET

EAST 56TH STREET

EAST 55TH STREET

EAST 54TH STREET

PARK AVENUE

LEXINGTON AVENUE

THIRD AVENUE

SECOND AVENUE

4

5

6

N

R

W

COMING SOON

CONTACT

Adam Weinblatt
 t 212-372-2103
 adam.weinblatt@nmrk.com

Lucas Kooyman
 t 212-372-2384
 lucas.kooyman@nmrk.com

Jason Pruger
 t 212-372-2092
 jason.pruget@nmrk.com

nmrk.com