



MONTANA AVENUE CAPITAL PARTNERS
Real Estate Investment Management

CENTERPARK



CENTERPARK PLAZA

6815 FLANDERS DRIVE, SAN DIEGO, CALIFORNIA 92121 | SORRENTO MESA



46,510 sf building
located in a
204,143 sf park



On-site
Cafe



PROPERTY HIGHLIGHTS



Strong
institutional
ownership



Excellent image
with corner
visibility

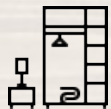

On-site shower
and
locker facilities



Recently renovated
common areas and
restrooms

- » Easy access to I-805, Mira Mesa Blvd, and Camino Santa Fe
- » Many amenities nearby (walking distance to Green Flash Brewery)
- » 4.0 per 1,000 rentable square feet parking ratio
- » T1 throughout the project. Fiber provided by AT&T



Updated
landscaping

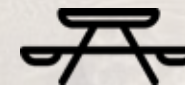

Revamped
common
seating areas

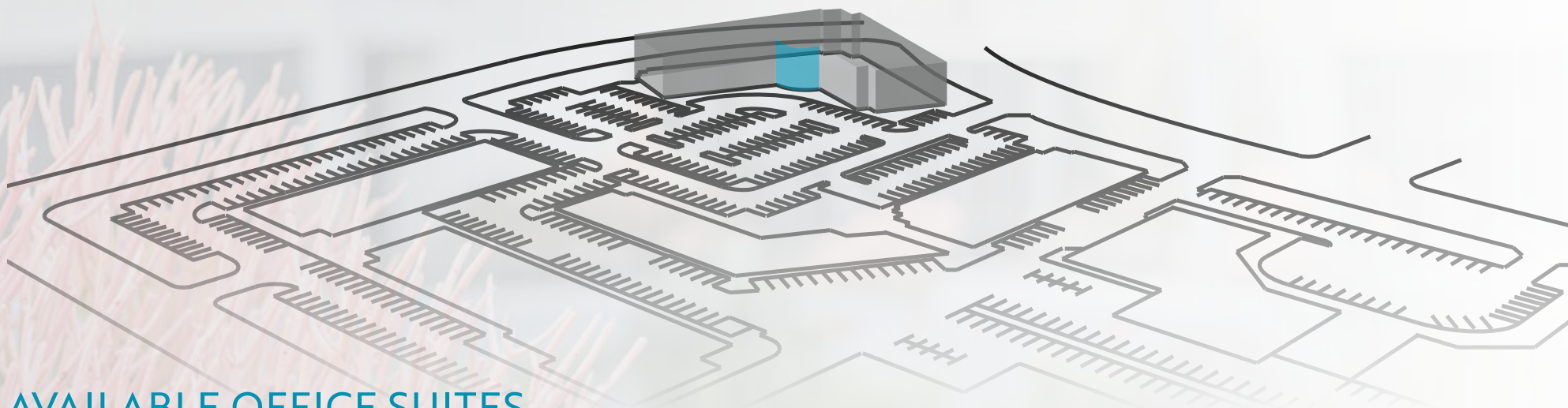

AVAILABLE OFFICE SUITES

SUITE	SF	RENT	COMMENTS
Suite 210	3,077	\$2.15 +U	Six (6) private offices, one (1) conference room, reception area, open office area, and breakroom.

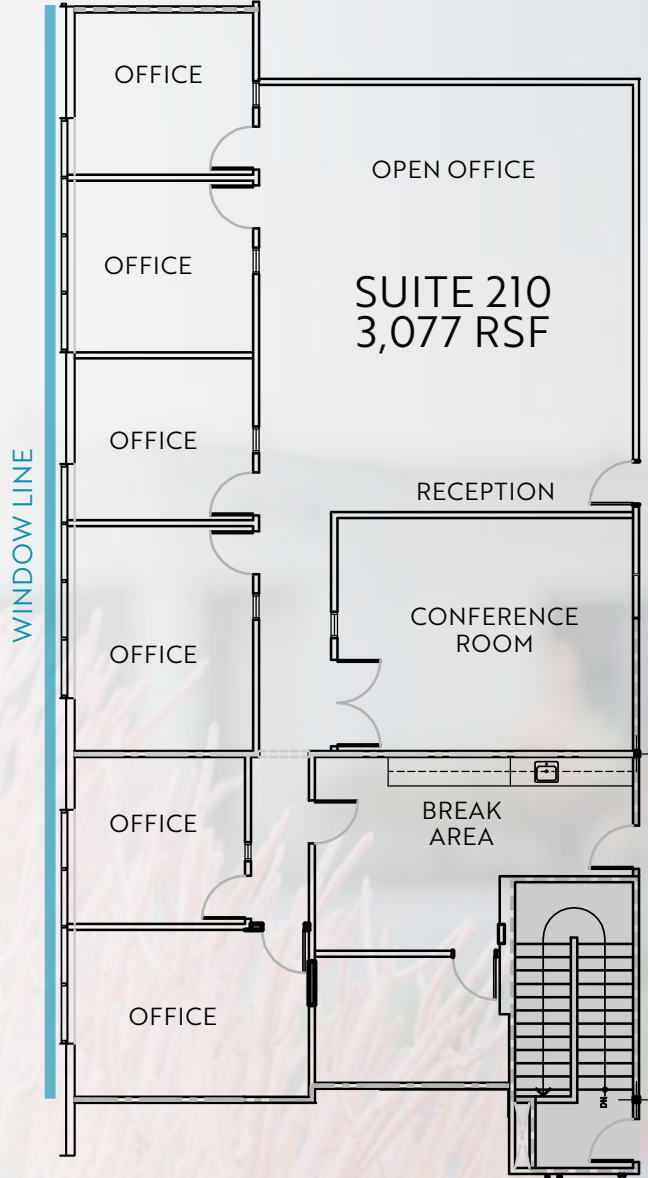

SUITE 210

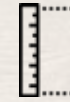

3,077 Square Feet



Asking Rate:
\$2.15 +U



One (1) Conference
Room



Reception
Area



Six (6)
private offices



Break
Room



Open area /
bull pen

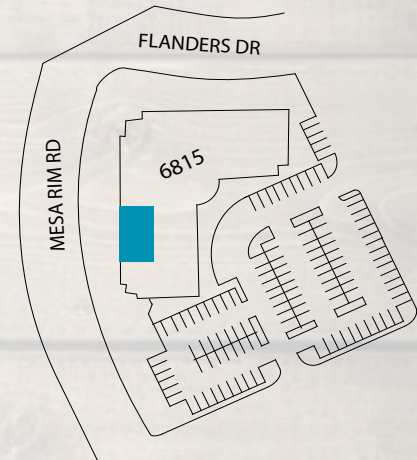



1

On-site Cafe



2

Upgraded Outdoor Areas



3

Refreshed Landscaping



ON-SITE

AMENITIES

2

3

1

NEARBY AMENITIES

PACIFIC
OCEAN

UTC



Angeli's Cafe

MIRA MESA BLVD

CAMINO SANTA FE

Plaza Sorrento

- Urbane Cafe
- Waba Grill
- Spices cafe
- Habaneros
- Sports Clips
- Navy Federal
- Verizon
- Subway

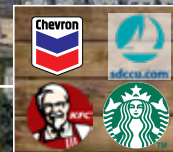

CONTACT

BILL CAVANAGH

858.546.5460

bill.cavanagh@cushwake.com

CA Lic. 00905262

MIKE NOVKOV

858.546.5412

mike.novkov@cushwake.com

CA Lic. 01890388

BRANT ABERG, SIOB

858.546.5464

brant.aberg@cushwake.com

CA Lic. 01773573

©Cushman & Wakefield. All rights reserved. This information has been obtained from sources believed to be reliable but has not been verified. NO WARRANTY OR REPRESENTATION, EXPRESS OR IMPLIED, IS MADE AS TO THE CONDITION OF THE PROPERTY (OR PROPERTIES) REFERENCED HEREIN OR AS TO THE ACCURACY OR COMPLETENESS OF THE INFORMATION CONTAINED HEREIN, AND SAME IS SUBMITTED SUBJECT TO ERRORS, OMISSIONS, CHANGE OF PRICE, RENTAL OR OTHER CONDITIONS, WITHDRAWAL WITHOUT NOTICE, AND TO ANY SPECIAL LISTING CONDITIONS IMPOSED BY THE PROPERTY OWNER(S).



**CUSHMAN &
WAKEFIELD**

